

**Bromine****56I700160****0.25 - 20 mg/L Br<sub>2</sub>**

## Material

Reagents	Packaging Unit	Part Number
Bromine Total Buffer TBR1	65 mL	56L020265
Bromine Total Titrant TBR2	65 mL	56L635765

The following accessories are required.

Accessories	Packaging Unit	Part Number
Syringe, plastic, 20 mL	1 Pieces	56A006501
Titration jar with cap, plastic, 60 mL	1 Pieces	56A006701

## Application List

- Cooling Water
- Others

## Remarks

1. Colours may vary depending on sample and test conditions.

## Sampling

Select the sample volume from the table according to the expected measuring range and read off the factor to calculate the result.

Expected Range	Titrant used	Sample Size	Factor
< 5 mg/L	Bromine Total Titrant TBR2	20 mL	0.25
5-10 mg/L	Bromine Total Titrant TBR2	10 mL	0.40
10-20 mg/L	Bromine Total Titrant TBR2	5 mL	0.80



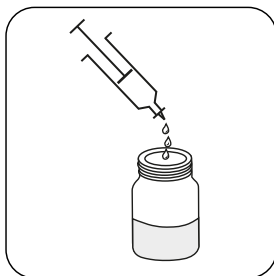

**Attention!** Select the appropriate sample volume according to the instructions in the chapter Sampling.

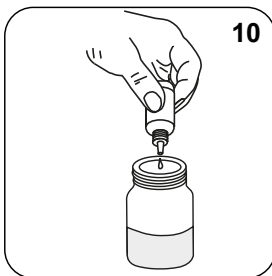

Add **10 drops Bromine Total Buffer TBR1.**

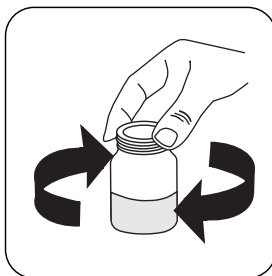

Swirl to mix.

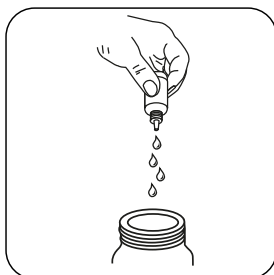

**Attention!** Record the number of drops that will be added. **x drops**

**Note:** Make sure to swirl the jar after adding each drop!

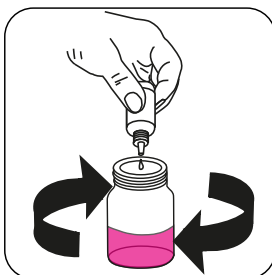

Add **Bromine Total Titrant TBR2** drop by drop to the sample until colouration turns from **colourless** to **pink**.

**Calculate test result: Bromine (as Br<sub>2</sub>) mg/L = Number of drops x factor (see table)**