

Bromine PP

M81

0.05 - 4.5 mg/L Br₂

DPD

Instrument specific information

The test can be performed on the following devices. In addition, the required cuvette and the absorption range of the photometer are indicated.

Instrument Type	Cuvette	λ	Measuring Range
MD 600, MD 610, MD 640, MultiDirect	ø 24 mm	530 nm	0.05 - 4.5 mg/L Br ₂
XD 7000, XD 7500	ø 24 mm	510 nm	0.05 - 4.5 mg/L Br ₂

Material

Required material (partly optional):

Reagents	Packaging Unit	Part Number
Chlorine Total DPD F10	Powder / 100 pc.	530120

Application List

- Disinfection Control
- Raw Water Treatment
- Pool Water Control

Preparation

1. Cleaning of vials:
As many household cleaners (e.g. dishwasher detergent) contain reducing substances, the subsequent determination of oxidising agents (e.g. ozone and chlorine) may show lower results. To avoid measurement errors, the glassware used should be free of chlorine consumption. To achieve this, all glassware should be placed in a sodium hypochlorite solution (0.1 g/L) for one hour and then rinsed thoroughly with deionised water.
2. When preparing the sample, Bromine outgassing, e.g. through the pipette or shaking, must be avoided. The analysis must take place immediately after taking the sample.
3. Strong alkaline or acidic water samples must be adjusted between pH 6 and pH 7 before the analysis (use 0.5 mol/l Sulphuric acid or 1 mol/l Sodium hydroxide).





Determination of Bromine with Powder Pack

Select the method on the device.

For this method, a ZERO measurement does not have to be carried out every time on the following devices: XD 7000, XD 7500



Fill 24 mm vial with **10 mL sample**.



Close vial(s).



Place **sample vial** in the sample chamber. Pay attention to the positioning.

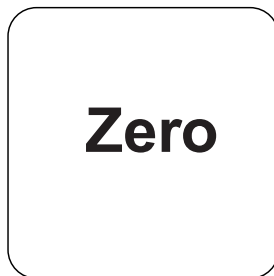

Press the **ZERO** button.

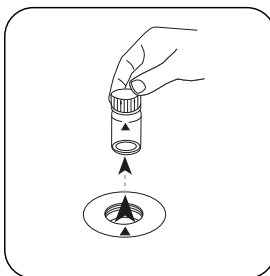

Remove the vial from the sample chamber.

For devices that require **no ZERO measurement**, start here.

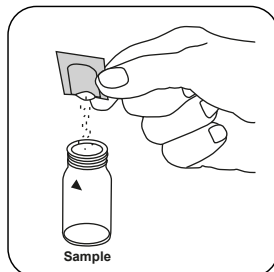

Add **Chlorine TOTAL DPD/ F10 powder pack**.

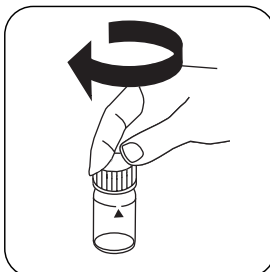

Close vial(s).

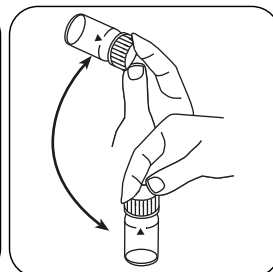

Invert several times to mix the contents (20 sec.).

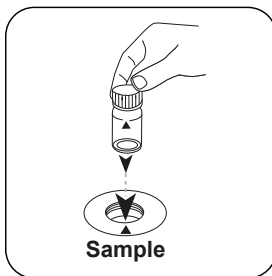

Place **sample vial** in the sample chamber. Pay attention to the positioning.

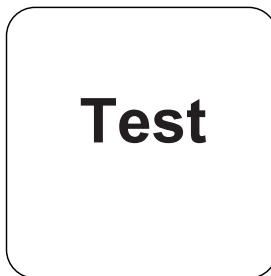

Press the **TEST** (XD: **START**) button.

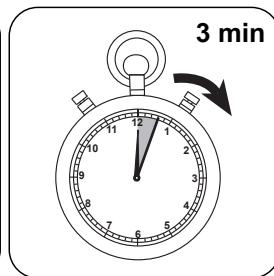

Wait for **3 minute(s) reaction time**.

Once the reaction period is finished, the measurement takes place automatically.

The result in mg/L Bromine appears on the display.



Chemical Method

DPD

Appendix

Calibration function for 3rd-party photometers

Conc. = $a + b \cdot \text{Abs} + c \cdot \text{Abs}^2 + d \cdot \text{Abs}^3 + e \cdot \text{Abs}^4 + f \cdot \text{Abs}^5$

	∅ 24 mm	□ 10 mm
a	$-4.54564 \cdot 10^{-2}$	$-4.54564 \cdot 10^{-2}$
b	$3.79613 \cdot 10^{+0}$	$8.16168 \cdot 10^{+0}$
c	$4.48111 \cdot 10^{-1}$	$2.07139 \cdot 10^{+0}$
d	$-1.33013 \cdot 10^{-1}$	$-1.32193 \cdot 10^{+0}$
e		
f		

Interferences

Persistent Interferences

1. All oxidising agents in the samples react like bromine, which leads to higher results.
2. Concentrations above 22 mg/L Bromine can lead to results within the measuring range of up to 0 mg/L. In this case, the water sample must be diluted. 10 ml of the diluted sample should be mixed with the reagent and the measurement taken again (plausibility test).

Derived from

US EPA 330.5 (1983)

APHA Method 4500 Cl-G