

Lovibond® Water Testing

Tintometer® Group



Manual of Methods

MD 100 • MD 110 • MD 200

Ozone

(EN) Manual of Methods

Page 4

(ES) Manual de Métodos

Página 28

(IT) Manuale dei Metodi

Pagina 52

(NL) Handboek Methoden

Zijde 76

(DE) Methodenhandbuch

Seite 16

(FR) Méthodes Manuel

Page 40

(PT) Métodos Manual

Página 64

(ZH) 方法手册

Page 88

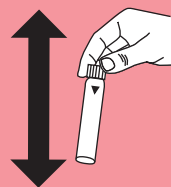
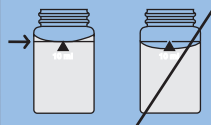
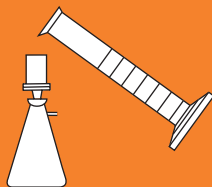

KS4.3 T / 20

Method name

Method number

Bar code for the detection of the methods

Measuring range

20

S:4.3

Display in the MD 100 / MD 110 / MD 200

Chemical Method

Instrument specific information

The test can be performed on the following devices. In addition, the required cuvette and the absorption range of the photometer are indicated.

Instrument Type	Cuvette	λ	Measuring Range
MD 200, MD 600, MD 610, MD 640, MultiDirect, PM 620, PM 630	ø 24 mm	610 nm	0.1 - 4 mmol/l $K_{S4.3}$
SpectroDirect, XD 7000, XD 7500	ø 24 mm	615 nm	0.1 - 4 mmol/l $K_{S4.3}$

Material

Required material (partly optional):

Reagents	Packaging Unit	Part Number
Alka-M-Photometer	Tablet / 100	513210BT
Alka-M-Photometer	Tablet / 250	513211BT

Application List

- Waste Water Treatment
- Drinking Water Treatment
- Raw Water Treatment

Notes

1. The terms Alkalinity-m, m-Value, total alkalinity and Acid demand to $K_{S4.3}$ are identical.
2. For accurate results, exactly 10 ml of water sample must be used for the test.

Language codes ISO 639-1

Revision status

EN Handbook of Methods 01/20

Performing test procedure

Implementation of the provision Acid capacity $K_{S_{4.3}}$ with Tablet

Select the method on the device

For this method, no ZERO measurements are to be carried out with the following devices: XD 7000, XD 7500

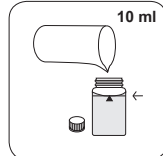

Fill 24 mm vial with **10 ml sample**.



Close vial(s).

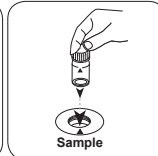

Place **sample vial** in the sample chamber. • Pay attention to the positioning.

• • •

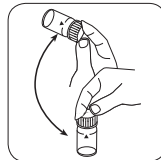

Dissolve tablet(s) by inverting.

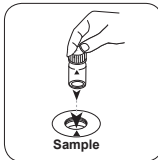

Place **sample vial** in the sample chamber. • Pay attention to the positioning.



Press the **TEST (XD: START)** button.

The result in Acid Capacity $K_{S_{4.3}}$ appears on the display.



Ozone T

M300

0.02 - 2 mg/L O₃O₃

DPD / Glycine

Material

EN

Required material (partly optional):

Reagents	Packaging Unit	Part Number
DPD No.1	Tablet / 100	511050BT
DPD No. 1	Tablet / 250	511051BT
DPD No. 1	Tablet / 500	511052BT
DPD No. 3	Tablet / 100	511080BT
DPD No. 3	Tablet / 250	511081BT
DPD No. 3	Tablet / 500	511082BT
DPD No. 1 High Calcium ^{e)}	Tablet / 100	515740BT
DPD No. 1 High Calcium ^{e)}	Tablet / 250	515741BT
DPD No. 1 High Calcium ^{e)}	Tablet / 500	515742BT
DPD No. 3 High Calcium ^{e)}	Tablet / 100	515730BT
DPD No. 3 High Calcium ^{e)}	Tablet / 250	515731BT
DPD No. 3 High Calcium ^{e)}	Tablet / 500	515732BT
Glycine ^{f)}	Tablet / 100	512170BT
Glycine ^{f)}	Tablet / 250	512171BT
Set DPD No. 1/No. 3 100 Pc. #	100 each	517711BT
Set DPD No. 1/No. 3 250 Pc. #	250 each	517712BT
Set DPD No. 1/No. 3 High Calcium 100 Pc. #	100 each	517781BT
Set DPD No. 1/No. 3 High Calcium 250 Pc. #	250 each	517782BT
Set DPD No. 1/Glycine 100 Stck. #	100 each	517731BT
Set DPD No. 1/Glycine 250 Stck. #	250 each	517732BT



Preparation

1. Cleaning of vials:
As many household cleaners (e.g. dishwasher detergent) contain reducing substances, the subsequent determination of oxidising agents (e.g. ozone and chlorine) may show lower results. To avoid measurement errors, the glassware used should be free of chlorine consumption. To achieve this, all glassware should be placed in a sodium hypochlorite solution (0.1 g/L) for one hour and then rinsed thoroughly with deionised water.
2. When preparing the sample, Ozone outgassing, e.g. through the pipette or shaking, must be avoided. The analysis must take place immediately after taking the sample.
3. Strong alkaline or acidic water samples must be adjusted between pH 6 and pH 7 before the analysis (use 0.5 mol/l Sulphuric acid or 1 mol/l Sodium hydroxide).



Determination of Ozone, in presence of Chlorine with tablet

Select the method on the device.

In addition, choose the test: in presence of Chlorine



Fill 24 mm vial with **10 mL sample**.

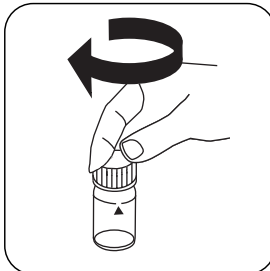

Close vial(s).

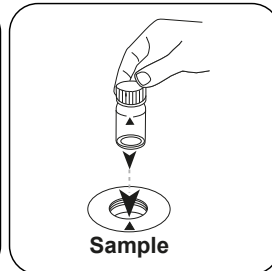

Place **sample vial** in the sample chamber. Pay attention to the positioning.

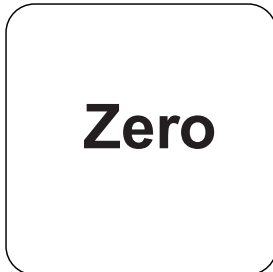

Press the **ZERO** button.

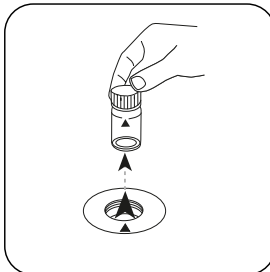

Remove the vial from the sample chamber.

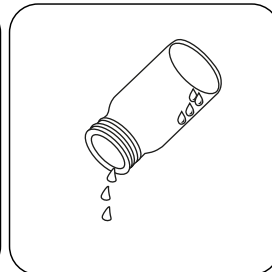

Empty vial except for a few drops.

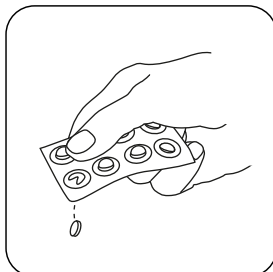

Add **DPD No. 1** tablet .

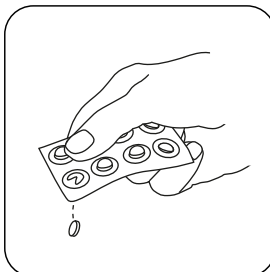

Add **DPD No. 3** tablet .

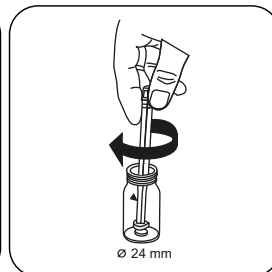

Crush tablet(s) by rotating slightly.



Fill up vial with **sample** to the **10 mL mark**.

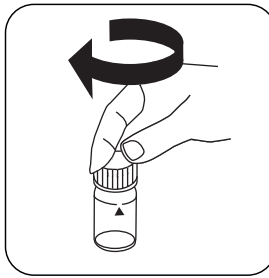

Close vial(s).

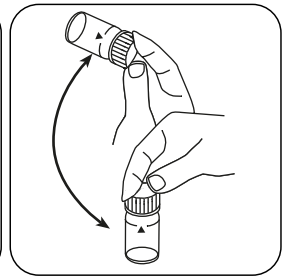

Dissolve tablet(s) by inverting.

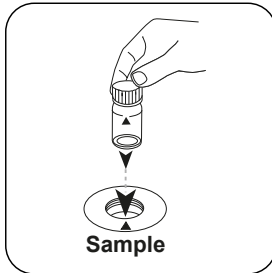

Place **sample vial** in the sample chamber. Pay attention to the positioning.

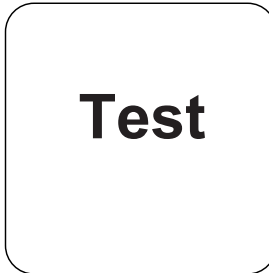

Press the **TEST** (XD: **START**) button.

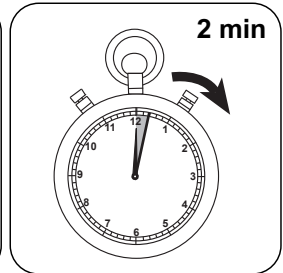

Wait for **2 minute(s)** reaction time.

Once the reaction period is finished, the measurement takes place automatically.

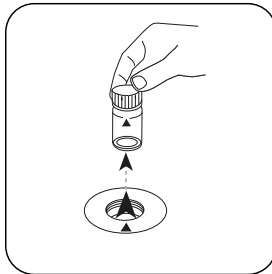

Remove the vial from the sample chamber.

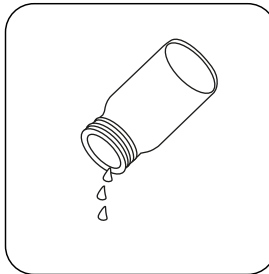

Empty vial.

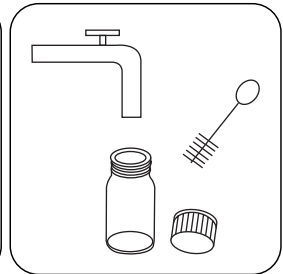

Thoroughly clean the vial and vial cap.

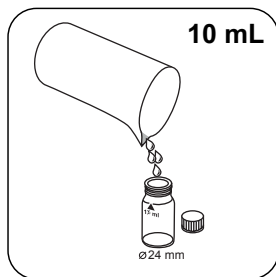

Fill a **second vial** with **10 mL sample**.

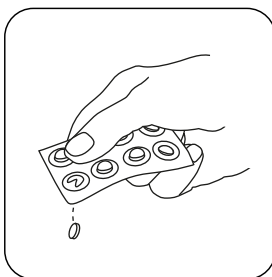

Add **GLYCINE tablet**.

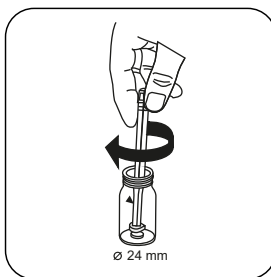

Crush tablet(s) by rotating slightly.

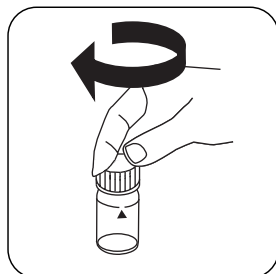

Close vial(s).

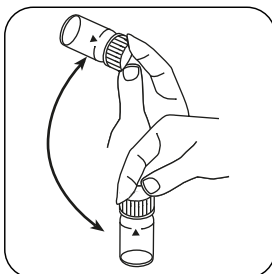

Dissolve tablet(s) by inverting.

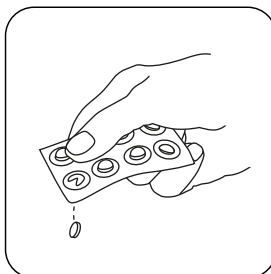

Add **one DPD No. 1 tablet** and **one DPD No. 3 tablet** straight from the foil into the first cleaned cuvette

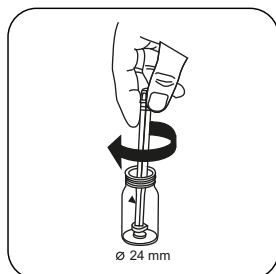

Crush tablet(s) by rotating slightly.

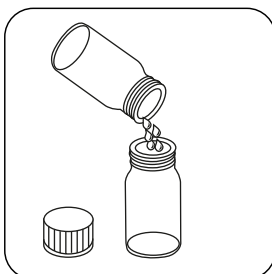

Fill prepared vial with prepared **glycine solution**.

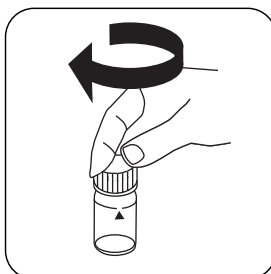

Close vial(s).

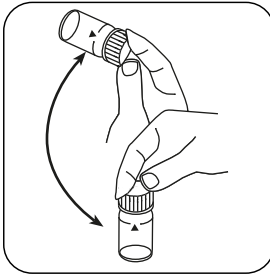

Dissolve tablet(s) by inverting.

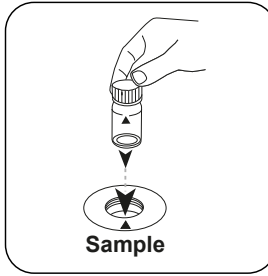

Place **sample vial** in the sample chamber. Pay attention to the positioning.

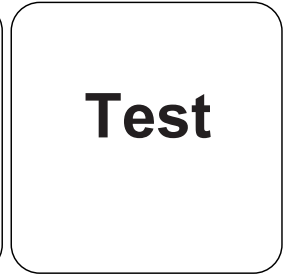

Press the **TEST** (XD: **START**) button.

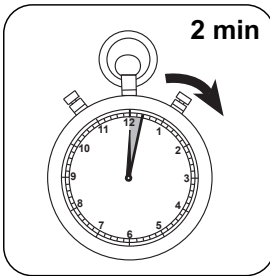

Wait for **2 minute(s) reaction time**.

Once the reaction period is finished, the measurement takes place automatically.

The result in mg/L Ozone; mg/l total chlorine appears on the display.

Determination of Ozone, in absence of chlorine with tablet

Select the method on the device.

In addition, choose the test: without Chlorine



Fill 24 mm vial with **10 mL sample**.

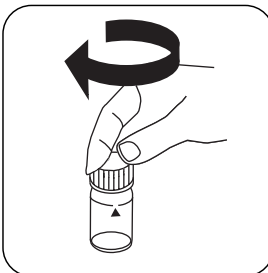

Close vial(s).

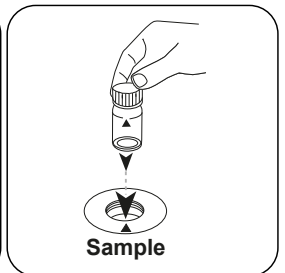

Place **sample vial** in the sample chamber. Pay attention to the positioning.



Zero

Press the **ZERO** button.

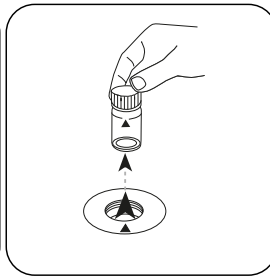

Remove the vial from the sample chamber.

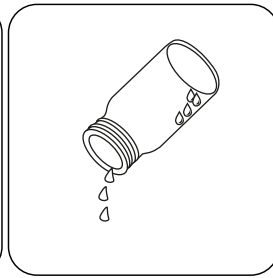

Empty vial except for a few drops.

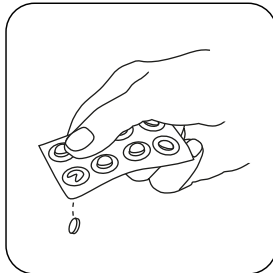

Add **DPD No. 1** tablet .

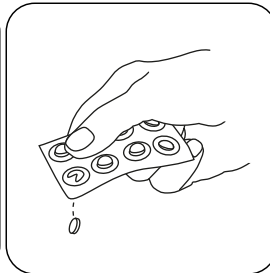

Add **DPD No. 3** tablet .

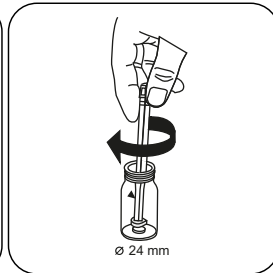

Crush tablet(s) by rotating slightly.



Fill up vial with **sample** to the **10 mL** mark.

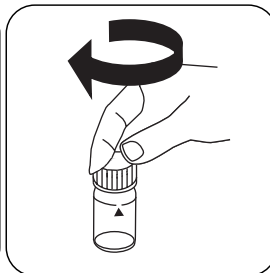

Close vial(s).

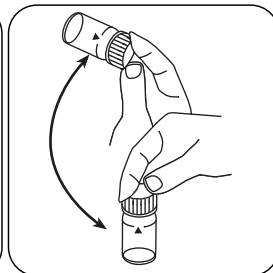

Dissolve tablet(s) by inverting.

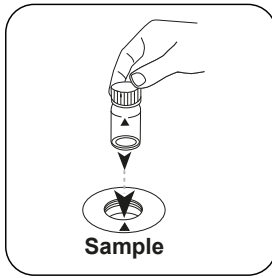

Place **sample vial** in the sample chamber. Pay attention to the positioning.

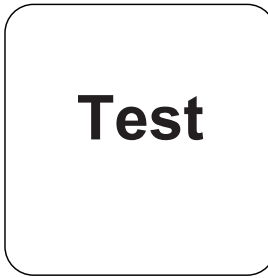

Press the **TEST** (XD: **START**) button.

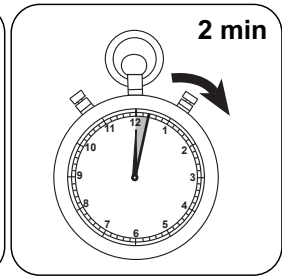

Wait for **2 minute(s)** reaction time.

Once the reaction period is finished, the measurement takes place automatically.

The result in mg/L Ozone appears on the display.



Analyses

The following table identifies the output values can be converted into other citation forms.

Unit	Cite form	Scale Factor
mg/l	O ₃	1
mg/l	Cl ₂	1.4771

EN

Chemical Method

DPD / Glycine

Appendix

Interferences

Persistent Interferences

1. All oxidising agents in the samples react like chlorine, which leads to higher results.
2. Concentrations above 6 mg/L Ozone can lead to results within the measuring range of up to 0 mg/L. In this case, the water sample must be diluted. 10 ml of the diluted sample should be mixed with the reagent and the measurement taken again (plausibility test).

Bibliography

Colorimetric Chemical Analytical Methods, 9th Edition, Lovibond

Derived from

DIN 38408-3:2011-04

^{a)} alternative reagent, used instead of DPD No.1/No.3 in case of turbidity in the water sample caused by high concentration of calcium and/or high conductivity | ^{b)} additionally required for determination of bromine, chlorine dioxide and ozone in the presence of chlorine | * including stirring rod, 10 cm

KS4.3 T / 20

Methoden Name

Methodennummer

Barcode zur Methodenerkennung

Messbereich

20

S:4.3

Chemische Methode

Säure / Indikator

Displayanzeige im MD 100 MD 110 / MD 200

Instrumentenspezifische Informationen

Der Test kann auf den folgenden Geräten durchgeführt werden. Zusätzlich sind die benötigte Küvette und der Absorptionsbereich der Photometer angegeben.

Geräte	Küvette	λ	Messbereich
MD 200, MD 600, MD 610, MD 640, MultiDirect, PM 620, PM 630	ø 24 mm	610 nm	0,1 - 4 mmol/l $K_{S4.3}$
SpectroDirect, XD 7000, XD 7500	ø 24 mm	615 nm	0,1 - 4 mmol/l $K_{S4.3}$

Material

Benötigtes Material (zum Teil optional):

Reagenzien	Form/Menge	Bestell-Nr.
Alka-M-Photometer	Tablette / 100	513210BT
Alka-M-Photometer	Tablette / 250	513211BT

Anwendungsbereich

- Abwasserbehandlung
- Trinkwasseraufbereitung
- Rohwasserbehandlung

Anmerkungen

1. Die Begriffe Alkalität-m, m-Wert, Gesamtalkalität und Säurekapazität $K_{S4.3}$ sind identisch.
2. Die exakte Einhaltung des Probevolumens von 10 ml ist für die Genauigkeit des Analyseergebnisses entscheidend.

Sprachkürzel nach ISO 639-1

Revisionsstand

DE Methodenhandbuch 01/20

Durchführung der
Messung**Durchführung der Bestimmung Säurekapazität $K_{s4,3}$ mit Tablette**

Die Methode im Gerät auswählen.

Für diese Methode muss bei folgenden Geräten keine ZERO-Messung durchgeführt werden: XD 7000, XD 7500

24-mm-Küvette mit **10 ml Probe** füllen.

Küvette(n) verschließen.

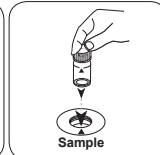
Die **Probeküvette** in den Messschacht stellen. Positionierung beachten.

• • •

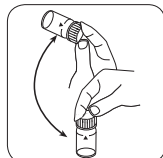

Tablette(n) durch Umschwenken lösen.

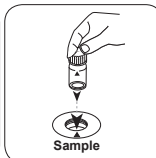
Die **Probeküvette** in den Messschacht stellen. Positionierung beachten.Taste **TEST** (XD: **START**) drücken.In der Anzeige erscheint das Ergebnis als Säurekapazität $K_{s4,3}$.



Ozon T

M300

0,02 - 2 mg/L O₃O₃

DPD / Glycin

Material

DE

Benötigtes Material (zum Teil optional):

Reagenzien	Form/Menge	Bestell-Nr.
DPD No.1	Tablette / 100	511050BT
DPD No. 1	Tablette / 250	511051BT
DPD No. 1	Tablette / 500	511052BT
DPD No. 3	Tablette / 100	511080BT
DPD No. 3	Tablette / 250	511081BT
DPD No. 3	Tablette / 500	511082BT
DPD No. 1 High Calcium ^{e)}	Tablette / 100	515740BT
DPD No. 1 High Calcium ^{e)}	Tablette / 250	515741BT
DPD No. 1 High Calcium ^{e)}	Tablette / 500	515742BT
DPD No. 3 High Calcium ^{e)}	Tablette / 100	515730BT
DPD No. 3 High Calcium ^{e)}	Tablette / 250	515731BT
DPD No. 3 High Calcium ^{e)}	Tablette / 500	515732BT
Glycine ^{f)}	Tablette / 100	512170BT
Glycine ^{f)}	Tablette / 250	512171BT
Set DPD No. 1/No. 3 [#]	je 100	517711BT
Set DPD No. 1/No. 3 [#]	je 250	517712BT
Set DPD No. 1/No. 3 High Calcium [#]	je 100	517781BT
Set DPD No. 1/No. 3 High Calcium [#]	je 250	517782BT
Set DPD No. 1/Glycine [#]	je 100	517731BT
Set DPD No. 1/Glycine [#]	je 250	517732BT

Vorbereitung

1. Reinigung der Küvetten:
Da viele Haushaltsreiniger (z.B. Geschirrspülmittel) reduzierende Stoffe enthalten, kann es bei der nachfolgenden Bestimmung von Oxidationsmitteln (z.B. Ozon, Chlor) zu Minderbefunden kommen. Um diesen Messfehler auszuschließen, sollten die Glasgeräte chlorzehrungsfrei sein. Dazu werden die Glasgeräte für eine Stunde unter Natriumhypochloritlösung (0,1 g/L) aufbewahrt und danach gründlich mit VE-Wasser gespült.
2. Bei der Probenvorbereitung muss das Ausgasen von Ozon, z.B. durch Pipettieren und Schütteln vermieden werden. Die Analyse muss unmittelbar nach der Probennahme erfolgen.
3. Stark alkalische oder saure Wässer müssen vor der Analyse in einen pH-Bereich zwischen 6 und 7 gebracht werden (mit 0,5 mol/l Schwefelsäure bzw. 1 mol/l Natronlauge).

DE



Durchführung der Bestimmung Ozon, neben Chlor mit Tablette

Die Methode im Gerät auswählen.

Wählen Sie zudem die Bestimmung: neben Chlor



24-mm-Küvette mit **10 mL Probe** füllen.

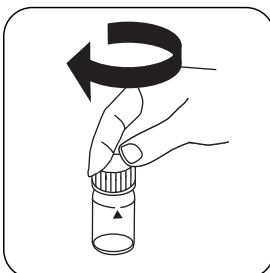

Küvette(n) verschließen.

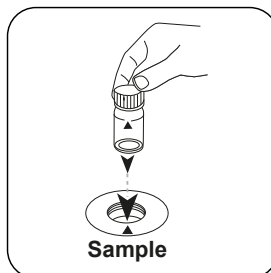

Die **Probeküvette** in den Messschacht stellen. Positionierung beachten.

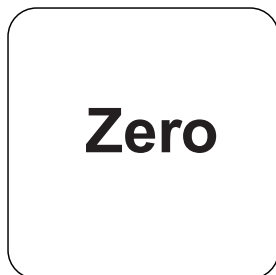

Taste **ZERO** drücken.

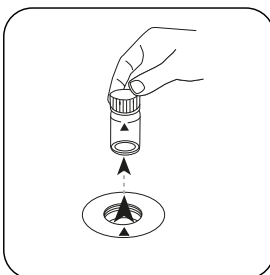

Küvette aus dem Messschacht nehmen.

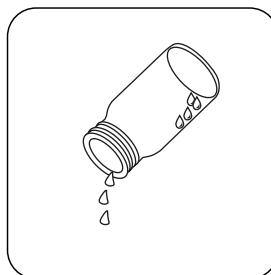

Die Küvette bis auf einige Tropfen entleeren.

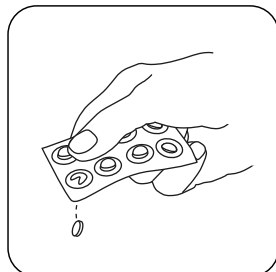

Eine **DPD No. 1 Tablette** zugeben.

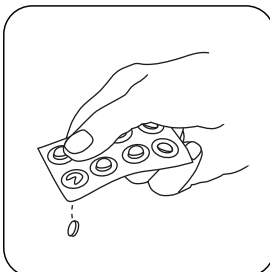

Eine **DPD No. 3 Tablette** zugeben.

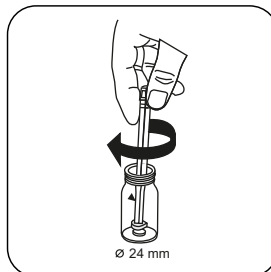

Tablette(n) unter leichter Drehung zerdrücken.



Küvette bis zur **10-mL-Marke** mit der **Probe** auffüllen.

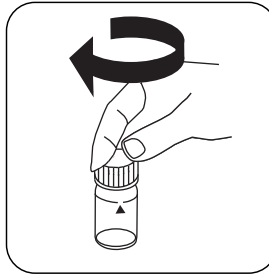

Küvette(n) verschließen.

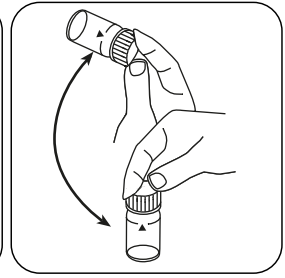

Tablette(n) durch Umschwenken lösen.

DE

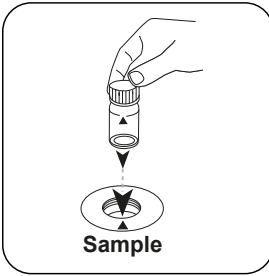

Die **Probeküvette** in den Messschacht stellen. Positionierung beachten.

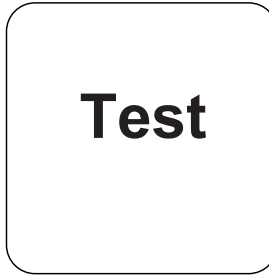

Taste **TEST (XD: START)** drücken.

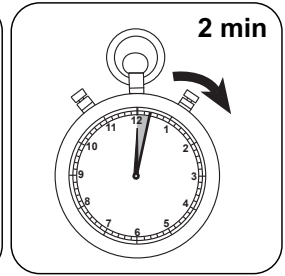

2 Minute(n) Reaktionszeit abwarten.

Nach Ablauf der Reaktionszeit erfolgt automatisch die Messung.

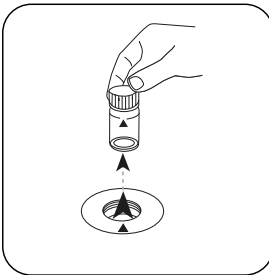

Küvette aus dem Messschacht nehmen.

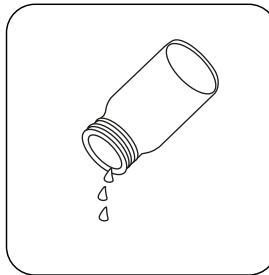

Küvette entleeren.

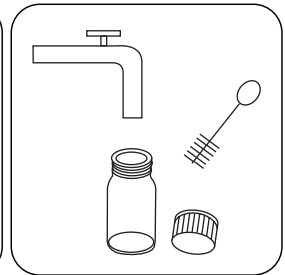

Die Küvette und den Küvettedeckel gründlich reinigen.

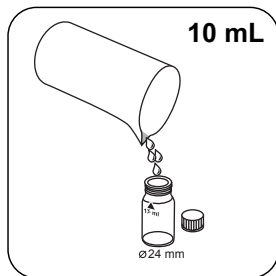

Eine **zweite Küvette** mit **10 mL Probe** füllen.

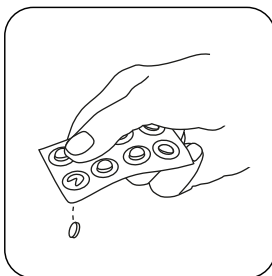

Eine **GLYCINE Tablette** zugeben.

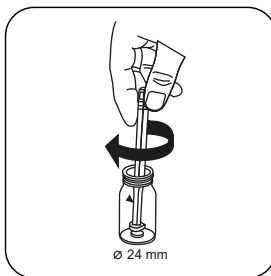

Tablette(n) unter leichter Drehung zerdrücken.

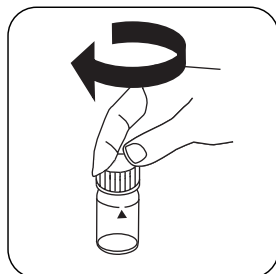

Küvette(n) verschließen.

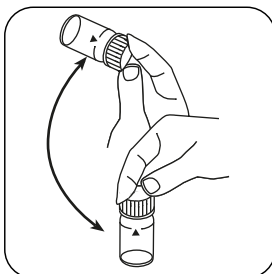

Tablette(n) durch Umschwenken lösen.

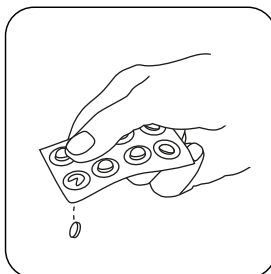

Eine **DPD No. 1 Tablette** und eine **DPD No. 3 Tablette** direkt aus der Folie in die erste Küvette geben.

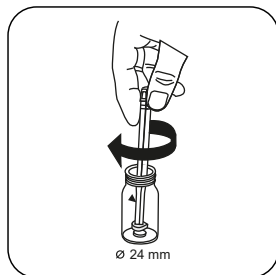

Tablette(n) unter leichter Drehung zerdrücken.

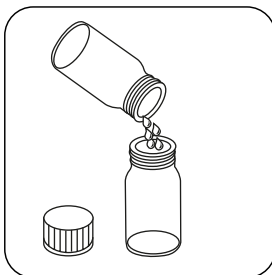

Die vorbereitete **Glycinlösung** in die vorbereitete Küvette füllen.

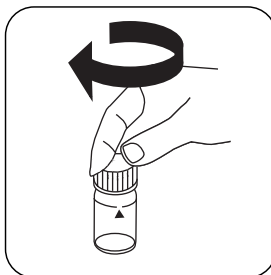

Küvette(n) verschließen.

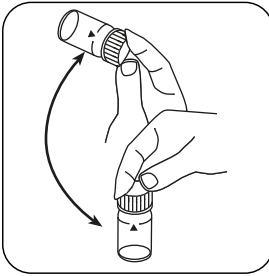

Tablette(n) durch Umschwenken lösen.

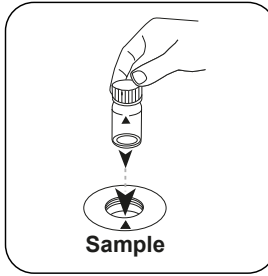

Die **Probeküvette** in den Messschacht stellen. Positionierung beachten.

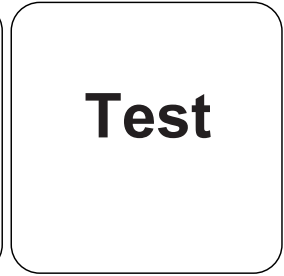

Taste **TEST (XD: START)** drücken.

DE

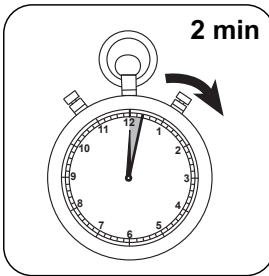

2 Minute(n) Reaktionszeit abwarten.

Nach Ablauf der Reaktionszeit erfolgt automatisch die Messung.

In der Anzeige erscheint das Ergebnis in mg/L Ozon; mg/l Gesamtchlor.

Durchführung der Bestimmung Ozon, in Abwesenheit von Chlor mit Tablette

Die Methode im Gerät auswählen.

Wählen Sie zudem die Bestimmung: ohne Chlor



24-mm-Küvette mit **10 mL Probe** füllen.

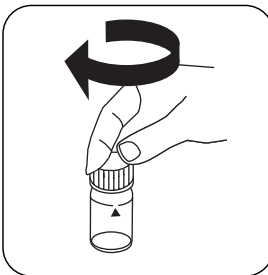

Küvette(n) verschließen.

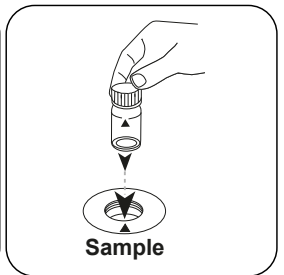

Die **Probeküvette** in den Messschacht stellen. Positionierung beachten.



Zero

DE

Taste **ZERO** drücken.

Küvette aus dem Messschacht nehmen.

Die Küvette bis auf einige Tropfen entleeren.

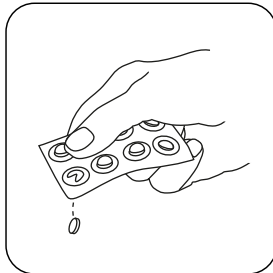

Eine **DPD No. 1** Tablette zugeben.

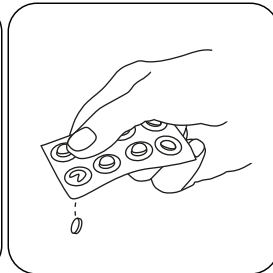

Eine **DPD No. 3** Tablette zugeben.

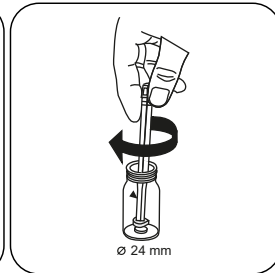

Tablette(n) unter leichter Drehung zerdrücken.



Küvette bis zur **10-mL-Marke** mit der **Probe** auffüllen.

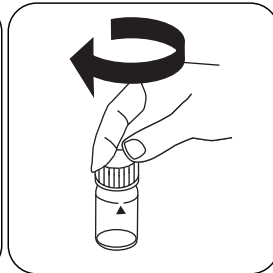

Küvette(n) verschließen.

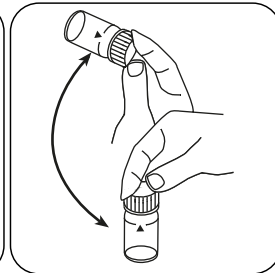

Tablette(n) durch Umschwenken lösen.

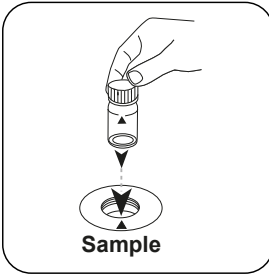

Die **Probenküvette** in den Messschacht stellen. Positionierung beachten.

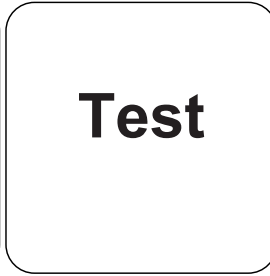

Taste **TEST** (XD: **START**) drücken.

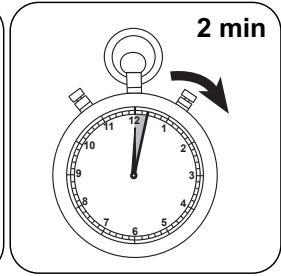

2 Minute(n) Reaktionszeit abwarten.

Nach Ablauf der Reaktionszeit erfolgt automatisch die Messung.

In der Anzeige erscheint das Ergebnis in mg/L Ozon.



Auswertung

Die folgende Tabelle gibt an wie die ausgegebenen Werte in andere Zitierformen umgewandelt werden können.

Einheit	Zitierform	Umrechnungsfaktor
mg/l	O ₃	1
mg/l	Cl ₂	1.4771

DE

Chemische Methode

DPD / Glycin

Appendix

Störungen

Permanente Störungen

1. Alle in den Proben vorhandenen Oxidationsmittel reagieren wie Chlor, was zu Mehrbefunden führt.
2. Konzentrationen über 6 mg/L Ozon können zu Ergebnissen innerhalb des Messbereiches bis hin zu 0 mg/L führen. In diesem Fall ist die Wasserprobe zu verdünnen. 10 ml der verdünnten Probe werden mit Reagenz versetzt und die Messung wiederholt (Plausibilitätstest).

Literaturverweise

Colorimetric Chemical Analytical Methods, 9th Edition, Lovibond

Abgeleitet von

DIN 38408-3:2011-04

^{a)} Hilfsreagenz, alternativ zur DPD No. 1 / No. 3 bei Eintrübungen der Probe durch hohen Calciumionengehalt und/ oder hohe Leitfähigkeit | ^{b)} Hilfsreagenz, wird zusätzlich für die Bestimmung Brom, Chlordioxid bzw. Ozon benötigt bei Anwesenheit von Chlor | ^{*} inklusive Rührstab

KS4.3 T / 20

Nombre del método

Número de método

Código de barras para reconocer el método

Rango de medición

20

S:4.3

Indicación en la pantalla de MD 100 / MD 110 / MD 200

Método químico

Información específica del instrumento

La prueba puede realizarse en los siguientes dispositivos. Además, se muestran la cubeta requerida y el rango de absorción del fotómetro.

Dispositivos	Cubeta	λ	Rango de medición
MD 200, MD 600, MD 610, MD 640, MultiDirect, PM 620, PM 630	\varnothing 24 mm	610 nm	0.1 - 4 mmol/l $K_{S4.3}$
SpectroDirect, XD 7000, XD 7500	\varnothing 24 mm	615 nm	0.1 - 4 mmol/l $K_{S4.3}$

Material

Material requerido (parcialmente opcional):

Título	Unidad de embalaje	Referencia No
Fotómetro alca-M	Tabletas / 100	513210BT
Fotómetro alca-M	Tabletas / 250	513211BT

Lista de aplicaciones

- Tratamiento de aguas residuales
- Tratamiento de aguas potables
- Tratamiento de aguas de aporte

Notas

1. Las definiciones de alcalinidad-m, valor-m y capacidad ácida $K_{S4.3}$ son idénticas.
2. Añadir un volumen de muestra de exactamente 10 ml, ya que este volumen influye de forma decisiva en la exactitud del resultado.

Códigos de idioma ISO 639-1

Estado de revisión

ES Manual de Métodos 01/20

ES

Realización de la determinación

Ejecución de la determinación Capacidad ácida $K_{s4.3}$ con tableta

Seleccionar el método en el aparato.

Para este método no es necesario realizar medición CERO en los aparatos siguientes: XD 7000, XD 7500



Llenar la cubeta de 24 mm con 10 ml de muestra .



Cerrar la(s) cubeta(s).

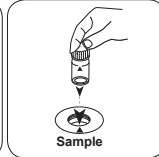

Poner la **cubeta de muestra** en el compartimiento de medición. ¡Debe tenerse en cuenta el posicionamiento!

• • •

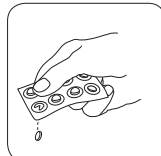

Añadir **tableta ALKA-M-PHOTOMETER**.

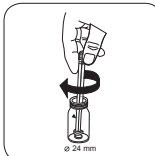

Triturar la(s) tableta(s) girando ligeramente.

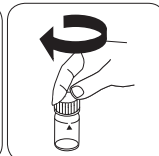

Cerrar la(s) cubeta(s).



Ozono T

M300

0.02 - 2 mg/L O₃O₃

DPD / Glicina

Material

ES

Material requerido (parcialmente opcional):

Reactivos	Unidad de embalaje	No. de referencia
DPD n°1	Tabletas / 100	511050BT
DPD n° 1	Tabletas / 250	511051BT
DPD n° 1	Tabletas / 500	511052BT
DPD n° 3	Tabletas / 100	511080BT
DPD n° 3	Tabletas / 250	511081BT
DPD n° 3	Tabletas / 500	511082BT
DPD n° 1 High Calcium ^{e)}	Tabletas / 100	515740BT
DPD n° 1 High Calcium ^{e)}	Tabletas / 250	515741BT
DPD n° 1 High Calcium ^{e)}	Tabletas / 500	515742BT
DPD n° 3 High Calcium ^{e)}	Tabletas / 100	515730BT
DPD n° 3 High Calcium ^{e)}	Tabletas / 250	515731BT
DPD n° 3 High Calcium ^{e)}	Tabletas / 500	515732BT
Glicina ^{f)}	Tabletas / 100	512170BT
Glicina ^{f)}	Tabletas / 250	512171BT
Juego DPD n° 1/n° 3 [#]	100 cada	517711BT
Juego DPD n° 1/n° 3 [#]	250 cada	517712BT
Juego DPD n° 1/n° 3 High Calcium [#]	100 cada	517781BT
Juego DPD n° 1/n° 3 High Calcium [#]	250 cada	517782BT
Juego DPD n° 1/glicina [#]	100 cada	517731BT
Juego DPD n° 1/glicina [#]	250 cada	517732BT

Preparación

1. Limpieza de las cubetas:
Muchos productos de limpieza (p. ej., detergentes de lavavajillas) poseen componentes reductores, que pueden reducir los resultados en la determinación siguiente de oxidantes (p. ej., ozono, cloro). Para evitar estas alteraciones, los aparatos de vidrio deben estar exentos de componentes corrosivos al cloro. Para ello, deberá sumergir los aparatos de vidrio durante una hora en una solución de hipoclorito sódico (0,1 g/L), enjuagándolos minuciosamente a continuación con agua desionizada.
2. Evitar durante la preparación de la muestra la desgasificación de ozono, p. ej., al pipetar o agitar. La determinación se ha de realizar inmediatamente después de la toma de la muestra.
3. Las muestras acuosas muy ácidas o muy básicas se deberán neutralizar a un valor de pH entre 6 y 7 antes de realizar el análisis (con 0,5 mol/l de ácido sulfúrico o 1 mol/l de hidróxido sódico).

ES



Ejecución de la determinación Ozono, con tableta en presencia de cloro

Seleccionar el método en el aparato.

Seleccione además la determinación: en presencia de Cloro



Llenar la cubeta de 24 mm con **10 mL de muestra** .

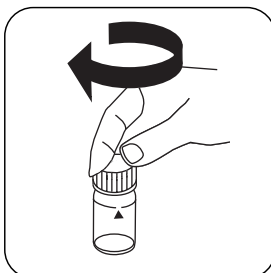

Cerrar la(s) cubeta(s).

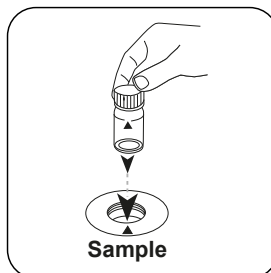

Poner la **cubeta de muestra** en el compartimiento de medición. ¡Debe tenerse en cuenta el posicionamiento!

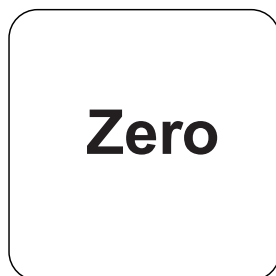

Pulsar la tecla **ZERO**.

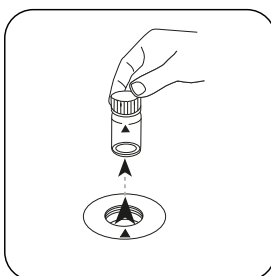

Extraer la cubeta del compartimiento de medición.

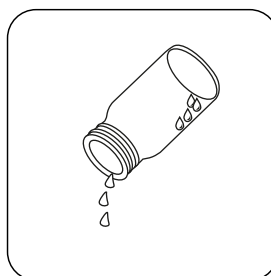

Vaciar la cubeta excepto algunas gotas.

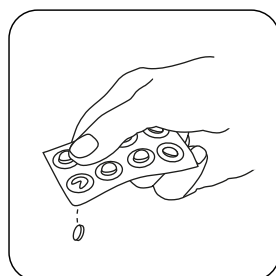

Añadir **tableta DPD No. 1**.

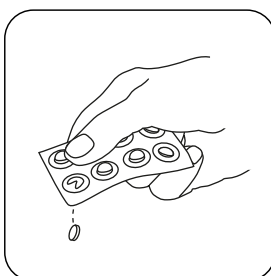

Añadir **tableta DPD No. 3**.

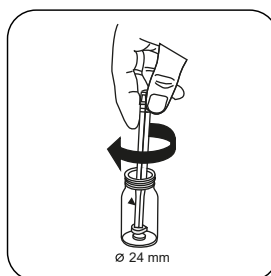

Triturar la(s) tableta(s) girando ligeramente.



Llenar la cubeta con la **muestra** hasta la **marca de 10 mL**.

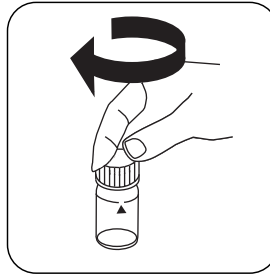

Cerrar la(s) cubeta(s).

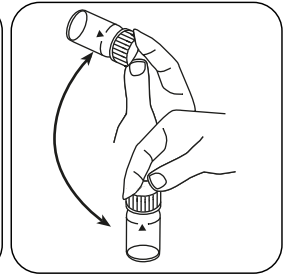

Disolver la(s) tableta(s) girando.

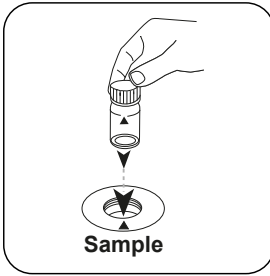

Poner la **cubeta de muestra** en el compartimiento de medición. ¡Debe tenerse en cuenta el posicionamiento!

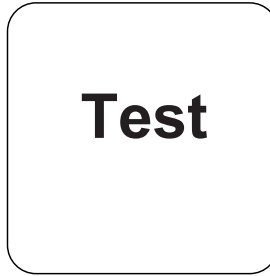

Pulsar la tecla **TEST (XD: START)**.

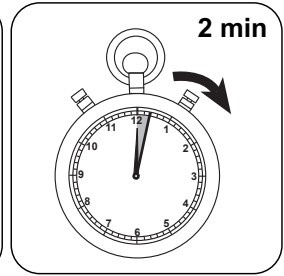

Esperar **2 minutos como periodo de reacción**.

Finalizado el periodo de reacción se realizará la determinación automáticamente.

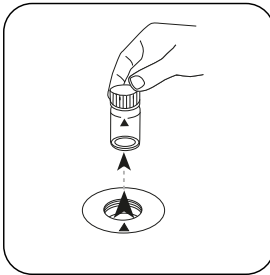

Extraer la cubeta del compartimiento de medición.



Vaciar la cubeta.

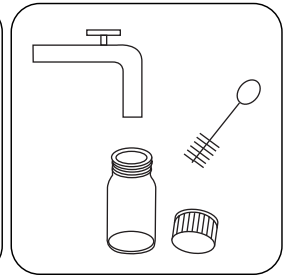

Limpiar a fondo la cubeta y la tapa.

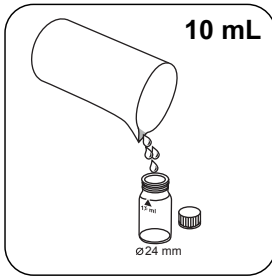

Llenar una **segunda cubeta** con **10 mL de muestra**.

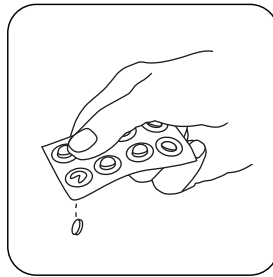

Añadir **tableta GLYCINE**.

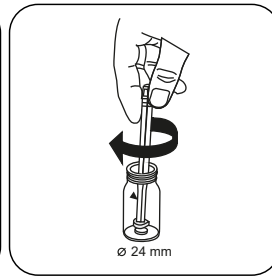

Triturar la(s) tableta(s) girando ligeramente.

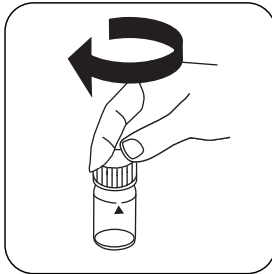

Cerrar la(s) cubeta(s).

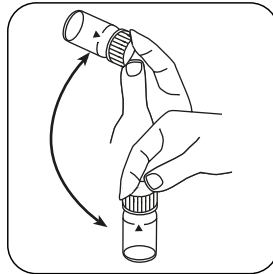

Disolver la(s) tableta(s) girando.

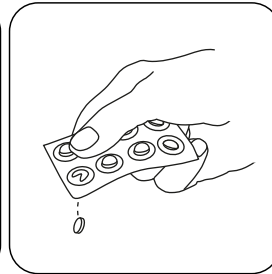

Añadir **una tableta DPD No. 1** y **una tableta DPD No. 3** directamente de su envoltura, en la primera cubeta.

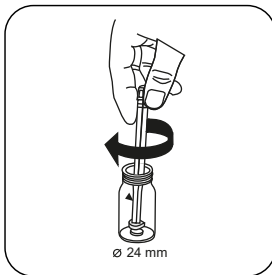

Triturar la(s) tableta(s) girando ligeramente.

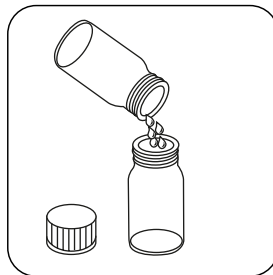

Llenar la **solución de glicina** preparada en la cubeta preparada.

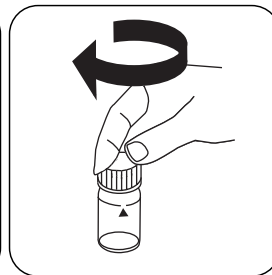

Cerrar la(s) cubeta(s).

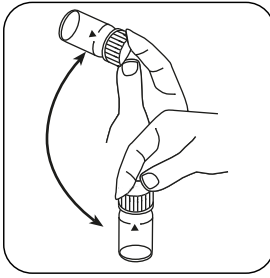

Disolver la(s) tableta(s) girando.

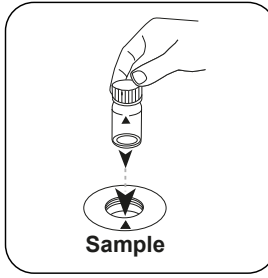

Poner la **cubeta de muestra** en el compartimiento de medición. ¡Debe tenerse en cuenta el posicionamiento!

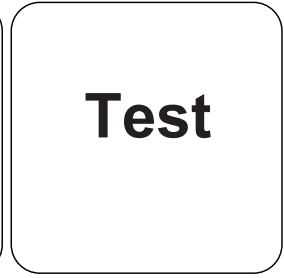

Pulsar la tecla **TEST** (XD: **START**).

ES

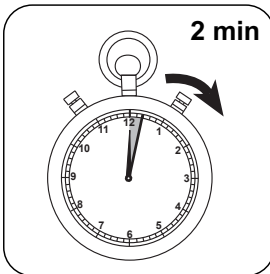

Esperar **2 minutos como periodo de reacción.**

Finalizado el periodo de reacción se realizará la determinación automáticamente.

A continuación se visualizará el resultado en mg/L Ozono; mg/l cloro total.

Ejecución de la determinación Ozono, con tableta en ausencia de cloro

Seleccionar el método en el aparato.

Seleccione además la determinación: sin cloro



Llenar la cubeta de 24 mm con **10 mL de muestra .**

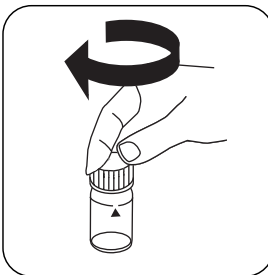

Cerrar la(s) cubeta(s).

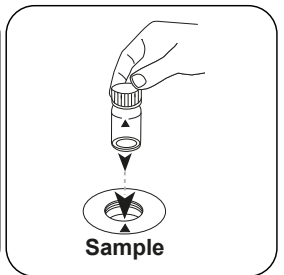

Poner la **cubeta de muestra** en el compartimiento de medición. ¡Debe tenerse en cuenta el posicionamiento!



Zero

Pulsar la tecla **ZERO**.

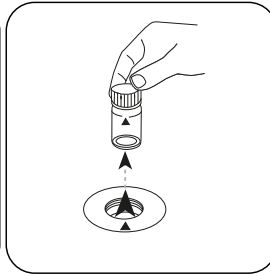

Extraer la cubeta del compartimiento de medición.

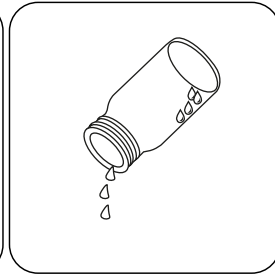

Vaciar la cubeta excepto algunas gotas.

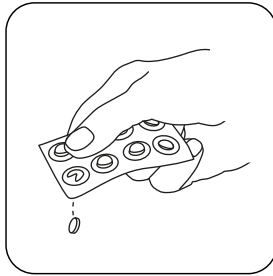

Añadir **tableta DPD No. 1**.

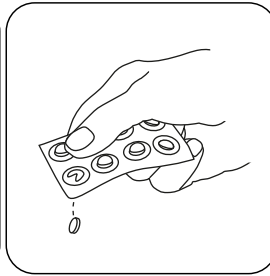

Añadir **tableta DPD No. 3**.

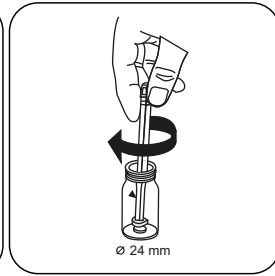

Triturar la(s) tableta(s) girando ligeramente.



Llenar la cubeta con la muestra hasta la **marca de 10 mL**.

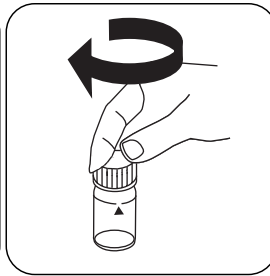

Cerrar la(s) cubeta(s).

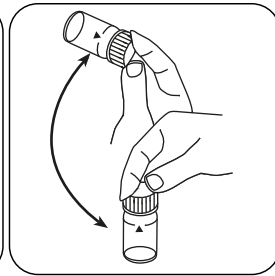

Disolver la(s) tableta(s) girando.

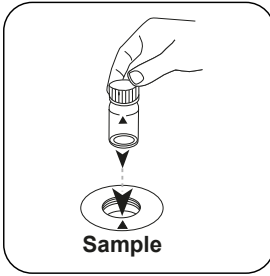

Poner la **cubeta de muestra** en el compartimiento de medición. ¡Debe tenerse en cuenta el posicionamiento!

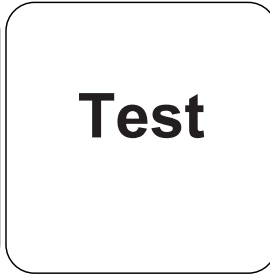

Pulsar la tecla **TEST** (XD: **START**).

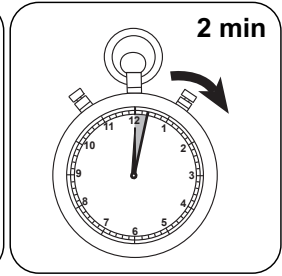

Esperar **2 minutos como periodo de reacción**.

Finalizado el periodo de reacción se realizará la determinación automáticamente.
A continuación se visualizará el resultado en mg/L Ozono.



Evaluación

La siguiente tabla muestra cómo los valores de salida se pueden convertir a otros formularios de citas.

Unidad	Conversión	Factor de conversión
mg/l	O ₃	1
mg/l	Cl ₂	1.4771

ES

Método químico

DPD / Glicina

Apéndice

Interferencia

Interferencias persistentes

1. Todos los elementos oxidantes existentes en la muestra reaccionan como el cloro, lo que produce un resultado más elevado.
2. Las concentraciones de peróxido de ozono mayores a 6 mg/L pueden conducir a resultados de dentro del campo de medición hasta 0 mg/L. En este caso, se deberá diluir la muestra acuosa. Se mezclan 10 ml de muestra diluida con reactivo y se repite la medición (prueba de plausibilidad).

Bibliografía

Colorimetric Chemical Analytical Methods, 9th Edition, Lovibond

Derivado de

DIN 38408-3:2011-04

^{a)} Reactivo auxiliar, alternativo a DPD No. 1/3 en enturbiamientos de la prueba debido a concentraciones elevadas de calcio y/o elevada conductividad | ^{b)} Reactivo auxiliar, necesario adicionalmente para la determinación de bromo, dióxido de cloro y ozono en presencia de cloro

KS4.3 T / 20



Nom de la méthode → KS4.3 T

Numéro de méthode → 20

Code à barres pour reconnaître la méthode → [Barcode]

Plage de mesure → 0.1 - 4 mmol/l $K_{S4.3}$

Méthode chimique → Acide / Indicateur

Affichage dans le MD 100 / MD 110 / MD 200 → S:4.3

Informations spécifiques à l'instrument

Le test peut être effectué sur les appareils suivants. De plus, la cuvette requise et la plage d'absorption du photomètre sont indiquées.

Appareils	Cuvette	λ	Gamme de mesure
MD 200, MD 600, MD 610, MD 640, MultiDirect, PM 620, PM 630	ø 24 mm	610 nm	0.1 - 4 mmol/l $K_{S4.3}$
SpectroDirect, XD 7000, XD 7500	ø 24 mm	615 nm	0.1 - 4 mmol/l $K_{S4.3}$

Matériel

Matériel requis (partiellement optionnel):

Titre	Pack contenant	Code
Alka-M-Photometer	Pastilles / 100	513210BT
Alka-M-Photometer	Pastilles / 250	513211BT

Liste d'applications

- Traitement des eaux usées
- Traitement de l'eau potable
- Traitement de l'eau brute

Indication

1. Les termes Alcalinité-m, Valeur m, Alcalinité totale et Capacité acide $K_{S4.3}$ sont identiques.
2. L'observation exacte du volume d'échantillon de 10 ml est décisive pour l'exactitude du résultat de l'analyse.

Codes de langue ISO 639-1 → FR

État de révision → 01/20

FR Méthodes Manuel 01/20

Procédure du test

Réalisation de la quantification Capacité acide $K_{s4.3}$ avec pastille

Sélectionnez la méthode sur l'appareil.

Cette méthode ne nécessite aucune mesure du zéro sur les appareils suivants : XD 7000, XD 7500

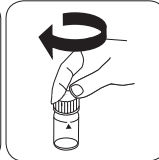
Remplissez une cuvette de 24 mm de **10 ml** d'échantillon.

Fermez la(les) cuvette(s).

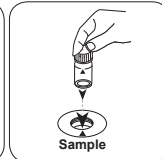
Placez la **cuvette réservée à l'échantillon** dans la chambre de mesure. Attention à la positionner correctement.

• • •

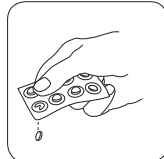
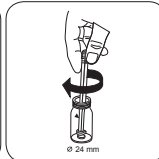
Ajoutez une **pastille de ALKA-M-PHOTOMETER**.

Écrasez la(les) pastille(s) en la(les) tournant un peu.

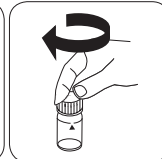

Fermez la(les) cuvette(s).



Ozone T

M300

0.02 - 2 mg/L O₃O₃

DPD / Glycine

Matériel

FR

Matériel requis (partiellement optionnel):

Réactifs	Pack contenant	Code
DPD N° 1	Pastilles / 100	511050BT
DPD N° 1	Pastilles / 250	511051BT
DPD N° 1	Pastilles / 500	511052BT
DPD N° 3	Pastilles / 100	511080BT
DPD N° 3	Pastilles / 250	511081BT
DPD N° 3	Pastilles / 500	511082BT
DPD N° 1 High Calcium ^{e)}	Pastilles / 100	515740BT
DPD N° 1 High Calcium ^{e)}	Pastilles / 250	515741BT
DPD N° 1 High Calcium ^{e)}	Pastilles / 500	515742BT
DPD N° 3 High Calcium ^{e)}	Pastilles / 100	515730BT
DPD N° 3 High Calcium ^{e)}	Pastilles / 250	515731BT
DPD N° 3 High Calcium ^{e)}	Pastilles / 500	515732BT
Glycine ^{f)}	Pastilles / 100	512170BT
Glycine ^{f)}	Pastilles / 250	512171BT
Kit DPD N° 1/N° 3 ^g	100 chacun	517711BT
Kit DPD N° 1/N° 3 ^g	250 chacun	517712BT
Kit DPD N° 1/N° 3 High Calcium ^h	100 chacun	517781BT
Kit DPD N° 1/N° 3 High Calcium ^h	250 chacun	517782BT
Kit DPD N° 1/Glycine ^g	100 chacun	517731BT
Kit DPD N° 1/Glycine ^g	250 chacun	517732BT



Préparation

1. Nettoyage des cuvettes :
Beaucoup de produits de nettoyage domestiques (par ex. liquide vaisselle) contenant des agents réducteurs, il est possible que lors de la quantification suivante des agents oxydants (par ex. ozone, chlore), les résultats soient plus bas. Pour exclure ces erreurs, les instruments en verre utilisés devraient être insensibles aux effets du chlore. Il est recommandé de laisser les instruments en verre pendant une heure dans une solution d'hypochlorite de sodium (0,1 g/L) et de bien les rincer ensuite à l'eau déminéralisée.
2. Lors de la préparation de l'échantillon, il faudra éviter le dégazage de l'ozone, par ex. par pipetage ou agitation. L'analyse devra avoir lieu immédiatement après le prélèvement de l'échantillon.
3. Avant l'analyse, les eaux fortement alcalines ou acides doivent être ajustées sur un pH compris entre 6 et 7 (avec 0,5 mol/l d'acide sulfurique ou 1 mol/l de soude caustique).

FR



Réalisation de la quantification Ozone, en présence de chlore avec pastille

Sélectionnez la méthode sur l'appareil.

Sélectionnez également la quantification : en présence de chlore

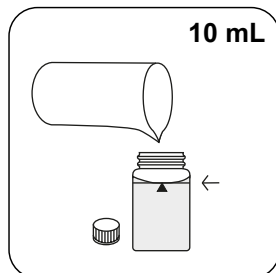

Remplissez une cuvette de 24 mm de **10 mL** d'échantillon.

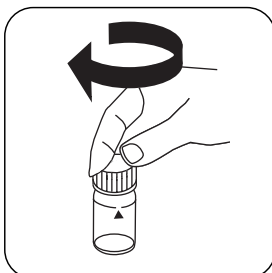

Fermez la(les) cuvette(s).

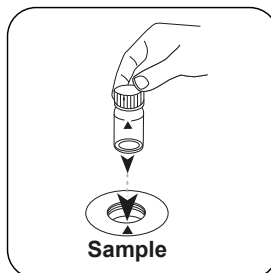

Placez la **cuvette réservée à l'échantillon** dans la chambre de mesure. Attention à la positionner correctement.

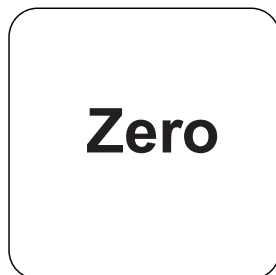

Appuyez sur la touche **ZERO**.

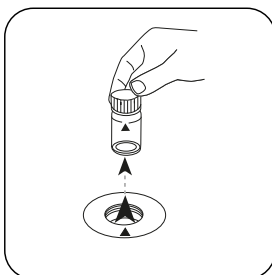

Retirez la cuvette de la chambre de mesure.

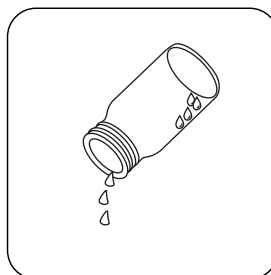

Videz pratiquement la cuvette en y laissant quelques gouttes.

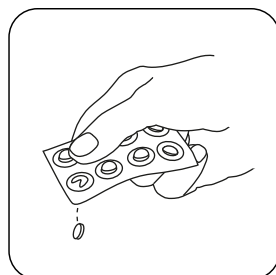

Ajoutez une **pastille de DPD No. 1**.

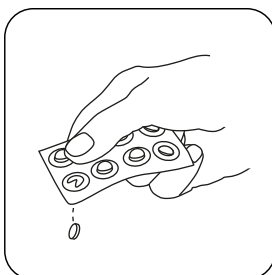

Ajoutez une **pastille de DPD No. 3**.

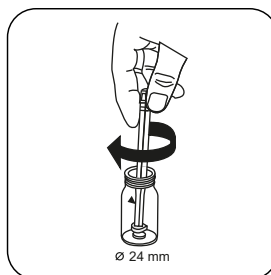

Écrasez la(les) pastille(s) en la(les) tournant un peu.



Remplissez la cuvette jusqu'au **repère de 10 mL** en y versant l'**échantillon**.

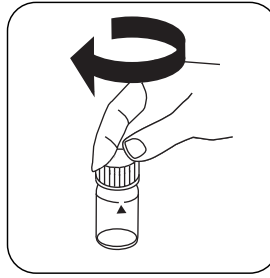

Fermez la(les) cuvette(s).

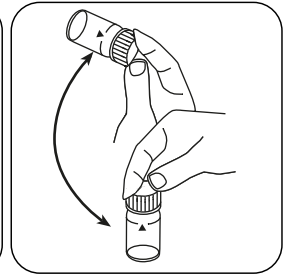

Dissolvez la(les) pastille(s) en mettant le tube plusieurs fois à l'envers.

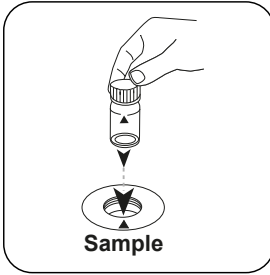

Placez la **cuvette réservée à l'échantillon** dans la chambre de mesure. Attention à la positionner correctement.

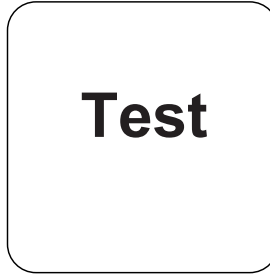

Appuyez sur la touche **TEST (XD: START)**.

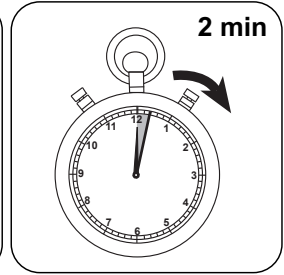

Attendez la fin du **temps de réaction de 2 minute(s)**.

À l'issue du temps de réaction, la mesure est effectuée automatiquement.

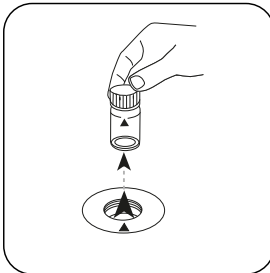

Retirez la cuvette de la chambre de mesure.

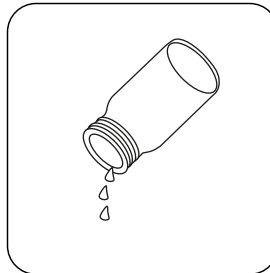

Videz la cuvette.

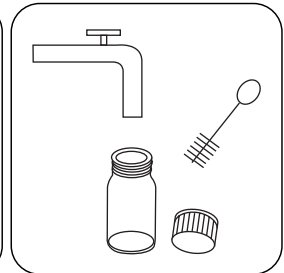

Nettoyez à fond la cuvette et le couvercle de la cuvette.



FR



Remplissez une **deuxième** cuvette de **10 mL** d'échantillon.

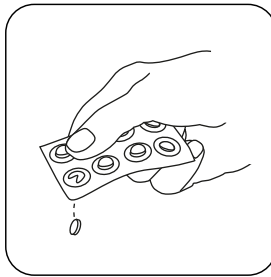

Ajoutez une **pastille de GLYCINE**.

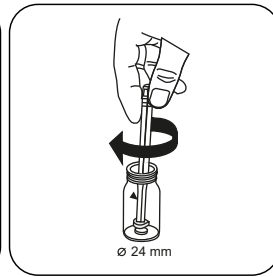

Écrasez la(les) pastille(s) en la(les) tournant un peu.

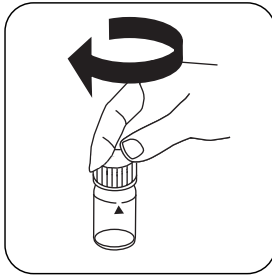

Fermez la(les) cuvette(s).

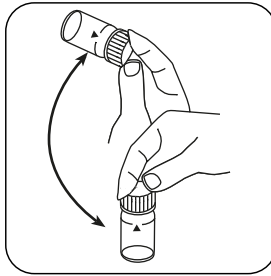

Dissolvez la(les) pastille(s) en mettant le tube plusieurs fois à l'envers.

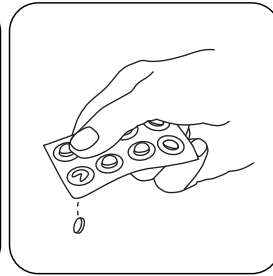

Déposez une pastille de DPD No. 1 et une pastille de DPD No. 3 immédiatement après l'avoir déballée, dans la première cuvette.

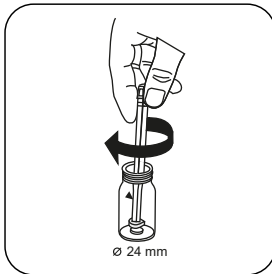

Écrasez la(les) pastille(s) en la(les) tournant un peu.

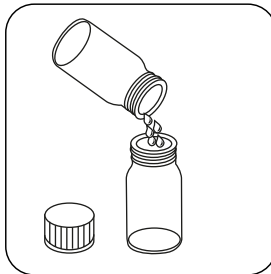

Versez la **solution de Glycine** préparée dans la cuvette préparée.

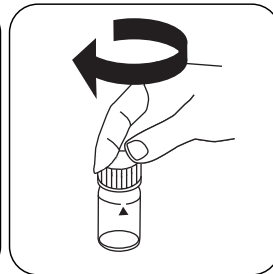

Fermez la(les) cuvette(s).

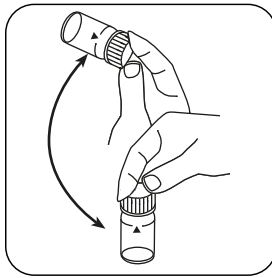

Dissolvez la(les) pastille(s) en mettant le tube plusieurs fois à l'envers.

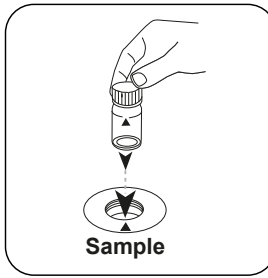

Placez la **cuvette réservée à l'échantillon** dans la chambre de mesure. Attention à la positionner correctement.

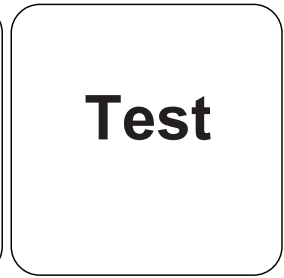

Appuyez sur la touche **TEST** (XD: **START**).

FR

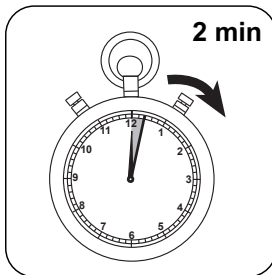

Attendez la fin du **temps de réaction de 2 minute(s)** .

À l'issue du temps de réaction, la mesure est effectuée automatiquement.

Le résultat s'affiche à l'écran en mg/L Ozone; chlore total mg/l.

Réalisation de la quantification Ozone, en l'absence de chlore avec pastille

Sélectionnez la méthode sur l'appareil.

Sélectionnez également la quantification : sans chlore



FR



Remplissez une cuvette de 24 mm de **10 mL d'échantillon**.

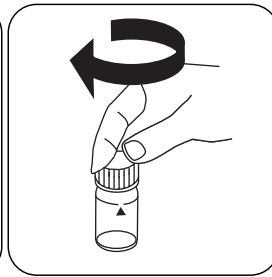

Fermez la(les) cuvette(s).

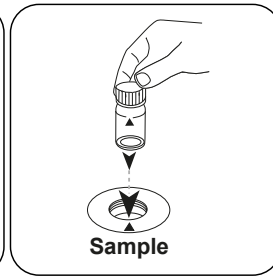

Placez la **cuvette réservée à l'échantillon** dans la chambre de mesure. Attention à la positionner correctement.

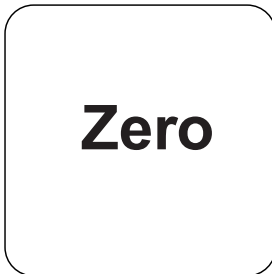

Appuyez sur la touche **ZERO**.

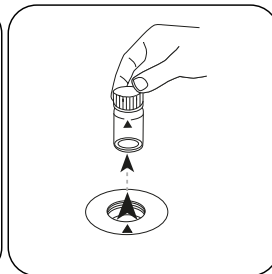

Retirez la cuvette de la chambre de mesure.

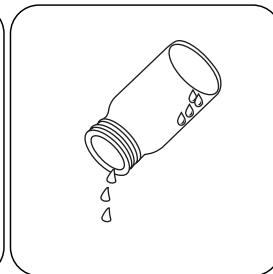

Videz pratiquement la cuvette en y laissant quelques gouttes.

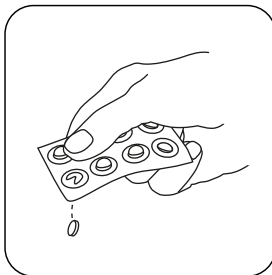

Ajoutez une **pastille de DPD No. 1**.

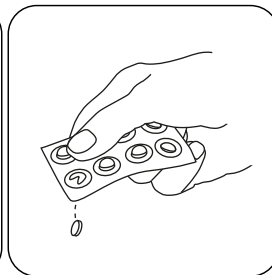

Ajoutez une **pastille de DPD No. 3**.

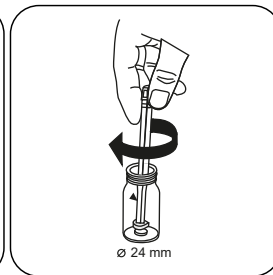

Écrasez la(les) pastille(s) en la(les) tournant un peu.



Remplissez la cuvette jusqu'au **repère de 10 mL** en y versant l'**échantillon**.

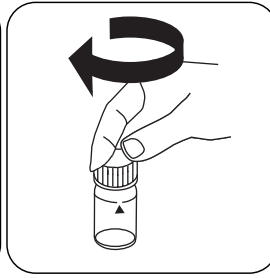

Fermez la(les) cuvette(s).

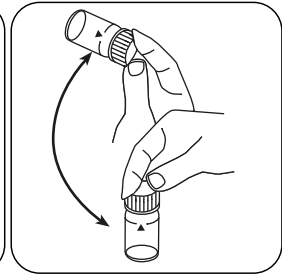

Dissolvez la(les) pastille(s) en mettant le tube plusieurs fois à l'envers.

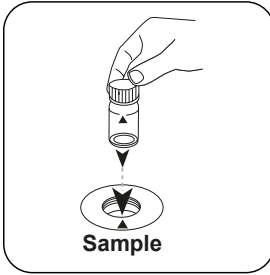

Placez la **cuvette réservée à l'échantillon** dans la chambre de mesure. Attention à la positionner correctement.

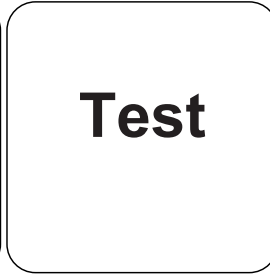

Appuyez sur la touche **TEST (XD: START)**.

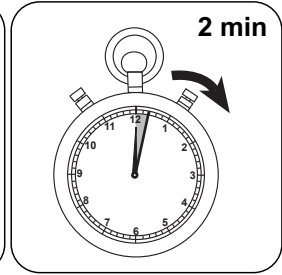

Attendez la fin du **temps de réaction de 2 minute(s)**.

À l'issue du temps de réaction, la mesure est effectuée automatiquement.

Le résultat s'affiche à l'écran en mg/L Ozone.



Analyses

Le tableau suivant identifie les valeurs de sortie qui peuvent être converties en d'autres formes de citation.

Unité	Formes de citation	Facteur de conversion
mg/l	O ₃	1
mg/l	Cl ₂	1.4771

FR

Méthode chimique

DPD / Glycine

Appendice

Interférences

Interférences persistantes

1. Les agents oxydants contenus dans les échantillons réagissent tous comme le chlore, ce qui entraîne des résultats plus élevés.
2. Les concentrations d'ozone supérieures à 6 mg/L peuvent provoquer des résultats dans la plage de mesure allant jusqu'à 0 mg/L. Dans ce cas, diluez l'échantillon d'eau. Le réactif est ajouté à 10 ml d'échantillon dilué. Ensuite, la mesure est répétée (test de plausibilité).

Bibliographie

Colorimetric Chemical Analytical Methods, 9th Edition, Lovibond

Dérivé de

DIN 38408-3:2011-04

^{a)}autre réactif, utilisé à la place de DPD No.1/3 en cas de turbidité dans l'échantillon d'eau due à une concentration élevée de calcium et/ou une conductivité élevée | ^{b)}nécessaire pour la détermination de brome, dioxyde de chlore et ozone en présence de chlore | ^{c)} agitateur inclus

KS4.3 T / 20

Denominazione metodo

Numero metodo

Codice a barre per riconoscere il metodo

Range di misura

Indicazione sul display del MD 100 / MD 110 / MD 200

Metodo chimico

Informazioni specifiche dello strumento

Il test può essere eseguito sui seguenti dispositivi. Inoltre, sono indicate la cuvetta richiesta e il range di assorbimento del fotometro.

Dispositivi	Cuvetta	λ	Campo di misura
MD 200, MD 600, MD 610, MD 640, MultiDirect, PM 620, PM 630	ø 24 mm	610 nm	0.1 - 4 mmol/l $K_{S_{4.3}}$
SpectroDirect, XD 7000, XD 7500	ø 24 mm	615 nm	0.1 - 4 mmol/l $K_{S_{4.3}}$

Materiale

Materiale richiesto (in parte facoltativo):

Titolo	Unità di imballaggio	N. ordine
Alka-M-Photometer	Pastiglia / 100	513210BT
Alka-M-Photometer	Pastiglia / 250	513211BT

Campo di applicazione

- Trattamento acqua di scarico
- Trattamento acqua potabile
- Trattamento acqua non depurata

Note

1. I termini alcalinità M, valore M, alcalinità totale e capacità acida $K_{S_{4.3}}$ sono equivalenti.
2. Per l'accuratezza del risultato dell'analisi è fondamentale che il volume del campione misuri esattamente 10 ml.

ISO 639-1 codici linguistici

Stato di revisione

IT Manuale dei Metodi 01/20

Svolgimento della misurazione

Esecuzione della rilevazione Capacità acida $K_{s4,3}$ con pastiglia

Selezionare il metodo nel dispositivo.

Con i seguenti dispositivi, per questo metodo non è necessario eseguire una misurazione ZERO: XD 7000, XD 7500



Riempire una cuvetta da 24 mm con **10 ml di campione**.



Chiudere la/e cuvetta/e.

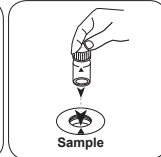

Posizionare la **cuvetta del campione** nel vano di misurazione. Fare attenzione al posizionamento.

• • •

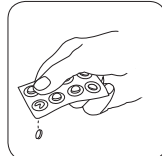

Aggiungere una **pastiglia ALKA-M-PHOTOMETER**.

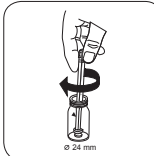

Frantumare la/e pastiglia/e con una leggera rotazione.

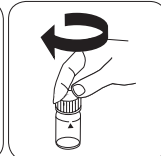

Chiudere la/e cuvetta/e.



Ozono T

M300

0.02 - 2 mg/L O₃O₃

DPD/glicina

Materiale

IT

Materiale richiesto (in parte facoltativo):

Reagenti	Unità di imballaggio	N. ordine
DPD No.1	Pastiglia / 100	511050BT
DPD No. 1	Pastiglia / 250	511051BT
DPD No. 1	Pastiglia / 500	511052BT
DPD No. 3	Pastiglia / 100	511080BT
DPD No. 3	Pastiglia / 250	511081BT
DPD No. 3	Pastiglia / 500	511082BT
DPD No. 1 Alto Calcio ^{e)}	Pastiglia / 100	515740BT
DPD No. 1 Alto Calcio ^{e)}	Pastiglia / 250	515741BT
DPD No. 1 Alto Calcio ^{e)}	Pastiglia / 500	515742BT
DPD No. 3 High Calcium ^{e)}	Pastiglia / 100	515730BT
DPD No. 3 High Calcium ^{e)}	Pastiglia / 250	515731BT
DPD No. 3 High Calcium ^{e)}	Pastiglia / 500	515732BT
Glicina ^{f)}	Pastiglia / 100	512170BT
Glicina ^{f)}	Pastiglia / 250	512171BT
Set DPD No. 1/no. 3 [#]	ciascuna 100	517711BT
Set DPD No. 1/no. 3 [#]	ciascuna 250	517712BT
Set DPD No. 1/no. 3 High Calcium [#]	ciascuna 100	517781BT
Set DPD No. 1/no. 3 High Calcium [#]	ciascuna 250	517782BT
Set DPD No. 1/glicina [#]	ciascuna 100	517731BT
Set DPD No. 1/glicina [#]	ciascuna 250	517732BT

Preparazione

1. Pulizia delle cuvette:
Poiché molti detersivi ad uso domestico (ad es. detersivo per piatti) contengono sostanze riducenti, nella successiva rilevazione di ossidanti (ad es. ozono, cloro) si potrebbero ottenere risultati troppo bassi. Per escludere tali errori di misura è necessario che i dispositivi in vetro siano esenti dal consumo di cloro. I dispositivi in vetro inoltre vengono conservati in una soluzione di ipoclorito di sodio (0,1 g/L) per un'ora e successivamente vengono risciacquati abbondantemente con acqua demineralizzata.
2. Nella preparazione del campione occorre evitare la degassificazione dell'ozono, ad es. utilizzando pipette e agitando. L'analisi deve essere eseguita subito dopo il prelievo del campione.
3. Le acque fortemente alcaline o acide devono essere portate prima dell'analisi entro un range di pH compreso tra 6 e 7 (con 0,5 mol/l di acido solforico o 1 mol/l di liscivia).



Esecuzione della rilevazione Ozono, in presenza di cloro con pastiglia

Selezionare il metodo nel dispositivo.

Selezionare inoltre la determinazione: in presenza di Cloro



Riempire una cuvetta da 24 mm con **10 mL di campione**.

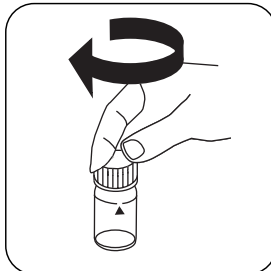

Chiudere la/e cuvetta/e.

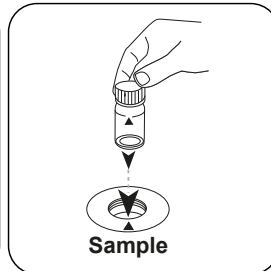

Posizionare la **cuvetta del campione** nel vano di misurazione. Fare attenzione al posizionamento.

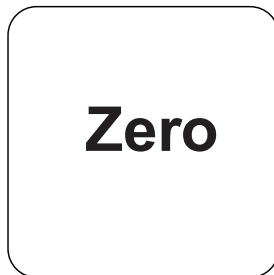

Premere il tasto **ZERO**.

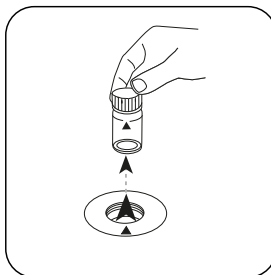

Prelevare la cuvetta dal vano di misurazione.

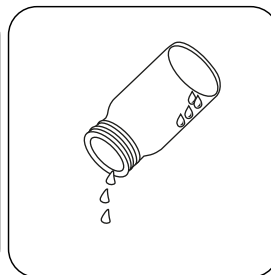

Svuotare la cuvetta finché non rimangono alcune gocce.

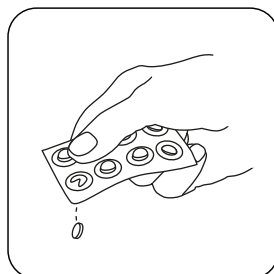

Aggiungere **una pastiglia DPD No. 1**.

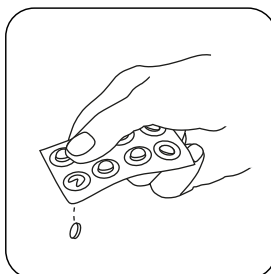

Aggiungere **una pastiglia DPD No. 3**.

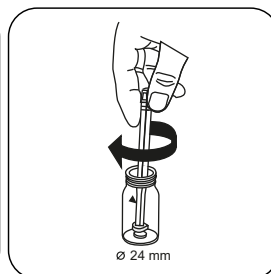

Frantumare la/e pastiglia/e con una leggera rotazione.



Immettere il **campione** nella cuvetta fino a raggiungere la **tacca dei 10 mL**.



Chiudere la/e cuvetta/e.

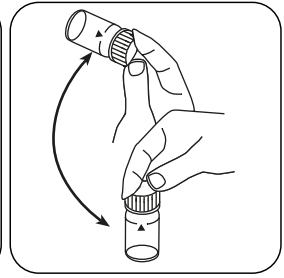

Far sciogliere la/e pastiglia/e agitando.

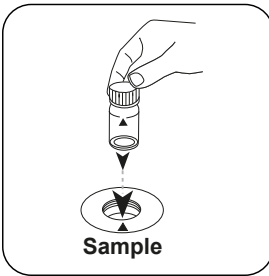

Posizionare la **cuvetta del campione** nel vano di misurazione. Fare attenzione al posizionamento.

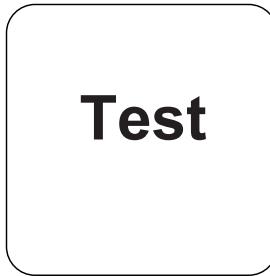

Premere il tasto **TEST** (XD: **START**).

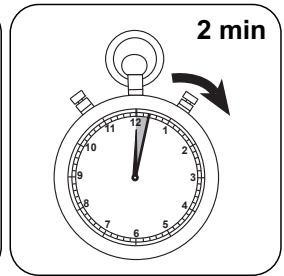

Attendere un **tempo di reazione di 2 minuto/i**.

Allo scadere del tempo di reazione viene effettuata automaticamente la misurazione.

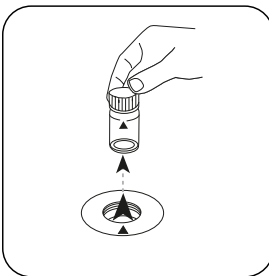

Prelevare la cuvetta dal vano di misurazione.

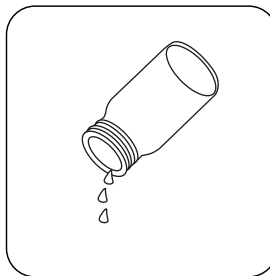

Svuotare la cuvetta.

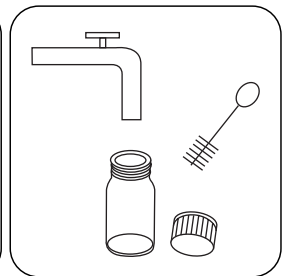

Pulire a fondo la cuvetta e il coperchio della cuvetta.

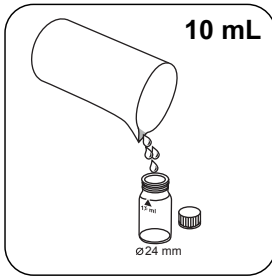

Riempire una **seconda** cuvetta con **10 mL di campione**.

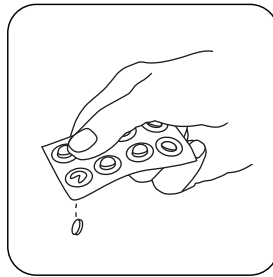

Aggiungere **una pastiglia GLYCINE**.

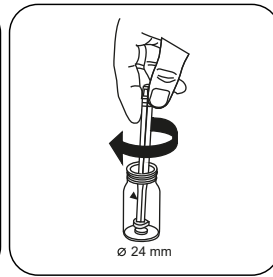

Frantumare la/e pastiglia/e con una leggera rotazione.

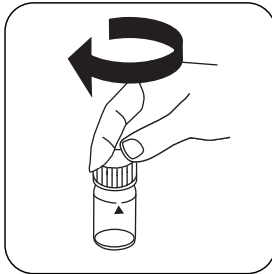

Chiudere la/e cuvetta/e.

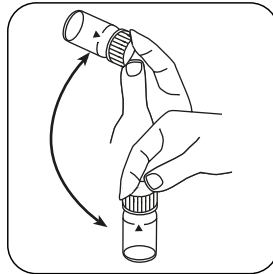

Far sciogliere la/e pastiglia/e agitando.

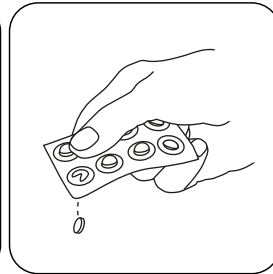

Immettere direttamente dalla pellicola nella prima cuvetta **una pastiglia DPD No. 1 e una pastiglia DPD No. 3**.

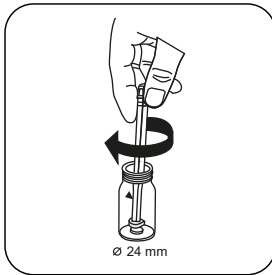

Frantumare la/e pastiglia/e con una leggera rotazione.

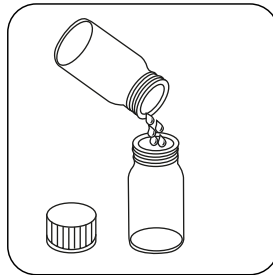

Immettere la **soluzione di glicina** preparata nella cuvetta preparata.

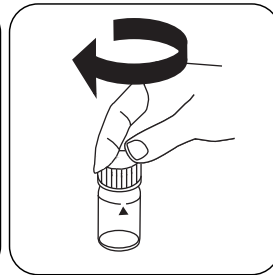

Chiudere la/e cuvetta/e.

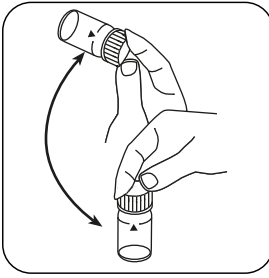

Far sciogliere la/e pastiglia/e agitando.

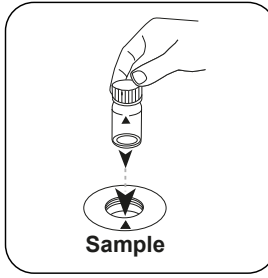

Posizionare la **cuvetta del campione** nel vano di misurazione. Fare attenzione al posizionamento.

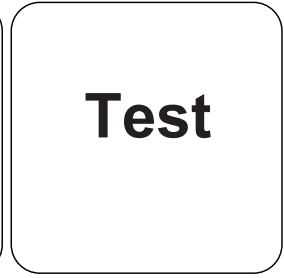

Premere il tasto **TEST** (XD: **START**).

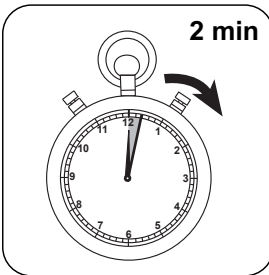

Attendere un **tempo di reazione di 2 minuto/i**.

Allo scadere del tempo di reazione viene effettuata automaticamente la misurazione.

Sul display compare il risultato in mg/L di Ozono; Cloro totale mg/l.

Esecuzione della rilevazione Ozono, in assenza di cloro con pastiglia

Selezionare il metodo nel dispositivo.

Selezionare inoltre la determinazione: senza Cloro



Riempire una cuvette da 24 mL con **10 mL di campione**.

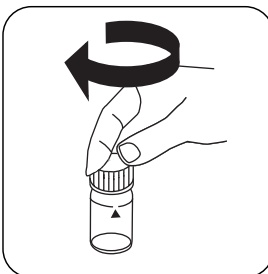

Chiedere la/e cuvette/e.

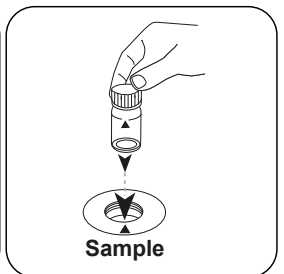

Posizionare la **cuvetta del campione** nel vano di misurazione. Fare attenzione al posizionamento.



Zero

Premere il tasto **ZERO**.

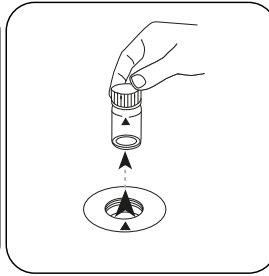

Prelevare la cuvetta dal vano di misurazione.

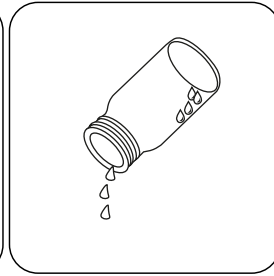

Svuotare la cuvetta finché non rimangono alcune gocce.

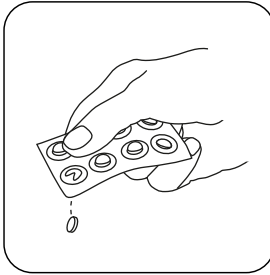

Aggiungere **una pastiglia DPD No. 1**.

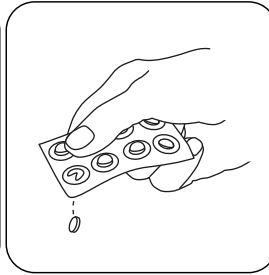

Aggiungere **una pastiglia DPD No. 3**.

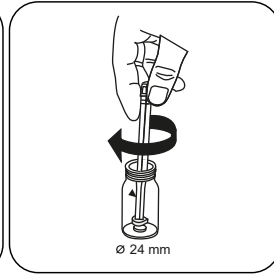

Frantumare la/e pastiglia/e con una leggera rotazione.



Immettere il **campione** nella cuvetta fino a raggiungere la **tacca dei 10 mL**.

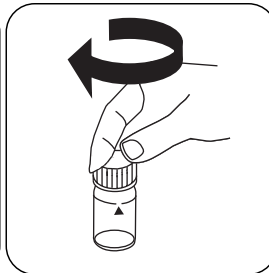

Chiudere la/e cuvetta/e.

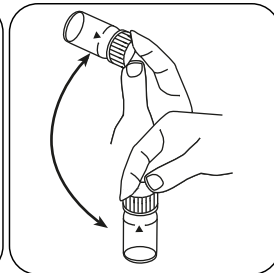

Far sciogliere la/e pastiglia/e agitando.

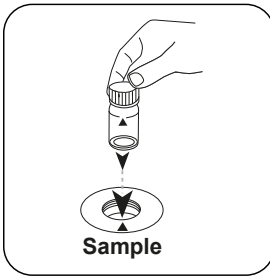

Posizionare la **cuvetta del campione** nel vano di misurazione. Fare attenzione al posizionamento.

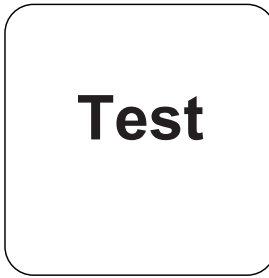

Premere il tasto **TEST** (XD: **START**).

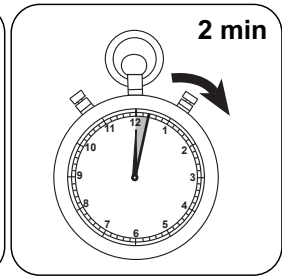

Attendere un **tempo di reazione di 2 minuti**.

Allo scadere del tempo di reazione viene effettuata automaticamente la misurazione. Sul display compare il risultato in mg/L di Ozono.



Valutazione

La seguente tabella identifica i valori di output che possono essere convertiti in altre forme di citazione.

Unità di misura	Forma di citazione	Fattore di conversione
mg/l	O ₃	1
mg/l	Cl ₂	1.4771

IT

Metodo chimico

DPD/glicina

Appendice

Interferenze

Interferenze permanenti

1. Tutti gli ossidanti presenti nei campioni reagiscono come il cloro dando risultati troppo elevati.
2. Le concentrazioni di ozono maggiori di 6 mg/L possono dare risultati entro il range di misura fino a 0 mg/L. In questo caso il campione di acqua deve essere diluito. 10 ml del campione diluito vengono addizionati con il reagente e la misurazione viene ripetuta (test di plausibilità).

Riferimenti bibliografici

Colorimetric Chemical Analytical Methods, 9th Edition, Lovibond

Derivato di

DIN 38408-3:2011-04

^{*)}Reagente ausiliario, in alternativa a DPD n. 1 / no 3 in caso di torbidità del campione a causa di alto contenuto di ioni di calcio e / o alta conduttività | ^{*)}Reagente ausiliario, è inoltre necessario per la determinazione di bromo, biossido di cloro o ozono in presenza di cloro | ^{*)}Bacchetta compresa

KS4.3 T / 20



Nome do método

Número do método

Código de barras para a detecção dos métodos

Área de medição

Indicado no display: MD 100 / MD 110 / MD 200

$K_{S_{4.3} T}$
0.1 - 4 mmol/l $K_{S_{4.3}}$
Ácido / Indicador

Método Químico

Informação específica do instrumento

O teste pode ser realizado nos seguintes dispositivos. Além disso, a cubeta necessária e a faixa de absorção do fotómetro são indicadas.

Dispositivos	Cubeta	λ	Faixa de Medição
MD 200, MD 600, MD 610, MD 640, MultiDirect, PM 620, PM 630	ø 24 mm	610 nm	0.1 - 4 mmol/l $K_{S_{4.3}}$
SpectroDirect, XD 7000, XD 7500	ø 24 mm	615 nm	0.1 - 4 mmol/l $K_{S_{4.3}}$

Material

Material necessário (parcialmente opcional):

Título	Unidade de Embalagem	Artigo No
Alka-M-Photometer	Pastilhas / 100	513210BT
Alka-M-Photometer	Pastilhas / 250	513211BT

Lista de Aplicações

- Tratamento de Esgotos
- Tratamento de Água Potável
- Tratamento de Água Bruta

Notas

1. Os termos alcalinidade-m, m-valor, alcalinidade total e capacidade de acidez $K_{S_{4.3}}$ são idênticos.
2. O cumprimento exato do volume da amostra de 10 ml é decisivo para a precisão do resultado de análise.

Códigos de idioma ISO 639-1

Nível de revisão

PT Métodos Manual 01/20

Efetuar a medição

Realização da determinação Capacidade de acidez $K_{s4.3}$ com pastilha

Escolher o método no equipamento.

Para este método não tem de ser efetuada uma medição ZERO nos seguintes equipamentos: XD 7000, XD 7500

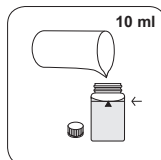

Encher a célula de 24 mm com 10 ml de amostra .

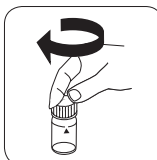

Fechar a(s) célula(s).

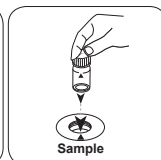

Colocar a **célula de amostra** no compartimento de medição. Observar o posicionamento.

• • •

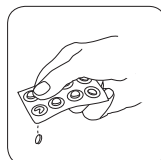

Pastilha ALKA-M-PHOTO-METER.

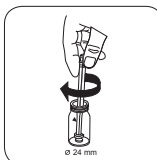

Esmagar a(s) pastilha(s) rodando ligeiramente.

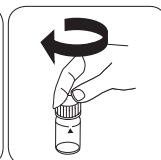

Fechar a(s) célula(s).

PT Métodos Manual 01/20

PT



Ozono T

M300

0.02 - 2 mg/L O₃O₃

DPD / Glicina

Material

PT

Material necessário (parcialmente opcional):

Reagentes	Unidade de Embalagem	Código do Produto
DPD N.º. 1	Pastilhas / 100	511050BT
DPD N.º. 1	Pastilhas / 250	511051BT
DPD N.º. 1	Pastilhas / 500	511052BT
DPD N.º. 3	Pastilhas / 100	511080BT
DPD N.º. 3	Pastilhas / 250	511081BT
DPD N.º. 3	Pastilhas / 500	511082BT
DPD N.º. 1 Alto Cálcio ^{e)}	Pastilhas / 100	515740BT
DPD N.º. 1 Alto Cálcio ^{e)}	Pastilhas / 250	515741BT
DPD N.º. 1 Alto Cálcio ^{e)}	Pastilhas / 500	515742BT
DPD N.º. 3 Alto Cálcio ^{e)}	Pastilhas / 100	515730BT
DPD N.º. 3 Alto Cálcio ^{e)}	Pastilhas / 250	515731BT
DPD N.º. 3 Alto Cálcio ^{e)}	Pastilhas / 500	515732BT
Glicina ^{f)}	Pastilhas / 100	512170BT
Glicina ^{f)}	Pastilhas / 250	512171BT
Definir N.º DPD 1/Não. 3 [#]	cada 100	517711BT
Definir N.º DPD 1/Não. 3 [#]	cada 250	517712BT
Definir N.º DPD 1/Não. 3 Alto Cálcio [#]	cada 100	517781BT
Definir N.º DPD 1/Não. 3 Alto Cálcio [#]	cada 250	517782BT
Definir N.º DPD 1/Glicina [#]	cada 100	517731BT
Definir N.º DPD 1/Glicina [#]	cada 250	517732BT

Preparação

1. Limpeza das células:
Uma vez que muitos produtos de limpeza domésticos (p. ex. lava-louça) contêm substâncias redutoras, na determinação que se segue de oxidantes (p. ex. ozono, cloro) pode haver demasiadas reduções. Para excluir este erro de medição, os equipamentos de vidro não deviam ter a capacidade de absorção de cloro. Para esse efeito, os equipamentos de vidro são guardados por uma hora sob solução de hipoclorito de sódio (0,1 g/L) e depois devem ser bem enxaguados com água desmineralizada.
2. Na preparação da amostra é preciso evitar a libertação de gases de ozono, p. ex. através da pipetagem e agitação. A análise tem de ser efetuada logo após a recolha da amostra.
3. As águas fortemente alcalinas ou ácidas devem, antes da análise, ser ajustadas para um valor pH entre 6 e 7 (com 0,5 mol/l de ácido sulfúrico ou 1 mol/l soda cáustica).



Realização da determinação Ozono na presença de cloro com pastilha

Escolher o método no equipamento.

Escolha ainda a determinação: na presença de Cloro

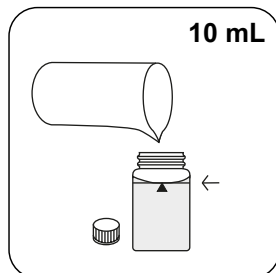

Encher a célula de 24 mm com **10 mL de amostra**.

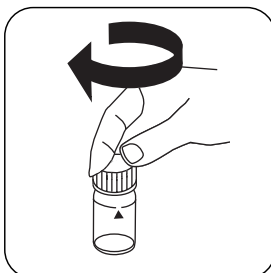

Fechar a(s) célula(s).

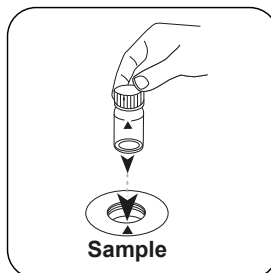

Colocar a **célula de amostra** no compartimento de medição. Observar o posicionamento.

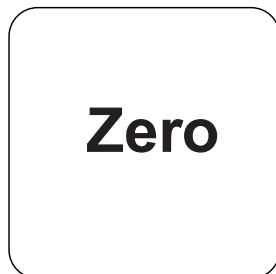

Premir a tecla **ZERO**.

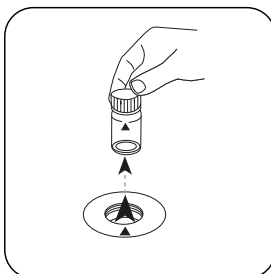

Retirar a célula do compartimento de medição.

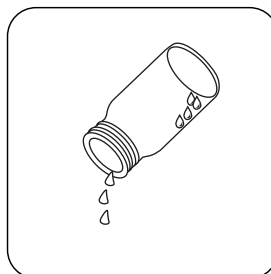

Esvaziar a célula até ficarem apenas algumas gotas.

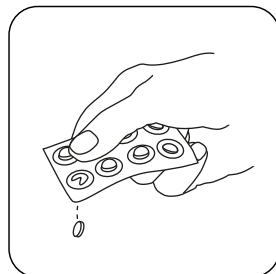

Pastilha DPD No. 1.

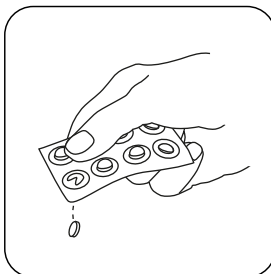

Pastilha DPD No. 3.

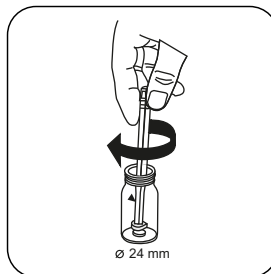

Esmagar a(s) pastilha(s) rodando ligeiramente.



Encher a célula até à **marca de 10 mL** com a amostra .

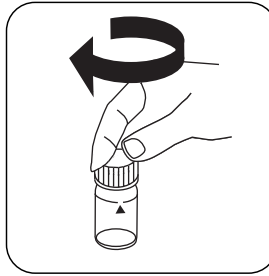

Fechar a(s) célula(s).

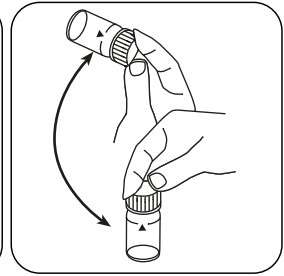

Dissolver a(s) pastilha(s) girando.

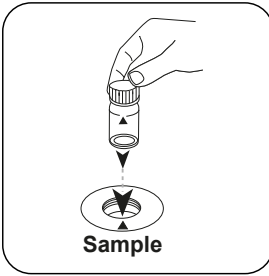

Colocar a **célula de amostra** no compartimento de medição. Observar o posicionamento.

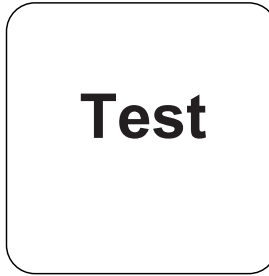

Premir a tecla **TEST** (XD: **START**).

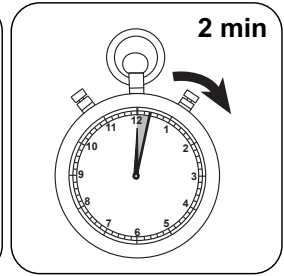

Aguardar **2 minuto(s)** de tempo de reação.

Decorrido o tempo de reação, a medição é efetuada automaticamente.

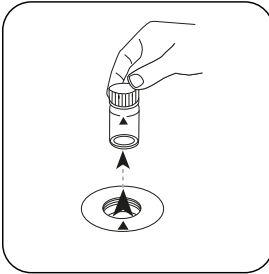

Retirar a célula do compartimento de medição.

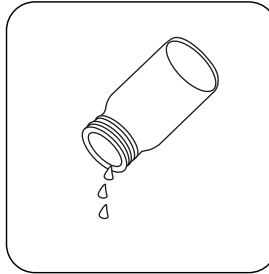

Esvaziar a célula.

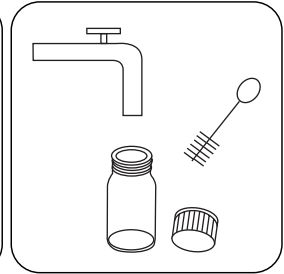

Limpar bem a célula e a tampa da mesma.



Encher uma **segunda célula** com **10 mL de amostra** .

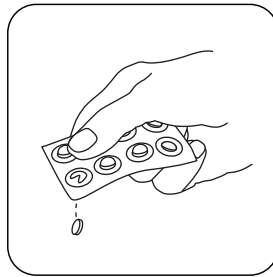

Pastilha GLYCINE.

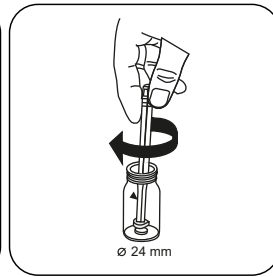

Esmagar a(s) pastilha(s) rodando ligeiramente.

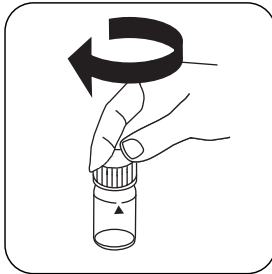

Fechar a(s) célula(s).

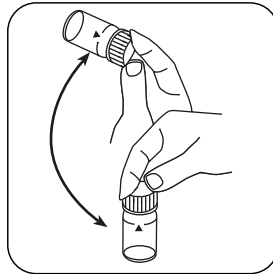

Dissolver a(s) pastilha(s) girando.

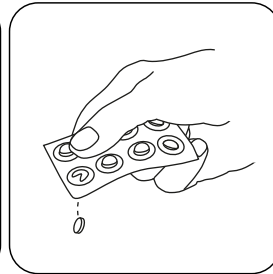

Adicionar uma **pastilha DPD No. 1** e uma **pastilha DPD No. 3** diretamente da película à primeira célula.

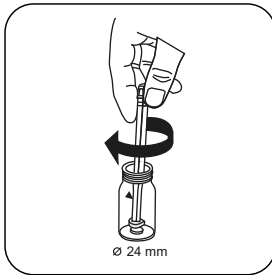

Esmagar a(s) pastilha(s) rodando ligeiramente.

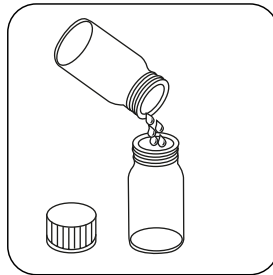

Introduzir a **solução de glicina** preparada na célula preparada.

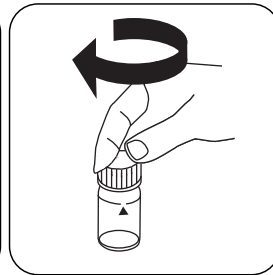

Fechar a(s) célula(s).

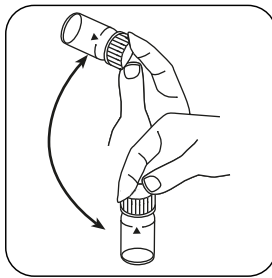

Dissolver a(s) pastilha(s) girando.

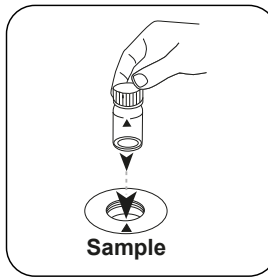

Colocar a **célula de amostra** no compartimento de medição. Observar o posicionamento.

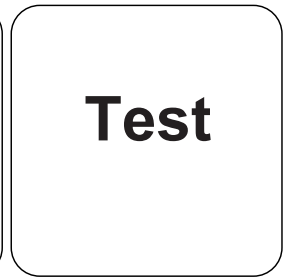

Premir a tecla **TEST** (XD: **START**).

PT

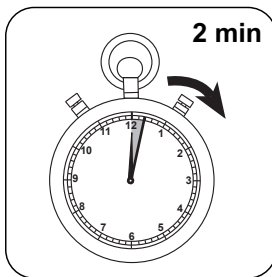

Aguardar **2 minuto(s)** de tempo de reação.

Decorrido o tempo de reação, a medição é efetuada automaticamente.

No visor aparece o resultado em mg/L Ozono; mg/l cloro total.

Realização da determinação Ozono, na ausência de cloro com pastilha

Escolher o método no equipamento.

Escolha ainda a determinação: sem Cloro



Encher a célula de 24 mm com **10 mL de amostra**.

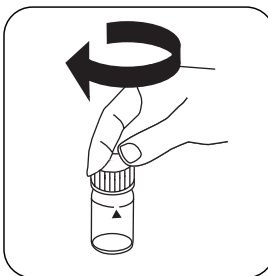

Fechar a(s) célula(s).

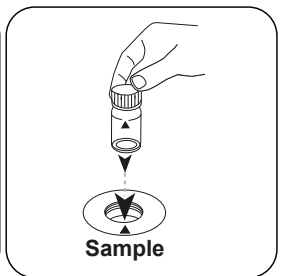

Colocar a **célula de amostra** no compartimento de medição. Observar o posicionamento.



Zero

PT

Premir a tecla **ZERO**.

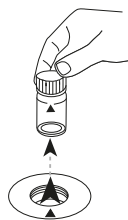

Retirar a célula do compartimento de medição.

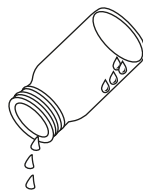

Esvaziar a célula até ficarem apenas algumas gotas.

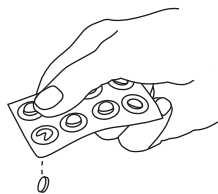

Pastilha DPD No. 1.

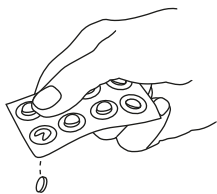

Pastilha DPD No. 3.

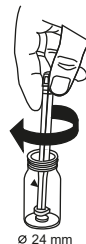

Esmagar a(s) pastilha(s) rodando ligeiramente.

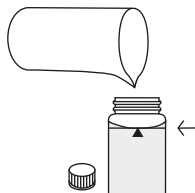

Encher a célula até à marca de 10 mL com a amostra .

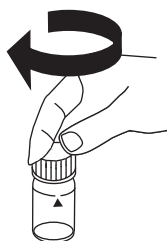

Fechar a(s) célula(s).

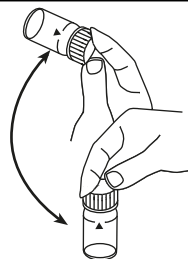

Dissolver a(s) pastilha(s) girando.

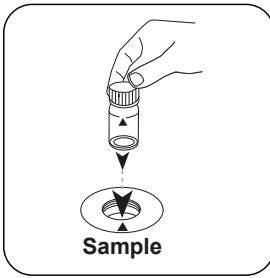

Colocar a **célula de amostra** no compartimento de medição. Observar o posicionamento.

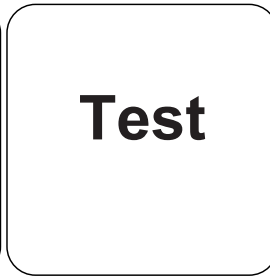

Premir a tecla **TEST** (XD: **START**).

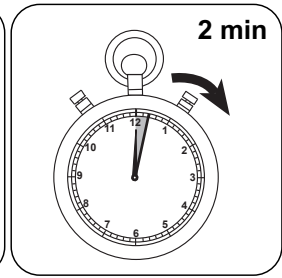

Aguardar **2 minuto(s) de tempo de reação**.

Decorrido o tempo de reação, a medição é efetuada automaticamente.

No visor aparece o resultado em mg/L Ozono.



Análises

A tabela a seguir identifica os valores de saída que podem ser convertidos em outras formas de citação.

Unidade	Forma de citação	Fator de conversão
mg/l	O ₃	1
mg/l	Cl ₂	1.4771

PT

Método Químico

DPD / Glicina

Apêndice

Texto de Interferências

Interferências Persistentes

1. Todos os oxidantes presentes nas amostras reagem como o cloro, o que leva a resultados demasiado altos.
2. Concentrações de ozono superiores a 6 mg/L de podem causar resultados dentro da área de medição até 0 mg/L. Neste caso, deve diluir a amostra de água. 10 ml da amostra diluída é colocada em reagente e a medição é repetida (teste de plausibilidade).

Bibliografia

Colorimetric Chemical Analytical Methods, 9th Edition, Lovibond

Derivado de

DIN 38408-3:2011-04

^oReagente auxiliar, alternativamente ao DPD no. 1 / não 3 quando a amostra é nublada devido ao alto teor de íons de cálcio e / ou alta condutividade | ^oReagente auxiliar, é adicionalmente necessário para a determinação de bromo, dióxido de cloro ou ozônio na presença de cloro | ^{*}incluindo vareta de agitação

KS4.3 T / 20



Naam van de methode

Nummer methode

Streepjescode ter identificatie van de methode

Meetbereik

$K_{S4.3} T$ M20
0.1 - 4 mmol/l $K_{S4.3}$ S:4.3
Zuur / Indicator

Chemische methode

Uitlezing in MD
100 MD 110 / MD 200

Instrument specifieke informatie

De test kan op de volgende apparaten worden uitgevoerd. Bovendien worden de vereiste cuvette en het absorptiebereik van de fotometer aangegeven.

Toestellen	Cuvet	λ	Meetbereik
MD 200, MD 600, MD 610, MD 640, MultiDirect, PM 620, PM 630	\varnothing 24 mm	610 nm	0.1 - 4 mmol/l $K_{S4.3}$
SpectroDirect, XD 7000, XD 7500	\varnothing 24 mm	615 nm	0.1 - 4 mmol/l $K_{S4.3}$

Reagentia

Benodigd materiaal (deels optioneel):

Titel	Verpakkingseenheid	Bestelnr.
Alka-M-Photometer	Tablet / 100	513210BT
Alka-M-Photometer	Tablet / 250	513211BT

Toepassingsbereik

- Afvalwaterzuivering
- Behandeling drinkwater
- Zuivering vervuild water

Aantekeningen

1. De termen alkaliteit-m, m-waarde, totale alkaliteit en zuurcapaciteit_{S4.3} zijn identiek.
2. De exacte naleving van het monstervolume van 10 ml is bepalend voor de nauwkeurigheid van het analysesresultaat.

Beknopte naam conform de norm ISO 639-1

Herziene versie

NL Handboek van Methoden 01/20

Uitvoering van de meting

Uitvoering van de bepaling Zuurcapaciteit $K_{s4,3}$ met tablet

De methode in het apparaat selecteren.

Voor deze methode moet bij de volgende apparaten geen nulmeting worden uitgevoerd:
XD 7000, XD 7500



Spoelbakje van 24 mm met **10 ml staal** vullen.

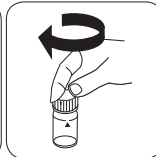

De spoelbakjes afsluiten.

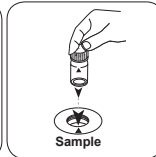

Het **staalspoelbakje** in de meetschacht plaatsen. Op de positionering letten.

• • •

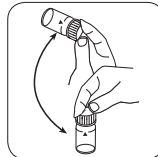

Tabletten oplossen door om te draaien

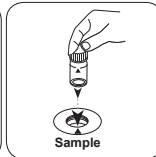

Het **staalspoelbakje** in de meetschacht plaatsen. Op de positionering letten.



De toets **TEST** (XD: **START**) indrukken.

De display toont het resultaat als Zuurcapaciteit $K_{s4,3}$.



Ozon T

M300

0.02 - 2 mg/L O₃O₃

DPD/Glycine

Reagentia

NL

Benodigd materiaal (deels optioneel):

Reagentia	Verpakkingseenheid	Bestelnr.
DPD Nr. 1	Tablet / 100	511050BT
DPD Nr. 1	Tablet / 250	511051BT
DPD Nr. 1	Tablet / 500	511052BT
DPD Nr. 3	Tablet / 100	511080BT
DPD Nr. 3	Tablet / 250	511081BT
DPD Nr. 3	Tablet / 500	511082BT
DPD Nr. 1 hoog calcium ^{e)}	Tablet / 100	515740BT
DPD Nr. 1 hoog calcium ^{e)}	Tablet / 250	515741BT
DPD Nr. 1 hoog calcium ^{e)}	Tablet / 500	515742BT
DPD Nr. 3 hoog calcium ^{e)}	Tablet / 100	515730BT
DPD Nr. 3 hoog calcium ^{e)}	Tablet / 250	515731BT
DPD Nr. 3 hoog calcium ^{e)}	Tablet / 500	515732BT
Glycine ^{f)}	Tablet / 100	512170BT
Glycine ^{f)}	Tablet / 250	512171BT
Set DPD nr. 1/Nr. 3 [#]	per 100	517711BT
Set DPD nr. 1/Nr. 3 [#]	per 250	517712BT
Set DPD nr. 1/Nr. 3 hoog calcium [#]	per 100	517781BT
Set DPD nr. 1/Nr. 3 hoog calcium [#]	per 250	517782BT
Set DPD nr. 1/glycine [#]	per 100	517731BT
Set DPD nr. 1/glycine [#]	per 250	517732BT

Vorbereiding

1. Het schoonmaken van de spoelbakjes:
Aangezien veel huishoudelijke reinigingsmiddelen (bijv. afwasmiddelen) reducerende stoffen bevatten, kan de latere bepaling van oxidatiemiddelen (bijv. ozon, chloor) tot verminderde resultaten leiden. Om deze meetfout uit te sluiten, moeten de glasapparaten chloorvrij zijn. Hiertoe wordt het glaswerk gedurende één uur onder natriumhypochlorietoplossing (0,1 g/L) bewaard en vervolgens grondig gespoeld met gedeïoniseerd water.
2. Tijdens de monstervorbereiding moet worden vermeden dat er ozon wordt uitgestoten, bijvoorbeeld door pipetteren en schudden. De analyse moet onmiddellijk na de bemonstering worden uitgevoerd.
3. Sterk alkalisch of zuur water moet vóór de analyse in een pH-gebied tussen 6 en 7 (met 0,5 mol/l zwavelzuur of 1 mol/l-natriumhydroxideoplossing) worden gebracht.

NL



Uitvoering van de bepaling Ozon, naast chloor met tablet

De methode in het apparaat selecteren.

Selecteer bovendien de bepaling: naast chloor



Spoelbakje van 24 mm met **10 mL staal** vullen.

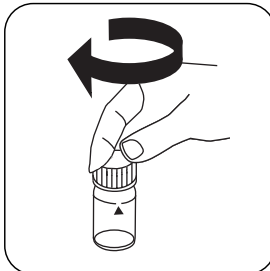

De spoelbakjes afsluiten.

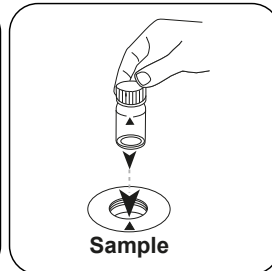

Het **staalspoelbakje** in de meetschacht plaatsen. Op de positionering letten.

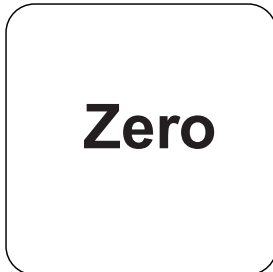

De toets **NUL** indrukken.

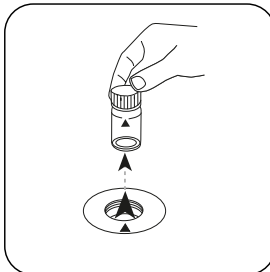

Het spoelbakje uit de meetschacht nemen.

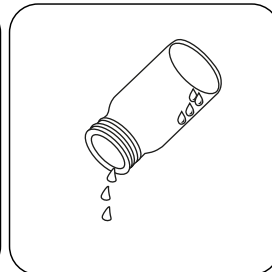

Het spoelbakje tot op enkele druppels ledigen.

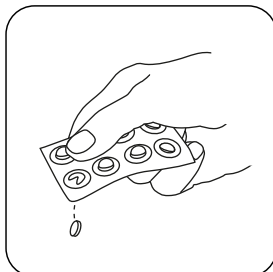

Een **DPD Nr. 1** tablet toevoegen.

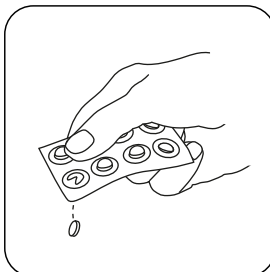

Een **DPD Nr. 3** tablet toevoegen.

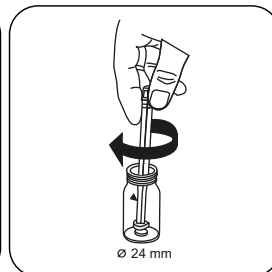

De tabletten onder lichte rotatie verpletteren.



Het spoelbakje tot aan de **markering van 10 mL** met het **staal** vullen.

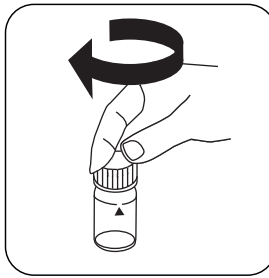

De spoelbakjes afsluiten.

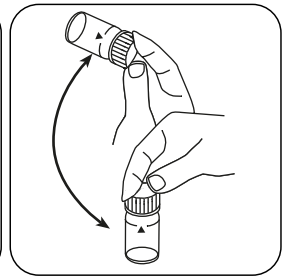

Tabletten oplossen door om te draaien

NL

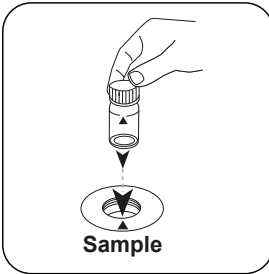

Het **staal**spoelbakje in de meetschacht plaatsen. Op de positionering letten.

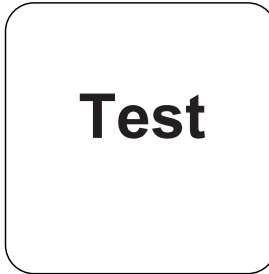

De toets **TEST (XD: START)** indrukken.

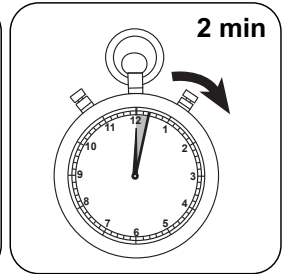

De reactietijd van **2 minuten** afwachten.

Na afloop van de reactietijd wordt de meting automatisch uitgevoerd.

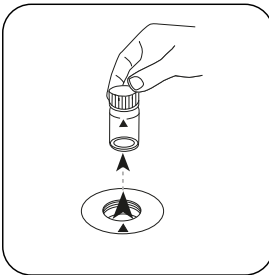

Het spoelbakje uit de meetschacht nemen.

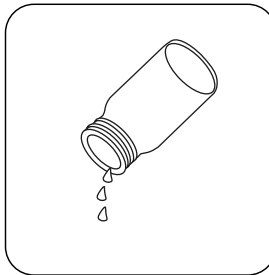

Het spoelbakje ledigen.

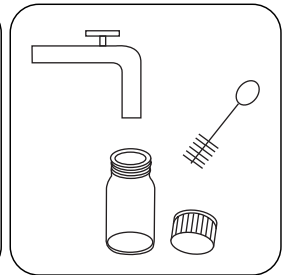

Het spoelbakje en het deksel van het spoelbakje grondig reinigen.



NL

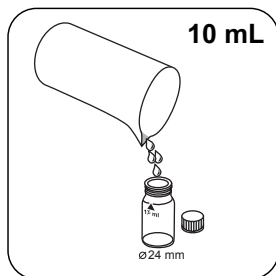

Een tweede spoelbakje met **10 mL** staal vullen.

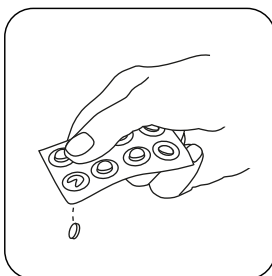

Een **GLYCINE** tablet toevoegen.

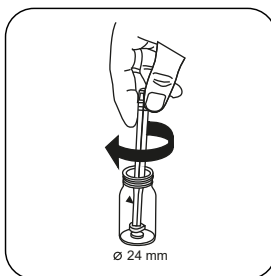

De tabletten onder lichte rotatie verpletteren.

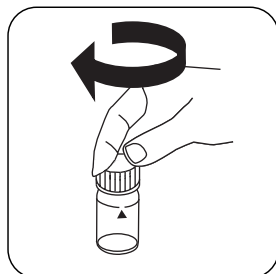

De spoelbakjes afsluiten.

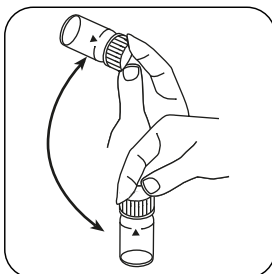

Tabletten oplossen door om te draaien

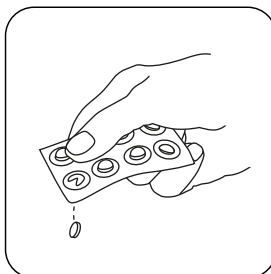

Een **DPD Nr. 1** tablet en een **DPD Nr. 3** tablet rechtstreeks uit de folie in het eerste spoelbakje doen.

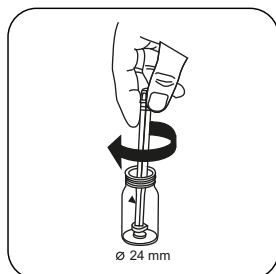

De tabletten onder lichte rotatie verpletteren.

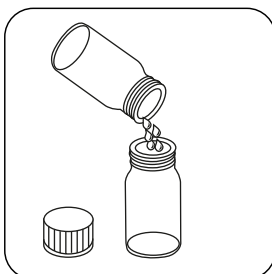

De voorbereide **glycineoplossing** in het voorbereide spoelbakje doen.

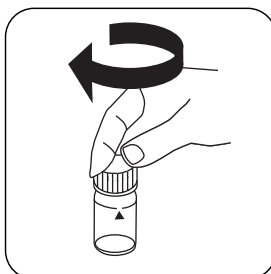

De spoelbakjes afsluiten.

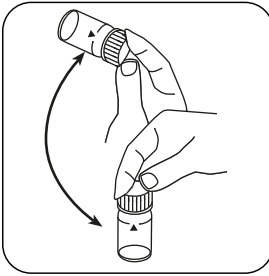

Tabletten oplossen door om te draaien

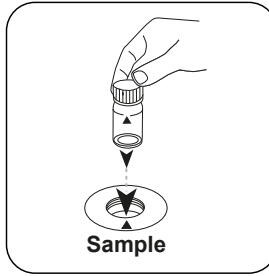

Het **staalspoelbakje** in de meetschacht plaatsen. Op de positionering letten.

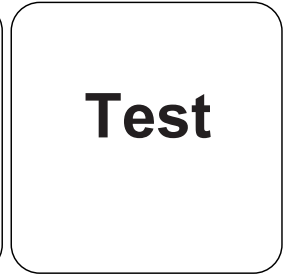

De toets **TEST** (XD: **START**) indrukken.

NL

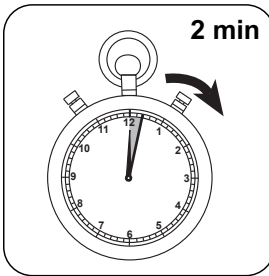

De reactietijd van **2 minuten** afwachten.

Na afloop van de reactietijd wordt de meting automatisch uitgevoerd.

De display toont het resultaat in mg/L Ozon; mg/l totaal chloor.

Uitvoering van de bepaling Ozon, in afwezigheid van chloor met tablet

De methode in het apparaat selecteren.

Selecteer bovendien de bepaling: zonder chloor



Spoelbakje van 24 mm met **10 mL staal** vullen.

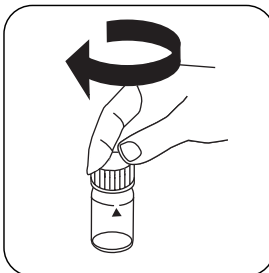

De spoelbakjes afsluiten.

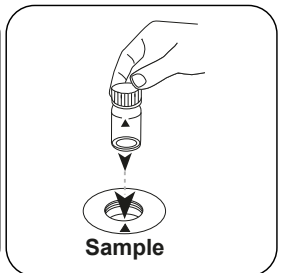

Het **staalspoelbakje** in de meetschacht plaatsen. Op de positionering letten.



Zero

De toets **NUL** indrukken.

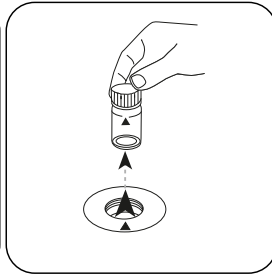

Het spoelbakje uit de meetschacht nemen.

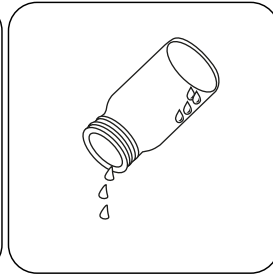

Het spoelbakje tot op enkele druppels ledigen.

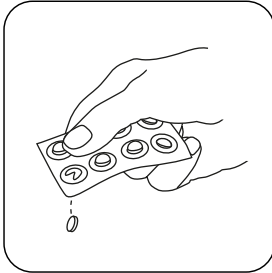

Een DPD Nr. 1 tablet toevoegen.

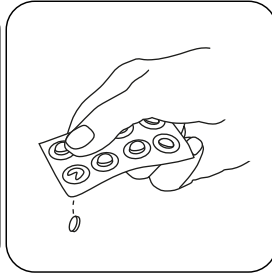

Een DPD Nr. 3 tablet toevoegen.

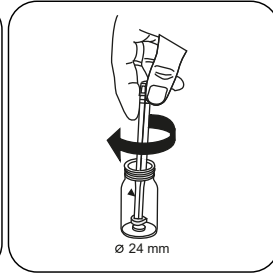

De tabletten onder lichte rotatie verpletteren.



Het spoelbakje tot aan de **markering van 10 mL** met het **staal** vullen.

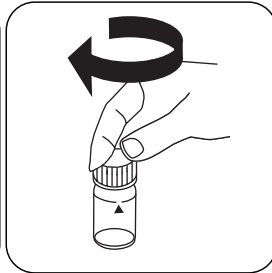

De spoelbakjes afsluiten.

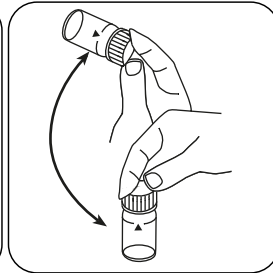

Tabletten oplossen door om te draaien

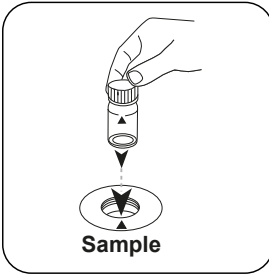

Het **staalspoelbakje** in de meetschacht plaatsen. Op de positionering letten.

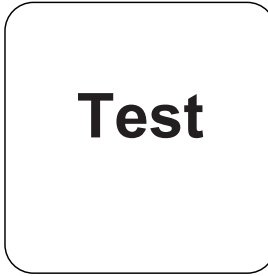

De toets **TEST** (XD: **START**) indrukken.

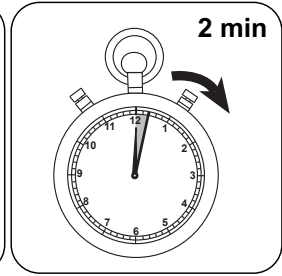

De reactietijd van **2 minuten** afwachten.

Na afloop van de reactietijd wordt de meting automatisch uitgevoerd.

De display toont het resultaat in mg/L Ozon.



Evaluatie

De volgende tabel geeft aan dat de uitvoerwaarden kunnen worden geconverteerd naar andere citatievormen.

Einheid	Dagvaardingsformulier	Omrekeningsfactor
mg/l	O ₃	1
mg/l	Cl ₂	1.4771

NL

Chemische methode

DPD/Glycine

Aanhangsel

Verstoringen

Permanente verstoringen

1. Alle oxidatiemiddelen in de monsters reageren als chloor, wat tot extra resultaten leidt.
2. Concentraties boven de 6 mg/L ozon kunnen leiden tot resultaten binnen het meetbereik tot 0 mg/L. In dit geval moet het watermonster worden verdund. Voeg reagens toe aan 10 ml van het verdunde monster en herhaal de meting (plausibiliteitstest).

Literatuurverwijzing

Colorimetric Chemical Analytical Methods, 9th Edition, Lovibond

Afgeleid van

DIN 38408-3:2011-04

^{a)} hulpreagens, alternatief voor DPD-nr. 1 / nr. 3 in geval van troebelheid van het monster als gevolg van een hoog calciumionengehalte en/of een hoge geleidbaarheid | ^{b)} hulpreagens, extra nodig voor de bepaling van broom, chloordioxide of ozon in aanwezigheid van chloor | * met inbegrip van de mengstaaf

KS4.3 T / 20

方法名称

方法号

用于方法检测的条形码

测量范围

酸性 / 指示剂

屏幕显示: MD 100 / MD 110 / MD 200

化学方法

儀器的具體信息

測試可以在以下設備上執行。此外還指出了所需的比色杯和光度計的吸收範圍。

儀器類型	比色皿	λ	測量範圍
MD 200, MD 600, MD 610, MD 640, MultiDirect, PM 620, PM 630	\varnothing 24 mm	610 nm	0.1 - 4 mmol/l $K_{S4.3}$
SpectroDirect, XD 7000, XD 7500	\varnothing 24 mm	615 nm	0.1 - 4 mmol/l $K_{S4.3}$

材料

所需材料 (部分可選) :

標題	包裝單位	貨號
Alka-M-Photometer	片劑 / 100	513210BT
Alka-M-Photometer	片劑 / 250	513211BT

應用列表

- 污水處理
- 飲用水處理
- 原水處理

備註

1. 術語總度-m、m-值、總碱度和酸容量 $K_{S4.3}$ 是相同的。
2. 準確地遵守 10 ml 的樣本體積對分析結果的準確度至關重要。

語言代碼 ISO 639-1

修訂狀態

CN 方法手冊 01/20

开始测量

进行测定 $K_{s4.3}$ 片剂酸容量

选择设备中的方法。

对于这种方法，在以下设备上不能进行 ZERO 测量：XD 7000, XD 7500

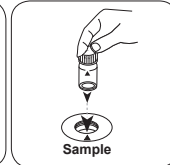
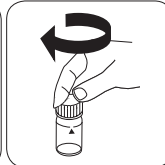
用 10 ml 样本填充 24 mm 比密封比色杯。
色杯。将样本比色杯放入测量轴
中。注意定位。

• • •

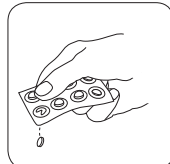
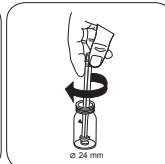
加入 ALKA-M-PHOTOME-
TER 片剂。

用轻微的扭转压碎片剂。

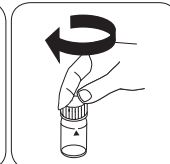

密封比色杯。

CN 方法手册 01/20

ZH



T 臭氧

M300

0.02 - 2 mg/L O₃

O3

DPD / 甘氨酸

材料

所需材料 (部分可选) :

ZH

试剂	包装单位	货号
DPD No.1	片剂 / 100	511050BT
DPD No.1	片剂 / 250	511051BT
DPD No.1	片剂 / 500	511052BT
DPD No.3	片剂 / 100	511080BT
DPD No.3	片剂 / 250	511081BT
DPD No.3	片剂 / 500	511082BT
DPD No.1 高钙 ^①	片剂 / 100	515740BT
DPD No.1 高钙 ^①	片剂 / 250	515741BT
DPD No.1 高钙 ^①	片剂 / 500	515742BT
DPD No.3 高钙 ^①	片剂 / 100	515730BT
DPD No.3 高钙 ^①	片剂 / 250	515731BT
DPD No.3 高钙 ^①	片剂 / 500	515732BT
甘氨酸 ^②	片剂 / 100	512170BT
甘氨酸 ^②	片剂 / 250	512171BT
套件 DPD No.1/No.3 [#]	各100次	517711BT
套件 DPD No.1/No.3 [#]	各250次	517712BT
套件 DPD No.1/No.3 高钙 [#]	各100次	517781BT
套件 DPD No.1/No.3 高钙 [#]	各250次	517782BT
套件 DPD No.1/甘氨酸 [#]	各100次	517731BT
套件 DPD No.1/甘氨酸 [#]	各250次	517732BT

准备

1. 清洗比色杯 :

由于许多家用清洁剂 (例如洗碗用洗涤剂) 含有还原剂, 所以随后测定的氧化剂 (例如臭氧、氯) 结果可能会不足。为了排除这种测量误差, 玻璃器皿应无氯。为此, 将玻璃器皿在次氯酸钠溶液 (0.1 g/L) 下存放 1 小时, 然后用去离子水彻底冲洗。

2. 在样本制备中, 通过移液和摇动来避免臭氧的排气。取样后必须立即进行分析。

3. 在分析前 (用 0.5 mol/l 硫酸或 1 mol/l 氢氧化钠溶液) 必须将强碱性或酸性水的 pH 范围调节到 6 和 7 之间。



进行测定 臭氧，样品中含氯，片剂

选择设备中的方法。

另外选择测定：有氯存在



用 10 mL 样本填充 24 mm 比色杯。

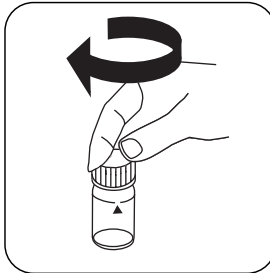

密封比色杯。

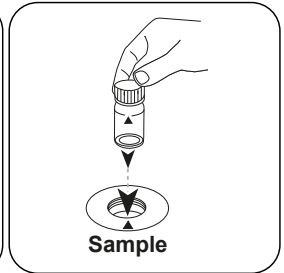

将样本比色杯放入测量轴中。注意定位。

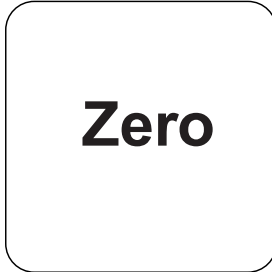

按下 ZERO 按钮。

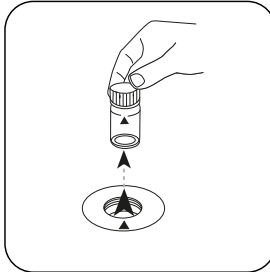

从测量轴上取下比色杯。

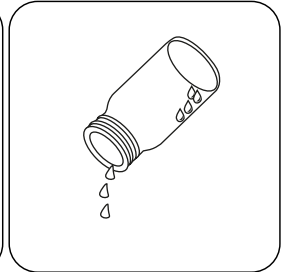

将比色杯倒空。

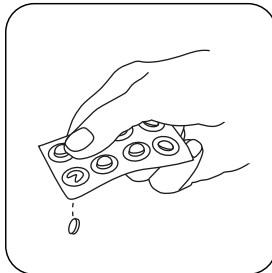

加入 DPD No. 1 片剂。

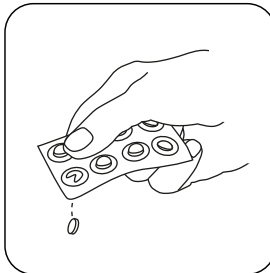

加入 DPD No. 3 片剂。

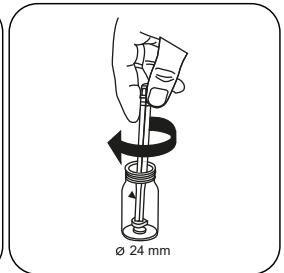

用轻微的扭转压碎片剂。



ZH



用样本将比色杯填充至
10 mL 刻度处。

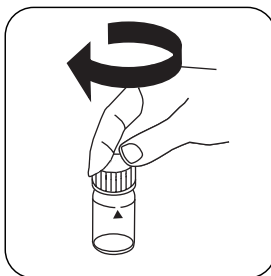

密封比色杯。

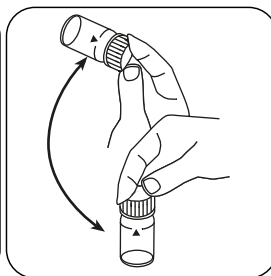

通过旋转溶解片剂。

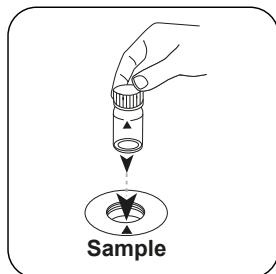

将样本比色杯放入测量轴
中。注意定位。

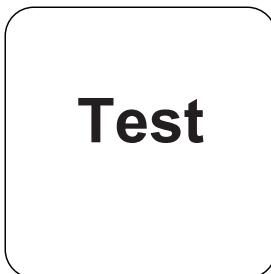

按下 **TEST (XD: START)**
按钮。

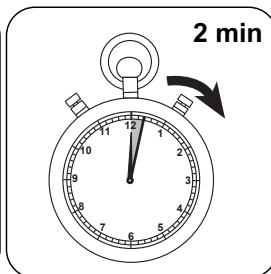

等待 **2 分钟** 反应时间。

反应时间结束后，自动进行测量。

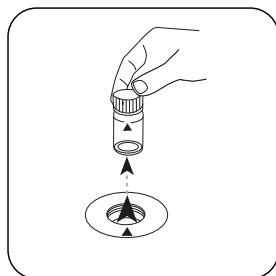

从测量轴上取下比色杯。

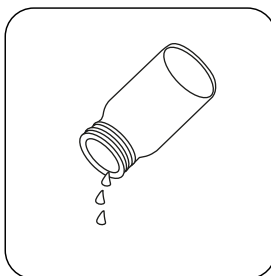

倒空比色杯。

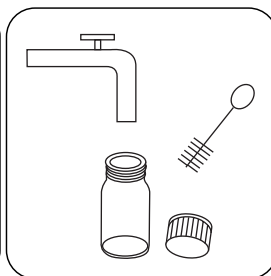

彻底清洗比色杯和比色杯杯
盖。

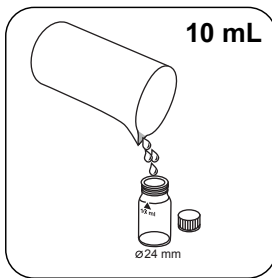

用 10 mL 样本填充第二个比色杯。

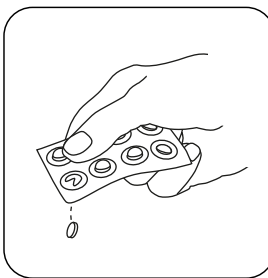

加入 GLYCINE 片剂。

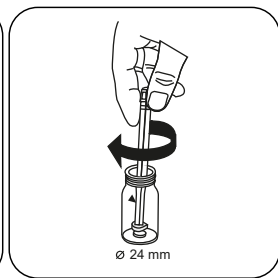

用轻微的扭转压碎片剂。

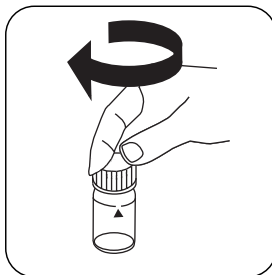

密封比色杯。

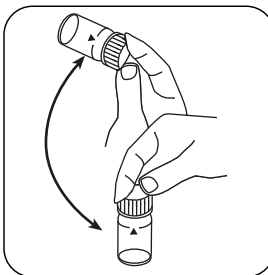

通过旋转溶解片剂。

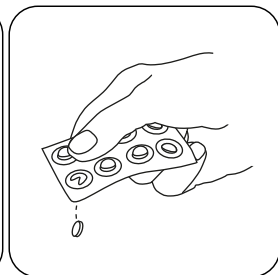

将一片 DPD No. 1 片剂和一片 DPD No. 3 片剂直接从铝箔中取出加入到第一个比色杯中。

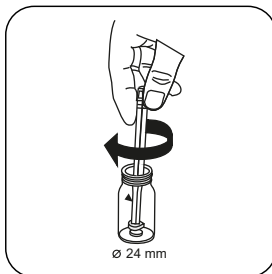

用轻微的扭转压碎片剂。

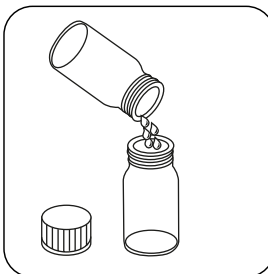

将准备好的甘氨酸加入到准备好的比色杯中。

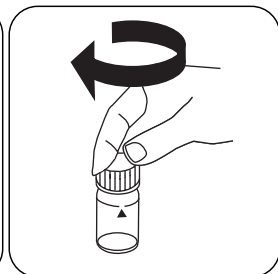

密封比色杯。



ZH

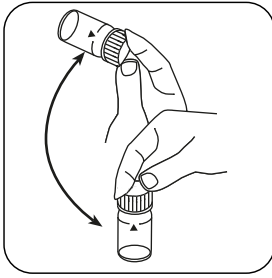

通过旋转溶解片剂。

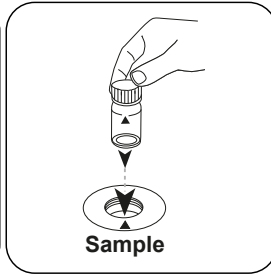

将样本比色杯放入测量轴中。注意定位。

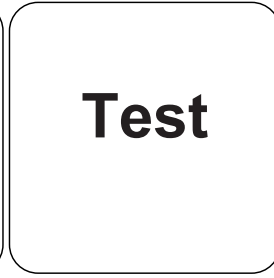

按下 **TEST (XD: START)** 按钮。

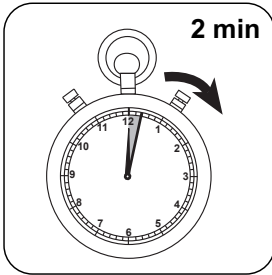

等待 2 分钟反应时间。

反应时间结束后，自动进行测量。

结果在显示屏上显示为 mg/l 臭氧；mg/l 总氯。

进行测定 臭氧，样品中不含氯，片剂

选择设备中的方法。

另外选择测定：不含氯



用 10 mL 样本填充 24 mm 比色杯。

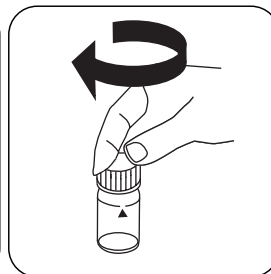

密封比色杯。

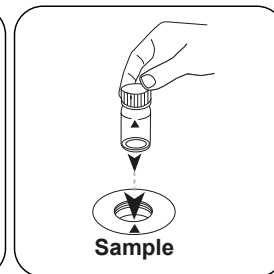

将样本比色杯放入测量轴中。注意定位。

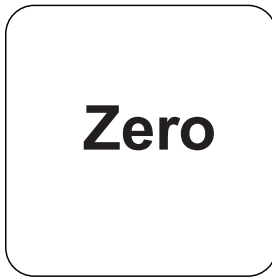

按下 **ZERO** 按钮。

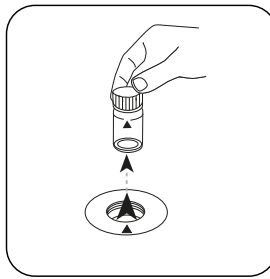

从测量轴上取下比色杯。



将比色杯倒空。

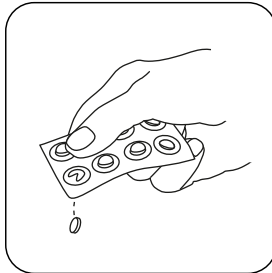

加入 **DPD No. 1** 片剂。

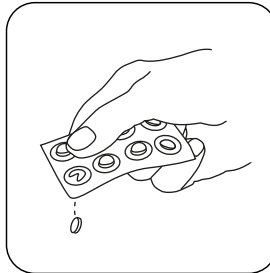

加入 **DPD No. 3** 片剂。

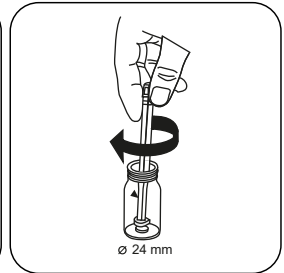

用轻微的扭转压碎片剂。

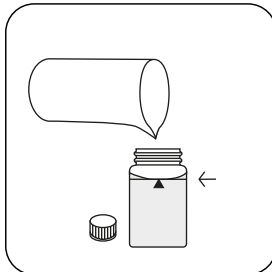

用样本将比色杯填充至
10 mL 刻度处。

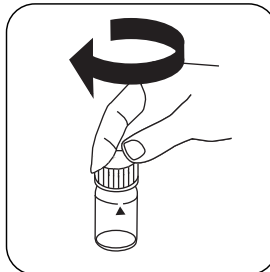

密封比色杯。

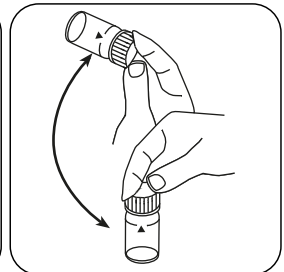

通过旋转溶解片剂。

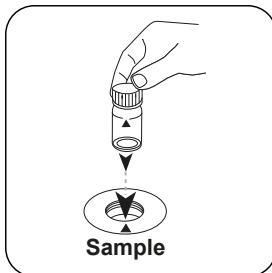

将样本比色杯放入测量轴
中。注意定位。

反应时间结束后，自动进行测量。

结果在显示屏上显示为 **mg / l 臭氧**。

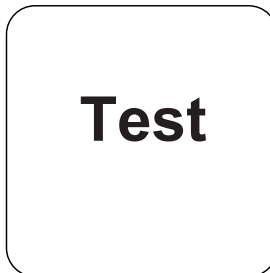

按下 **TEST (XD: START)** 按
钮。

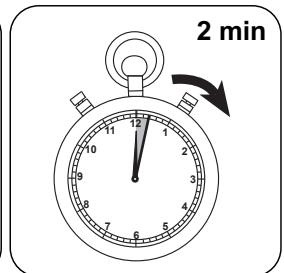

等待 **2 分钟** 反应时间。



分析

下表中输出数据也可转换为其他格式表示.

单位	参考表格	因素
mg/l	O ₃	1
mg/l	Cl ₂	1.4771

ZH

化学方法

DPD / 甘氨酸

附录

干扰说明

持续干扰

1. 存在于样本中的所有氧化剂都像氯一样反应，导致多重结果。
2. 高于 6 mg/L 臭氧的浓度可导致测量范围内的结果高达 0 mg/L。在这种情况下应稀释水样。将 10 ml 稀释的样本与试剂混合并重复测量（可置信度测试）。

参考文献

Colorimetric Chemical Analytical Methods, 9th Edition, Lovibond

源于

DIN 38408-3:2011-04

⁹ 替代试剂，取代DPD No.1/No.3试剂，用于由高浓度钙离子和/或高电导率引起的浑浊水样分析 | ⁹ 附加试剂，用于含氯水样，进行溴，二氧化氯和臭氧的测定分析 | ⁹ i含搅拌棒，10cm

Tintometer GmbH

Lovibond® Water Testing
Schleefstraße 8-12
44287 Dortmund
Tel.: +49 (0)231/94510-0
sales@lovibond.com
www.lovibond.com
Germany

Tintometer South East Asia

Unit B-3-12, BBT One Boulevard,
Lebuh Nilam 2, Bandar Bukit Tinggi,
Klang, 41200, Selangor D.E
Tel.: +60 (0)3 3325 2285/6
Fax: +60 (0)3 3325 2287
lovibond.asia@tintometer.com
www.lovibond.com
Malaysia

Tintometer India Pvt. Ltd.

Door No: 7-2-C-14, 2nd, 3rd & 4th Floor
Sanathnagar Industrial Estate,
Hyderabad, 500018
Telangana
Tel: +91 (0) 40 23883300
Toll Free: 1 800 599 3891/ 3892
indiaoffice@lovibond.in
www.lovibondwater.in
India

The Tintometer Limited

Lovibond House
Sun Rise Way
Amesbury, SP4 7GR
Tel.: +44 (0)1980 664800
Fax: +44 (0)1980 625412
sales@lovibond.uk
www.lovibond.com
UK

Tintometer Brazil

Caixa Postal: 271
CEP: 13201-970
Jundiaí – SP
Tel.: +55 (11) 3230-6410
sales@lovibond.us
www.lovibond.com.br
Brazil

Tintometer Spain

Postbox: 24047
08080 Barcelona
Tel.: +34 661 606 770
sales@tintometer.es
www.lovibond.com
Spain

Tintometer China

9F, SOHO II C.
No.9 Guanghualu,
Chaoyang District,
Beijing, 100020
Customer Care China Tel.: 4009021628
Tel.: +86 10 85251111 Ext. 330
Fax: +86 10 85251001
chinaoffice@tintometer.com
www.lovibond.com
China

Tintometer Inc.

6456 Parkland Drive
Sarasota, FL 34243
Tel: 941.756.6410
Fax: 941.727.9654
sales@lovibond.us
www.lovibond.us
USA



Technical changes without notice
Printed in Germany 09/24

No.: 00386460

Lovibond® and Tintometer® are Trademarks of
the Tintometer Group of Companies

