

# Lovibond® Water Testing

Tintometer® Group



## Manual of Methods

MD50 • MD150

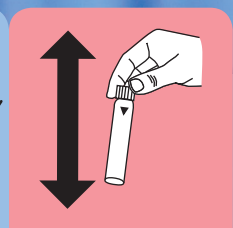



KS4.3 T / 20

Method name

Method number

Bar code for the detection of the methods

Measuring range

20

S:4.3

Chemical Method

Display in the MD 100 / MD 110 / MD 200

**Instrument specific information**

The test can be performed on the following devices. In addition, the required cuvette and the absorption range of the photometer are indicated.

Instrument Type	Cuvette	λ	Measuring Range
MD 200, MD 600, MD 610, MD 640, MultiDirect, PM 620, PM 630	ø 24 mm	610 nm	0.1 - 4 mmol/l $K_{S4.3}$
SpectroDirect, XD 7000, XD 7500	ø 24 mm	615 nm	0.1 - 4 mmol/l $K_{S4.3}$

**Material**

Required material (partly optional):

Reagents	Packaging Unit	Part Number
Alka-M-Photometer	Tablet / 100	513210BT
Alka-M-Photometer	Tablet / 250	513211BT

**Application List**

- Waste Water Treatment
- Drinking Water Treatment
- Raw Water Treatment

**Notes**

1. The terms Alkalinity-m, m-Value, total alkalinity and Acid demand to  $K_{S4.3}$  are identical.
2. For accurate results, exactly 10 ml of water sample must be used for the test.

Language codes ISO 639-1

Revision status

EN Handbook of Methods 01/20

Performing test procedure

### Implementation of the provision Acid capacity $K_{S4.3}$ with Tablet

Select the method on the device

For this method, no ZERO measurements are to be carried out with the following devices: XD 7000, XD 7500



Fill 24 mm vial with **10 ml sample**.

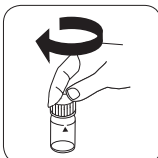

Close vial(s).



Place **sample vial** in the sample chamber. • Pay attention to the positioning.

• • •



Dissolve tablet(s) by inverting.

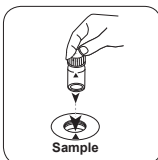

Place **sample vial** in the sample chamber. • Pay attention to the positioning.



Press the **TEST (XD: START)** button.

The result in Acid Capacity  $K_{S4.3}$  appears on the display.

**Chlorine T****M100****0.01 - 6.0 mg/L Cl<sub>2</sub> <sup>a)</sup>****CL6****DPD****Material**

EN

Required material (partly optional):

<b>Reagents</b>	<b>Packaging Unit</b>	<b>Part Number</b>
DPD No.1	Tablet / 100	511050BT
DPD No. 1	Tablet / 250	511051BT
DPD No. 1	Tablet / 500	511052BT
DPD No. 3	Tablet / 100	511080BT
DPD No. 3	Tablet / 250	511081BT
DPD No. 3	Tablet / 500	511082BT
DPD No. 1 High Calcium <sup>e)</sup>	Tablet / 100	515740BT
DPD No. 1 High Calcium <sup>e)</sup>	Tablet / 250	515741BT
DPD No. 1 High Calcium <sup>e)</sup>	Tablet / 500	515742BT
DPD No. 3 High Calcium <sup>e)</sup>	Tablet / 100	515730BT
DPD No. 3 High Calcium <sup>e)</sup>	Tablet / 250	515731BT
DPD No. 3 High Calcium <sup>e)</sup>	Tablet / 500	515732BT
DPD No. 4	Tablet / 100	511220BT
DPD No. 4	Tablet / 250	511221BT
DPD No. 4	Tablet / 500	511222BT
DPD No. 3 Evo	Tablet / 100	511420BT
DPD No. 3 Evo	Tablet / 250	511421BT
DPD No. 3 Evo	Tablet / 500	511422BT
DPD No. 4 Evo	Tablet / 100	511970BT
DPD No. 4 Evo	Tablet / 250	511971BT
DPD No. 4 Evo	Tablet / 500	511972BT

**Available Standards**

<b>Title</b>	<b>Packaging Unit</b>	<b>Part Number</b>
ValidCheck Chlorine 1,5 mg/l	1 pc.	48105510



## Sampling

1. When preparing the sample, chlorine outgassing, e.g. through the pipette or shaking, must be avoided.
2. The analysis must take place immediately after taking the sample.

## Preparation

1. Cleaning of vials:  
As many household cleaners (e.g. dishwasher detergent) contain reducing substances, this can lead to lower results with the determination of chlorine. To avoid measurement errors, the glassware used should be free of chlorine consumption. To achieve this, all glassware should be placed in a sodium hypochlorite solution (0.1 g/L) for one hour and then rinsed thoroughly with deionised water.
2. For individual testing of free and total chlorine, the use of different sets of glassware is recommended (EN ISO 7393-2, 5.3)
3. The DPD colour development is carried out at a pH value of 6.2 to 6.5. The reagents therefore contain a buffer for the pH adjustment. Strong alkaline or acidic water samples must therefore be adjusted between pH 6 and pH 7 before the analysis (use 0.5 mol/L sulphuric acid or 1 mol/L sodium hydroxide).

## Notes

1. Evo tablets can be used as an alternative to the corresponding standard tablet (e.g. DPD No.3 Evo instead of DPD No.3).



## Determination of free chlorine with tablet

Select the method on the device.

In addition, choose the test: free

For this method, a ZERO measurement does not have to be carried out every time on the following devices: XD 7000, XD 7500

EN



Fill 24 mm vial with **10 mL sample**.

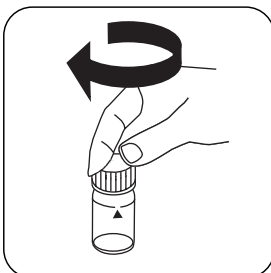

Close vial(s).

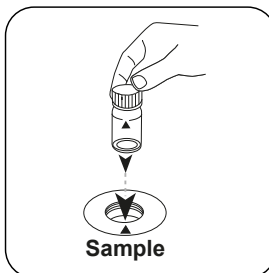

Place **sample vial** in the sample chamber. Pay attention to the positioning.

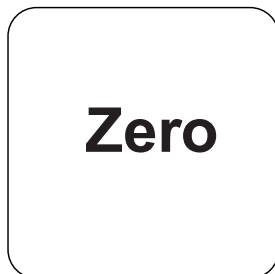

Press the **ZERO** button.

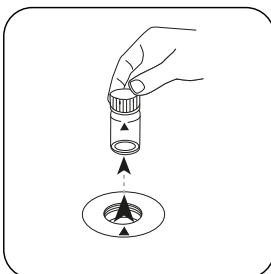

Remove the vial from the sample chamber.

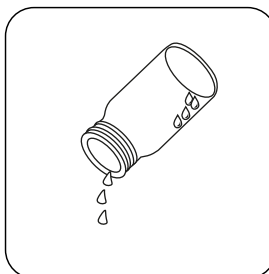

Empty vial except for a few drops.

For devices that require **no ZERO measurement**, start here.

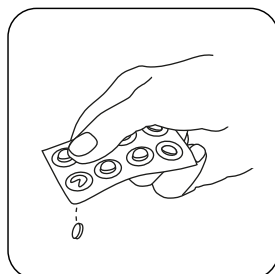

Add **DPD No. 1 tablet**.

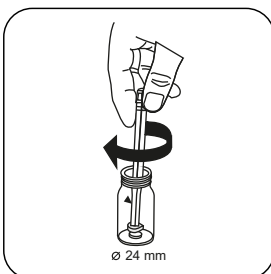

Crush tablet(s) by rotating slightly.

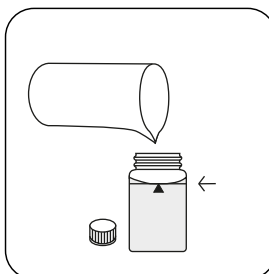

Fill up vial with **sample** to the **10 mL mark**.

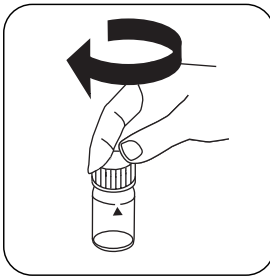

Close vial(s).



Dissolve tablet(s) by inverting.



Place **sample vial** in the sample chamber. Pay attention to the positioning.

EN

## Test

Press the **TEST** (XD: **START**) button.

The result in mg/L free chlorine appears on the display.

### Determination of total Chlorine with tablet

Select the method on the device.

In addition, choose the test: total

For this method, a ZERO measurement does not have to be carried out every time on the following devices: XD 7000, XD 7500



Fill 24 mm vial with **10 mL sample**.

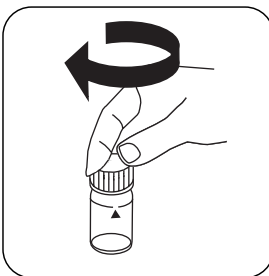

Close vial(s).

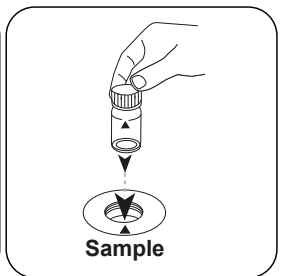

Place **sample vial** in the sample chamber. Pay attention to the positioning.





# Zero

Press the **ZERO** button.

Remove the vial from the sample chamber.

Empty vial except for a few drops.

For devices that require **no ZERO measurement**, start here.

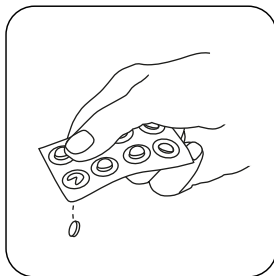

Add DPD No. 1 tablet .

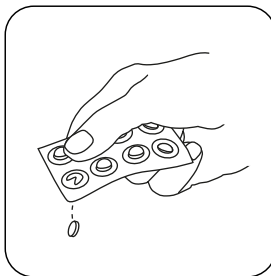

Add DPD No. 3 tablet .

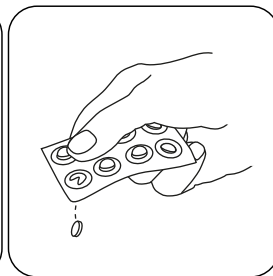

As an alternative to DPD No. 1 and No. 3 tablets, a DPD No. 4 tablet can be added.

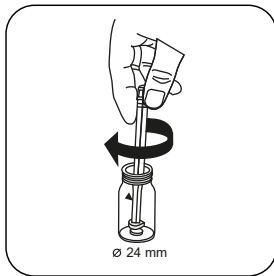

Crush tablet(s) by rotating slightly.



Fill up vial with **sample** to the **10 mL mark**.

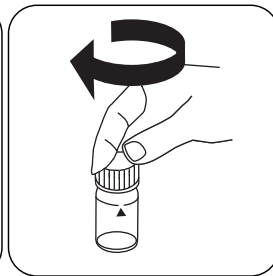

Close vial(s).

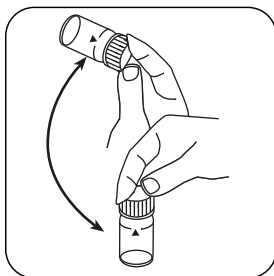

Dissolve tablet(s) by inverting.

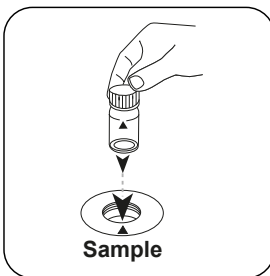

Place **sample vial** in the sample chamber. Pay attention to the positioning.

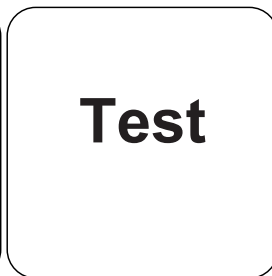

Press the **TEST** (XD: **START**) button.

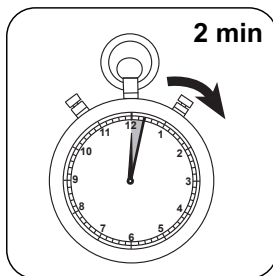

Wait for **2 minute(s) reaction time**.

Once the reaction period is finished, the measurement takes place automatically.

The result in mg/L total Chlorine appears on the display.

### Determination of Chlorine differentiated with tablet

Select the method on the device.

In addition, choose the test: differentiated

For this method, a ZERO measurement does not have to be carried out every time on the following devices: XD 7000, XD 7500



Fill 24 mm vial with **10 mL sample**.

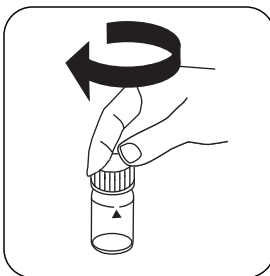

Close vial(s).

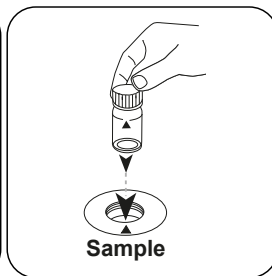

Place **sample vial** in the sample chamber. Pay attention to the positioning.



# Zero

Press the **ZERO** button.

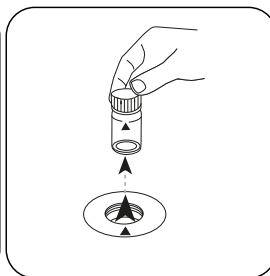

Remove the vial from the sample chamber.

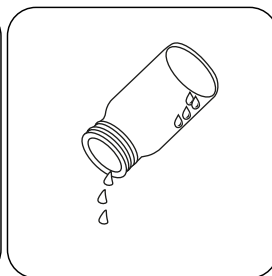

Empty vial except for a few drops.

For devices that require **no ZERO measurement**, start here.

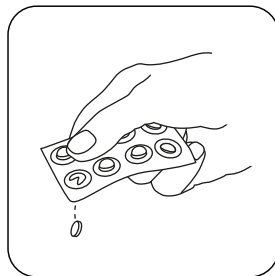

Add **DPD No. 1** tablet .

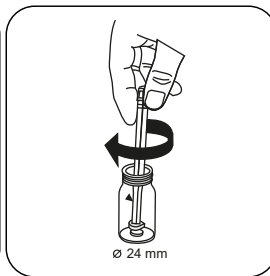

Crush tablet(s) by rotating slightly.



Fill up vial with **sample** to the **10 mL** mark.

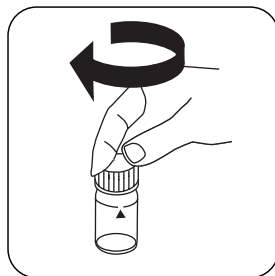

Close vial(s).

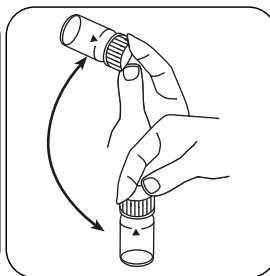

Dissolve tablet(s) by inverting.

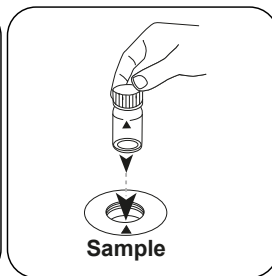

Place **sample vial** in the sample chamber. Pay attention to the positioning.

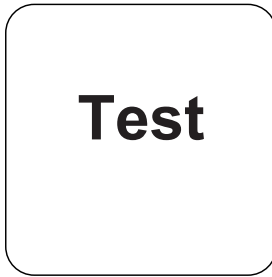

Press the **TEST** (XD:  
**START**) button.

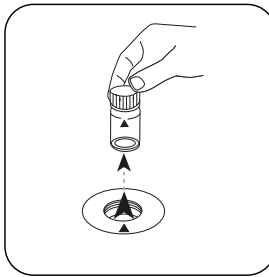

Remove the vial from the  
sample chamber.

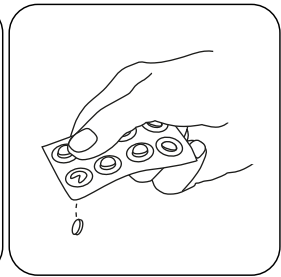

Add **DPD No. 3 tablet** .

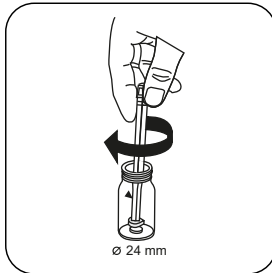

Crush tablet(s) by rotating  
slightly.

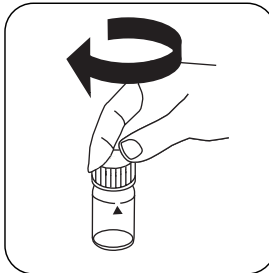

Close vial(s).

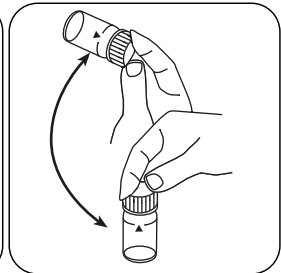

Dissolve tablet(s) by  
inverting.

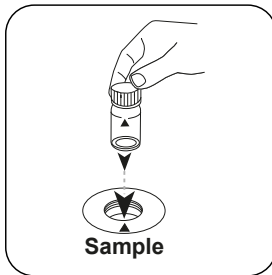

Place **sample vial** in the  
sample chamber. Pay  
attention to the positioning.

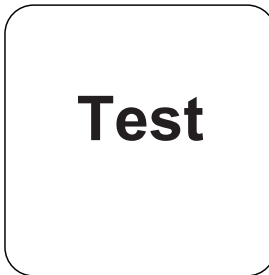

Press the **TEST** (XD:  
**START**) button.

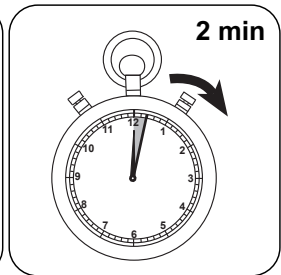

Wait for **2 minute(s)**  
**reaction time**.

Once the reaction period is finished, the measurement takes place automatically.

The result in mg/L free chlorine, mg/l combined chlorine, mg/l total chlorine appears on the display.



## Chemical Method

DPD

## Appendix

EN

### Interferences

#### Persistent Interferences

- All oxidising agents in the samples react like chlorine, which leads to higher results.

#### Removeable Interferences

- Interference from copper and iron (III) are eliminated by the addition of EDTA.
- The use of reagent tablets in samples with high calcium content\* and/or high conductivity\* can lead to turbidity of the sample and therefore incorrect measurements. In this case, the alternative reagent tablet DPD No.1 High Calcium and reagent tablet DPD No.3 High Calcium should be used.  
\*it is not possible to give exact values, because the development of turbidity depends on the composition and nature of the sample.
- Concentrations above 10 mg/L chlorine, in the event of using fluid reagents, can lead to results within the measuring range of up to 0 mg/L. In the event of a high concentration of chlorine, the sample must be diluted with chlorine-free water. 10 mL of the diluted sample should be mixed with the reagent and the measurement taken again (plausibility test).

Interference	from / [mg/L]
$\text{CrO}_4^{2-}$	0.01
$\text{MnO}_2$	0.01

### Method Validation

Limit of Detection	0.02 mg/L
Limit of Quantification	0.06 mg/L
End of Measuring Range	6 mg/L
Sensitivity	2.05 mg/L / Abs
Confidence Intervall	0.04 mg/L
Standard Deviation	0.019 mg/L
Variation Coefficient	0.87 %

#### Conformity

EN ISO 7393-2



<sup>a)</sup> determination of free, combined and total | <sup>a)</sup> alternative reagent, used instead of DPD No.1/No.3 in case of turbidity in the water sample caused by high concentration of calcium and/or high conductivity



Chlorine L

M101

0.02 - 4.0 mg/L Cl<sub>2</sub><sup>a)</sup>

CL6

DPD

## Material

EN

Required material (partly optional):

Reagents	Packaging Unit	Part Number
DPD 1 Buffer Solution, Blue Bottle	15 mL	471010
DPD 1 Buffer Solution	100 mL	471011
DPD 1 Buffer Solution	1 pc.	471016
DPD 1 Reagent Solution, Green Bottle	15 mL	471020
DPD 1 Reagent Solution	100 mL	471021
DPD 1 Reagent Solution	1 pc.	471026
DPD 3 Solution, Red Bottle	15 mL	471030
DPD 3 Solution	100 mL	471031
DPD 3 Solution	1 pc.	471036
DPD Reagent Set	1 pc.	471056

## Available Standards

Title	Packaging Unit	Part Number
ValidCheck Chlorine 1,5 mg/l	1 pc.	48105510

## Sampling

1. When preparing the sample, Chlorine outgassing, e.g. through the pipette or shaking, must be avoided.
2. The analysis must take place immediately after taking the sample.



## Preparation

1. Cleaning of vials:  
As many household cleaners (e.g. dishwasher detergent) contain reducing substances, this can lead to lower results with the determination of Chlorine. To avoid measurement errors, the glassware used should be free of chlorine consumption. To achieve this, all glassware should be placed in a sodium hypochlorite solution (0.1 g/L) for one hour and then rinsed thoroughly with deionised water.
2. For individual testing of free and total Chlorine, the use of different sets of glassware is recommended (EN ISO 7393-2, 5.3)
3. The DPD colour development is carried out at a pH value of 6.2 to 6.5. The reagents therefore contain a buffer for the pH adjustment. Strong alkaline or acidic water samples must therefore be adjusted between pH 6 and pH 7 before the analysis (use 0.5 mol/l Sulphuric acid or 1 mol/l Sodium hydroxide).

## Notes

1. After use, ensure the cuvettes are once again closed with the respective same-coloured screw caps.
2. Reagent sets are to be stored in the cool at +6 °C to +10 °C.





## Determination of free chlorine with liquid reagent

Select the method on the device.

In addition, choose the test: free

For this method, a ZERO measurement does not have to be carried out every time on the following devices: XD 7000, XD 7500

EN



Fill 24 mm vial with **10 mL sample**.

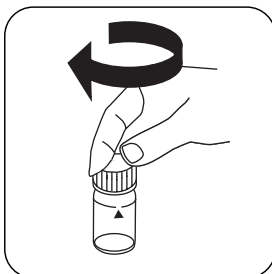

Close vial(s).

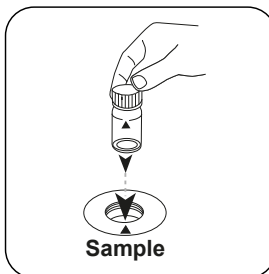

Place **sample vial** in the sample chamber. Pay attention to the positioning.

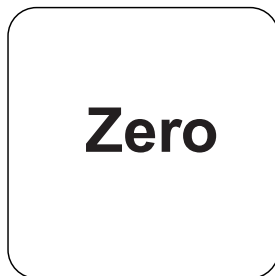

Press the **ZERO** button.

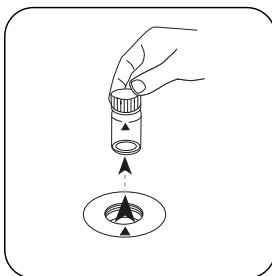

Remove the vial from the sample chamber.

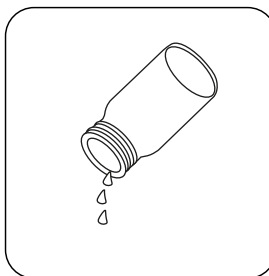

Empty vial.

For devices that require **no ZERO measurement**, start here.

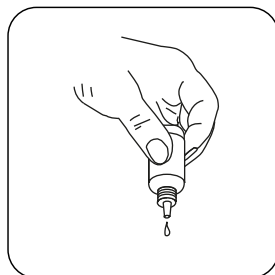

Hold cuvettes vertically and add equal drops by pressing slowly.

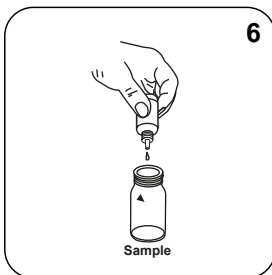

Add **6 drops DPD 1 Buffer Solution** to the **sample vial**.

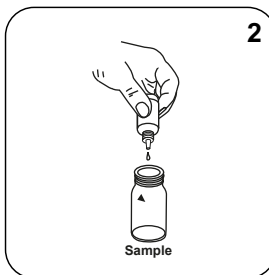

Add **2 drops DPD 1 Reagent Solution** to the **sample vial**.



Fill up vial with **sample** to the **10 mL mark**.

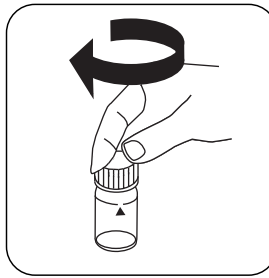

Close vial(s).

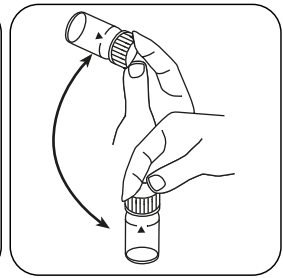

Invert several times to mix the contents.

EN

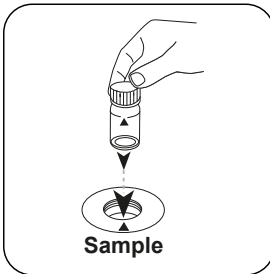

Place **sample vial** in the sample chamber. Pay attention to the positioning.

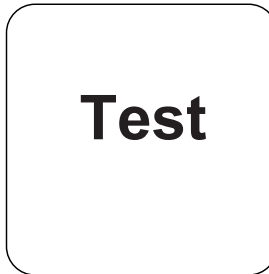

Press the **TEST (XD: START)** button.

The result in mg/L free chlorine appears on the display.

### Determination of totale Chlorine with liquid reagent

Select the method on the device.

In addition, choose the test: total

For this method, a ZERO measurement does not have to be carried out every time on the following devices: XD 7000, XD 7500



Fill 24 mm vial with **10 mL sample**.

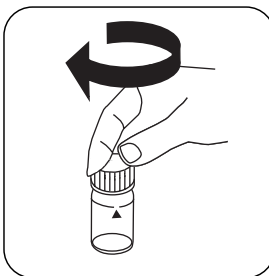

Close vial(s).

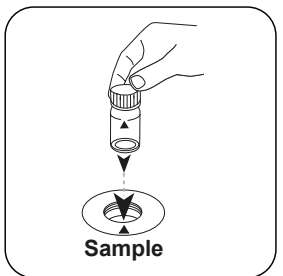

Place **sample vial** in the sample chamber. Pay attention to the positioning.



# Zero

Press the **ZERO** button.

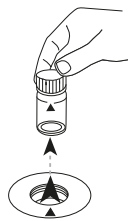

Remove the vial from the sample chamber.



Empty vial.

For devices that require **no ZERO measurement**, start here.

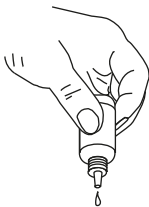

Hold cuvettes vertically and add equal drops by pressing slowly.



**6**

Add **6 drops DPD 1 Buffer Solution** to the **sample vial**.



**2**

Add **2 drops DPD 1 Reagent Solution** to the **sample vial**.



**3**

Add **3 drops DPD 3 Solution** to the **sample vial**.

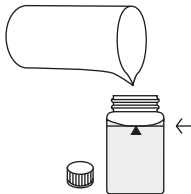

Fill up vial with **sample** to the **10 mL mark**.

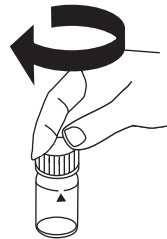

Close vial(s).

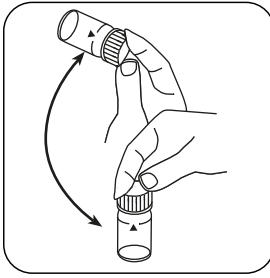

Invert several times to mix the contents.

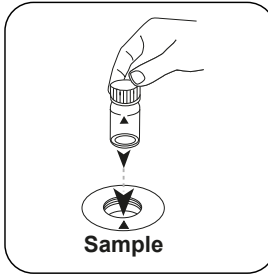

Place **sample vial** in the sample chamber. Pay attention to the positioning.

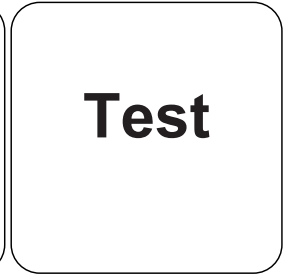

Press the **TEST (XD: START)** button.

# Test

EN

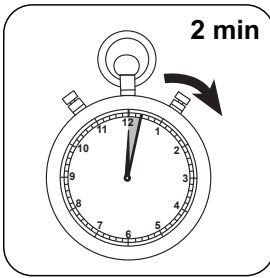

Wait for **2 minute(s) reaction time**.

Once the reaction period is finished, the measurement takes place automatically. The result in mg/L total Chlorine appears on the display.

## Determination of Chlorine differentiated with liquid reagent

Select the method on the device.

In addition, choose the test: differentiated

For this method, a ZERO measurement does not have to be carried out every time on the following devices: XD 7000, XD 7500



Fill 24 mm vial with **10 mL sample**.

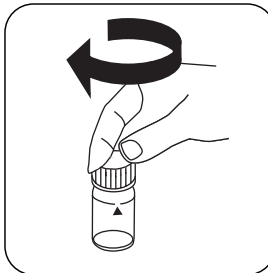

Close vial(s).

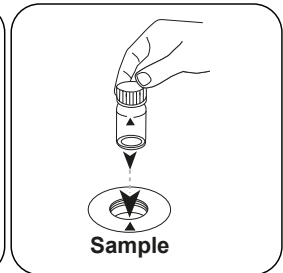

Place **sample vial** in the sample chamber. Pay attention to the positioning.



# Zero

Press the **ZERO** button.

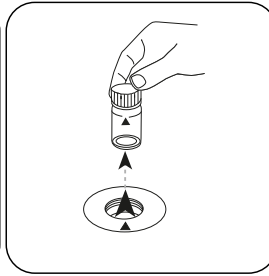

Remove the vial from the sample chamber.

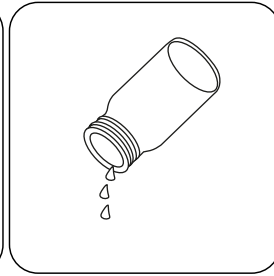

Empty vial.

For devices that require **no ZERO measurement**, start here.

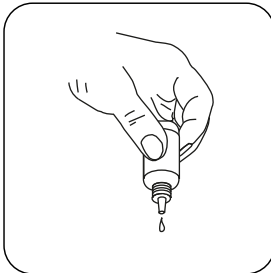

Hold cuvettes vertically and add equal drops by pressing slowly.

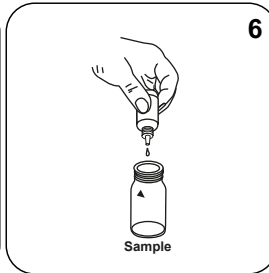

Add **6 drops DPD**  
**1 Buffer Solution** to the sample vial.

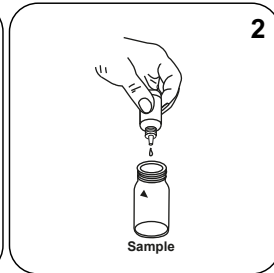

Add **2 drops DPD**  
**1 Reagent Solution** to the sample vial.



Fill up vial with **sample** to the **10 mL mark**.

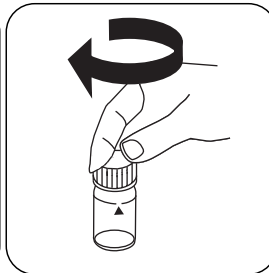

Close vial(s).

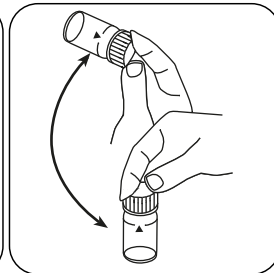

Invert several times to mix the contents.

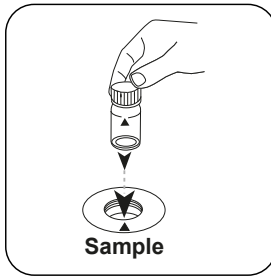

Place **sample vial** in the sample chamber. Pay attention to the positioning.



Press the **TEST (XD: START)** button.

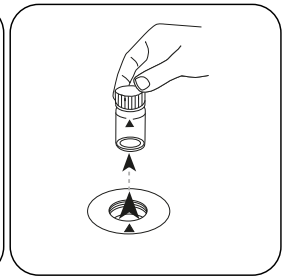

Remove the vial from the sample chamber.

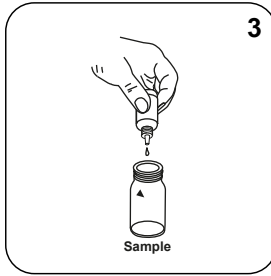

Add **3 drops DPD 3 Solution** to the **sample vial**.

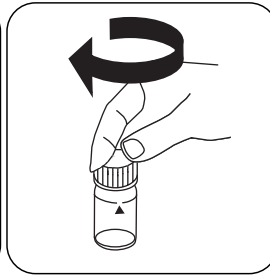

Close vial(s).

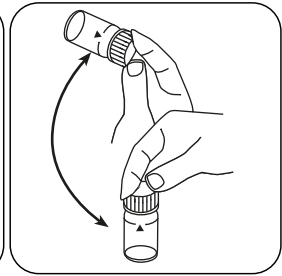

Invert several times to mix the contents.

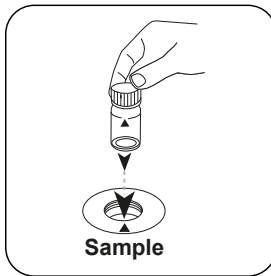

Place **sample vial** in the sample chamber. Pay attention to the positioning.

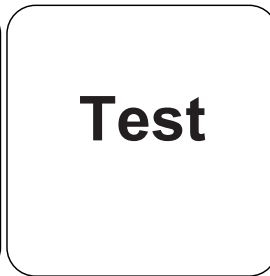

Press the **TEST (XD: START)** button.

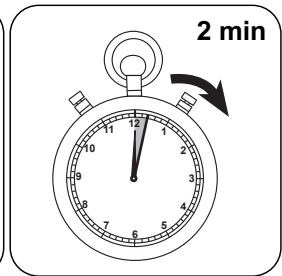

Wait for **2 minute(s) reaction time**.

Once the reaction period is finished, the measurement takes place automatically.

The result in mg/L free chlorine, mg/l gebundenes Chor, mg/l total chlorine appears on the display.



## Chemical Method

DPD

## Appendix

EN

### Interferences

#### Persistent Interferences

- All oxidising agents in the samples react like chlorine, which leads to higher results.

#### Removeable Interferences

- Interference from Copper and Iron (III) are eliminated by the addition of EDTA.
- Concentrations above 4 mg/L Chlorine, in the event of using fluid reagents, can lead to results within the measuring range of up to 0 mg/L. In this case, the sample must be diluted with chlorine-free water. 10 ml of the diluted sample should be mixed with the reagent and the measurement taken again (plausibility test).

Interference	from / [mg/L]
$\text{CrO}_4^{2-}$	0,01
$\text{MnO}_2$	0,01

#### Conformity

EN ISO 7393-2

<sup>a)</sup> determination of free, combined and total







Chlorine HR T

M103

0.1 - 10 mg/L Cl<sub>2</sub><sup>a)</sup>

CL10

DPD

## Material

EN

Required material (partly optional):

Reagents	Packaging Unit	Part Number
DPD No. 1 HR	Tablet / 100	511500BT
DPD No. 1 HR	Tablet / 250	511501BT
DPD No. 1 HR	Tablet / 500	511502BT
DPD No.3 HR Evo	Tablet / 100	511920BT
DPD No. 3 HREvo	Tablet / 250	511921BT
DPD No. 3 HREvo	Tablet / 500	511922BT
DPD No. 3 HR	Tablet / 100	511590BT
DPD No. 3 HR	Tablet / 250	511591BT
DPD No. 3 HR	Tablet / 500	511592BT
Set DPD No. 1 HR/No. 3 HR 100 Pc. #	100 each	517791BT
Set DPD No. 1 HR/No. 3 HR 250 Pc. #	250 each	517792BT
DPD No. 1 High Calcium <sup>e)</sup>	Tablet / 100	515740BT
DPD No. 1 High Calcium <sup>e)</sup>	Tablet / 250	515741BT
DPD No. 1 High Calcium <sup>e)</sup>	Tablet / 500	515742BT
DPD No. 3 High Calcium <sup>e)</sup>	Tablet / 100	515730BT
DPD No. 3 High Calcium <sup>e)</sup>	Tablet / 250	515731BT
DPD No. 3 High Calcium <sup>e)</sup>	Tablet / 500	515732BT

## Sampling

1. When preparing the sample, chlorine outgassing, e.g. through the pipette or shaking, must be avoided.
2. The analysis must take place immediately after taking the sample.



## Preparation

1. Cleaning of vials:  
As many household cleaners (e.g. dishwasher detergent) contain reducing substances, this can lead to lower results with the determination of chlorine. To avoid measurement errors, the glassware used should be free of chlorine consumption. To achieve this, all glassware should be placed in a sodium hypochlorite solution (0.1 g/L) for one hour and then rinsed thoroughly with deionised water.
2. For individual testing of free and total chlorine, the use of different sets of glassware is recommended (EN ISO 7393-2, 5.3)
3. The DPD colour development is carried out at a pH value of 6.2 to 6.5. The reagents therefore contain a buffer for the pH adjustment. Strong alkaline or acidic water samples must therefore be adjusted between pH 6 and pH 7 before the analysis (use 0.5 mol/L sulphuric acid or 1 mol/L sodium hydroxide).

EN

## Notes

1. Evo tablets can be used as an alternative to the corresponding standard tablet (e.g. DPD No.3 Evo instead of DPD No.3).



## Determination of free chlorine HR with tablet

Select the method on the device.

In addition, choose the test: free

For this method, a ZERO measurement does not have to be carried out every time on the following devices: XD 7000, XD 7500

EN

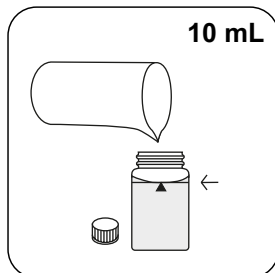

Fill 24 mm vial with **10 mL sample**.

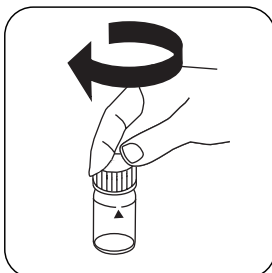

Close vial(s).

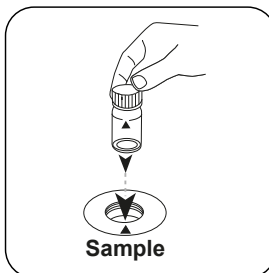

Place **sample vial** in the sample chamber. Pay attention to the positioning.

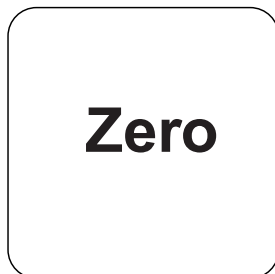

Press the **ZERO** button.

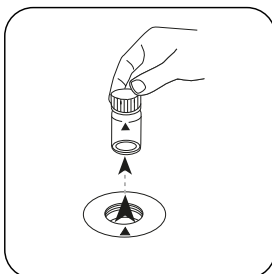

Remove the vial from the sample chamber.

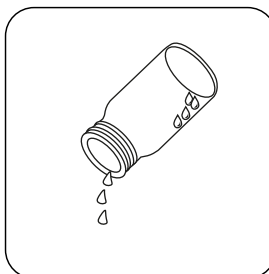

Empty vial except for a few drops.

For devices that require **no ZERO measurement**, **start here**.

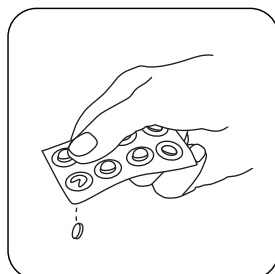

Add **DPD No. 1 HR tablet**.

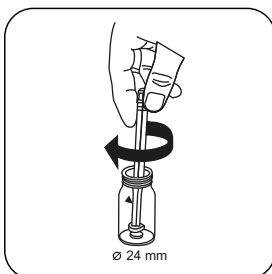

Crush tablet(s) by rotating slightly.



Fill up vial with **sample** to the **10 mL mark**.



Close vial(s).



Dissolve tablet(s) by inverting.



Place **sample vial** in the sample chamber. Pay attention to the positioning.

EN

## Test

Press the **TEST** (XD: **START**) button.

The result in mg/L free chlorine appears on the display.

### Determination of total Chlorine HR with tablet

Select the method on the device.

In addition, choose the test: total

For this method, a ZERO measurement does not have to be carried out every time on the following devices: XD 7000, XD 7500



Fill 24 mm vial with **10 mL** sample. Close vial(s).

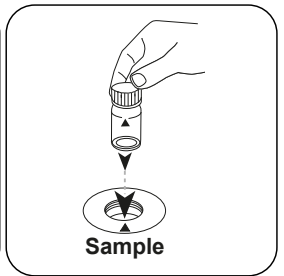
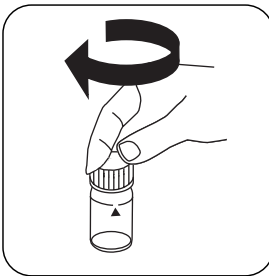

Place **sample vial** in the sample chamber. Pay attention to the positioning.



# Zero

Press the **ZERO** button.

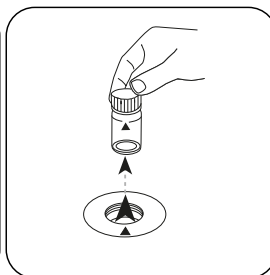

Remove the vial from the sample chamber.

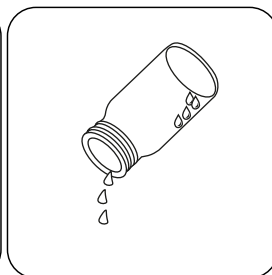

Empty vial except for a few drops.

For devices that require **no ZERO measurement**, start here.

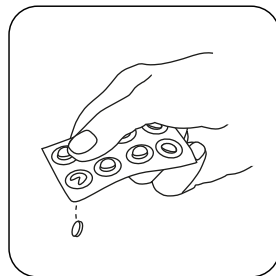

Add **DPD No. 1 HR tablet**.

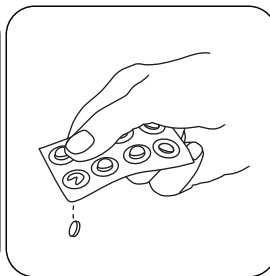

Add **DPD No. 3 HR tablet**.

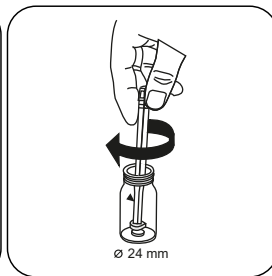

Crush tablet(s) by rotating slightly.



Fill up vial with **sample** to the **10 mL mark**.

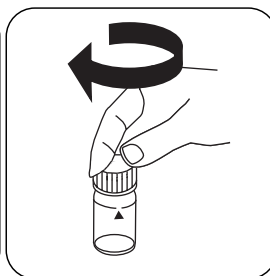

Close vial(s).

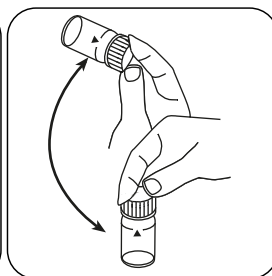

Dissolve tablet(s) by inverting.

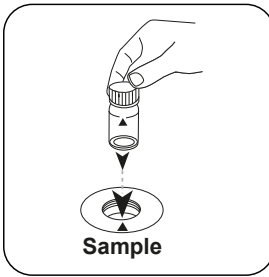

Place **sample vial** in the sample chamber. Pay attention to the positioning.

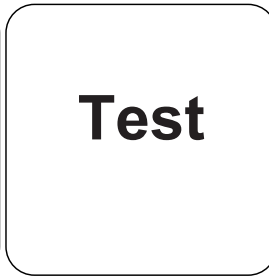

Press the **TEST** (XD: **START**) button.

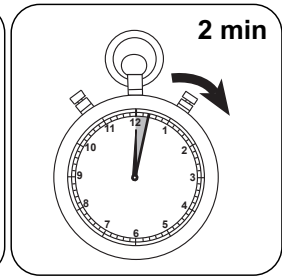

Wait for **2 minute(s) reaction time**.

Once the reaction period is finished, the measurement takes place automatically.

The result in mg/L total Chlorine appears on the display.

### Determination of Chlorine HR differentiated with tablet

Select the method on the device.

In addition, choose the test: differentiated

For this method, a ZERO measurement does not have to be carried out every time on the following devices: XD 7000, XD 7500



Fill 24 mm vial with **10 mL sample**.

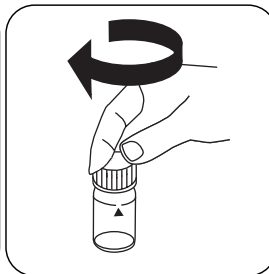

Close vial(s).

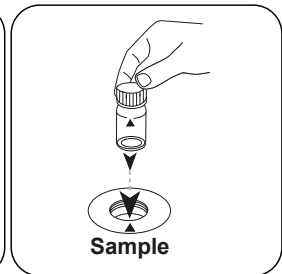

Place **sample vial** in the sample chamber. Pay attention to the positioning.

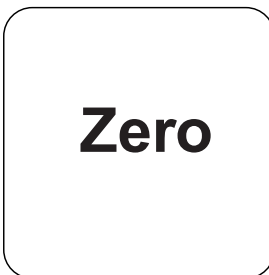

Press the **ZERO** button.

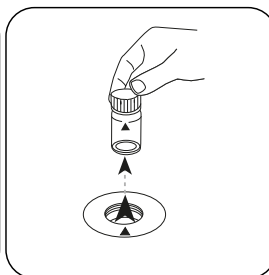

Remove the vial from the sample chamber.

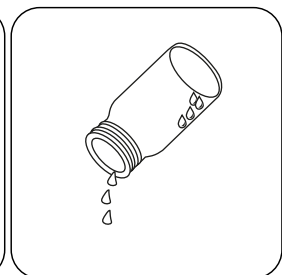

Empty vial except for a few drops.

For devices that require **no ZERO measurement**, start here.

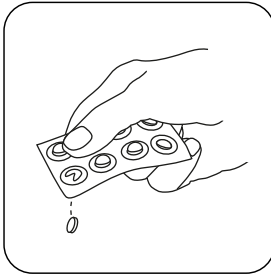

Add **DPD No. 1 HR tablet**.

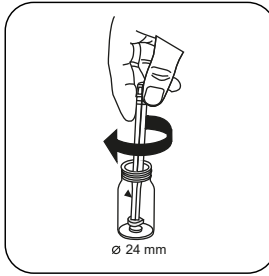

Crush tablet(s) by rotating slightly.

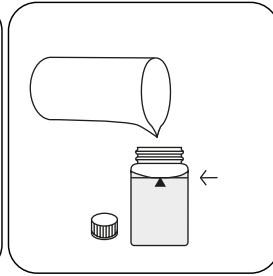

Fill up vial with **sample** to the **10 mL mark**.

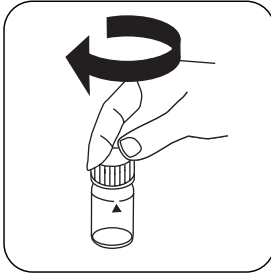

Close vial(s).

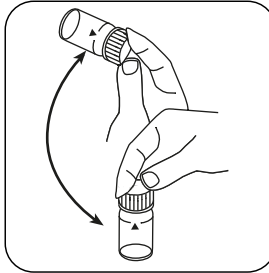

Dissolve tablet(s) by inverting.

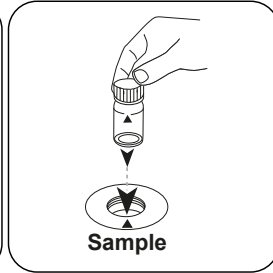

Place **sample vial** in the sample chamber. Pay attention to the positioning.

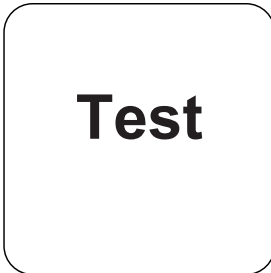

Press the **TEST (XD: START)** button.

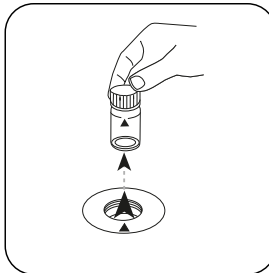

Remove the vial from the sample chamber.

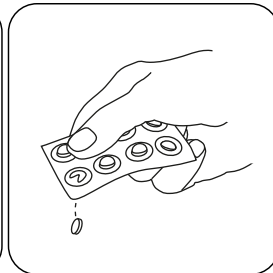

Add **DPD No. 3 HR tablet**.

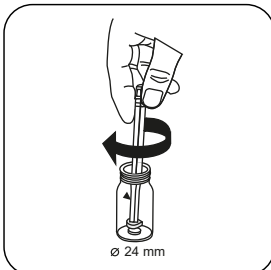

Crush tablet(s) by rotating slightly.

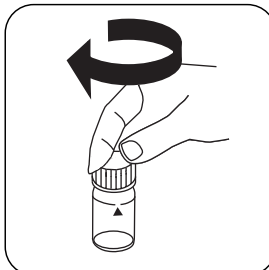

Close vial(s).

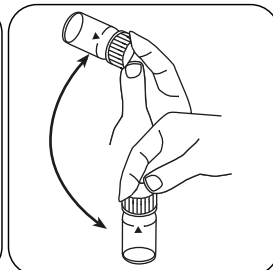

Dissolve tablet(s) by inverting.

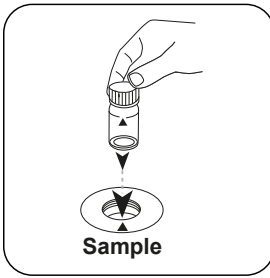

Place **sample vial** in the sample chamber. Pay attention to the positioning.

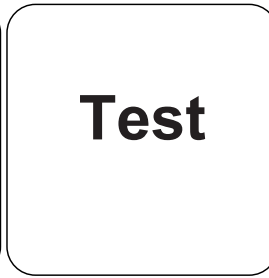

Press the **TEST** (XD: **START**) button.

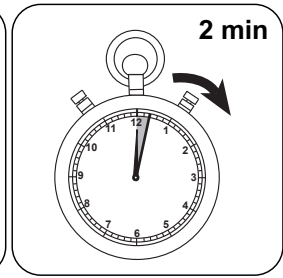

Wait for **2 minute(s)** reaction time.

Once the reaction period is finished, the measurement takes place automatically.

The result in mg/L free chlorine, mg/l combined chlorine, mg/l total chlorine appears on the display.





## Chemical Method

DPD

## Appendix

EN

### Interferences

#### Persistent Interferences

- All oxidising agents in the samples react like chlorine, which leads to higher results.

#### Removeable Interferences

- Interference from Copper and Iron (III) are eliminated by the addition of EDTA.
- The use of reagent tablets in samples with high Calcium content\* and/or high conductivity\* can lead to turbidity of the sample and therefore incorrect measurements. In this case, the alternative reagent tablet DPD No. 1 High Calcium and reagent tablet DPD No. 3 High Calcium should be used.  
\*it is not possible to give exact values, because the development of turbidity depends on the composition and nature of the sample.

#### Conformity

EN ISO 7393-2

<sup>a)</sup> determination of free, combined and total | <sup>a)</sup> alternative reagent, used instead of DPD No.1/No.3 in case of turbidity in the water sample caused by high concentration of calcium and/or high conductivity | \* including stirring rod, 10 cm



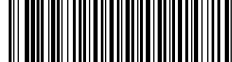

Chlorine PP

M110

0.02 - 2 mg/L Cl<sub>2</sub> <sup>a)</sup>

CL2

DPD

## Material

EN

Required material (partly optional):

Reagents	Packaging Unit	Part Number
Chlorine Free DPD F10	Powder / 100 pc.	530100
Chlorine Free DPD F10	Powder / 1000 pc.	530103
Chlorine Total DPD F10	Powder / 100 pc.	530120
Chlorine Total DPD F10	Powder / 1000 pc.	530123

## Available Standards

Title	Packaging Unit	Part Number
ValidCheck Chlorine 1,5 mg/l	1 pc.	48105510

## Sampling

1. When preparing the sample, Chlorine outgassing, e.g. through the pipette or shaking, must be avoided.
2. The analysis must take place immediately after taking the sample.

## Preparation

1. Cleaning of vials:  
As many household cleaners (e.g. dishwasher detergent) contain reducing substances, this can lead to lower results with the determination of Chlorine. To avoid measurement errors, the glassware used should be free of chlorine consumption. To achieve this, all glassware should be placed in a sodium hypochlorite solution (0.1 g/L) for one hour and then rinsed thoroughly with deionised water.
2. For individual testing of free and total Chlorine, the use of different sets of glassware is recommended (EN ISO 7393-2, 5.3)
3. The DPD colour development is carried out at a pH value of 6.2 to 6.5. The reagents therefore contain a buffer for the pH adjustment. Strong alkaline or acidic water samples must therefore be adjusted between pH 6 and pH 7 before the analysis (use 0.5 mol/l Sulphuric acid or 1 mol/l Sodium hydroxide).

## Determination of free chlorine with powder packs

Select the method on the device.

In addition, choose the test: free

For this method, a ZERO measurement does not have to be carried out every time on the following devices: XD 7000, XD 7500



Fill 24 mm vial with **10 mL sample**.

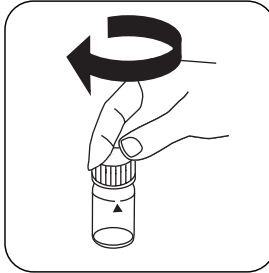

Close vial(s).

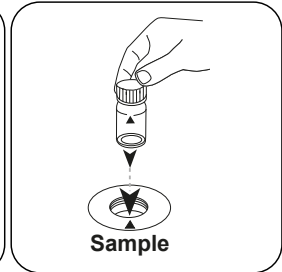

Place **sample vial** in the sample chamber. Pay attention to the positioning.

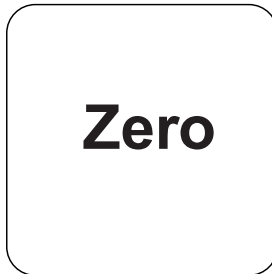

Press the **ZERO** button.

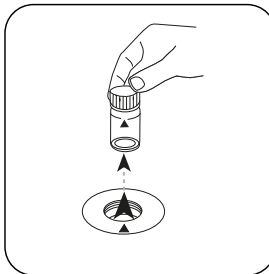

Remove the vial from the sample chamber.

For devices that require **no ZERO measurement**, start here.

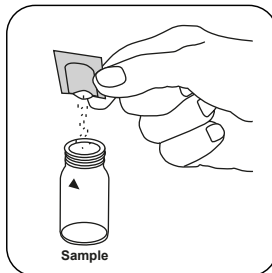

Add **Chlorine FREE-DPD/ F10 powder pack**.

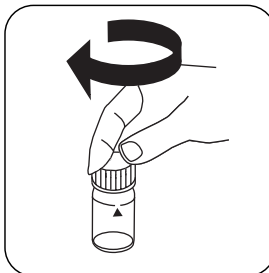

Close vial(s).

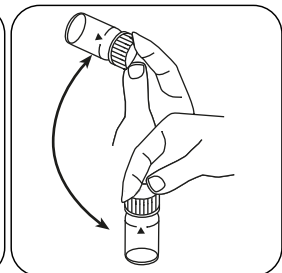

Invert several times to mix the contents (20 sec.).

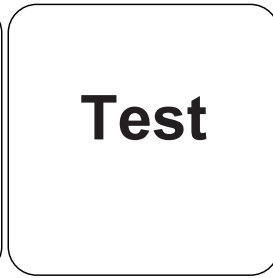
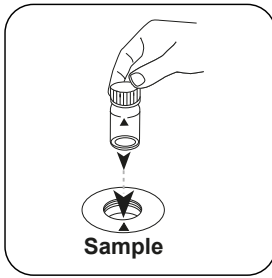

Place **sample vial** in the sample chamber. Pay attention to the positioning.

Press the **TEST** (XD: **START**) button.

The result in mg/L free chlorine appears on the display.

### Determination of totale Chlorine with powder packs

Select the method on the device.

In addition, choose the test: total

For this method, a ZERO measurement does not have to be carried out every time on the following devices: XD 7000, XD 7500



Fill 24 mm vial with **10 mL sample**.

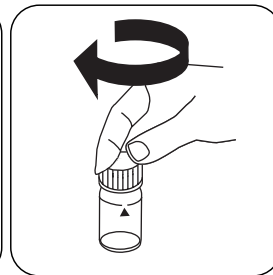

Close vial(s).

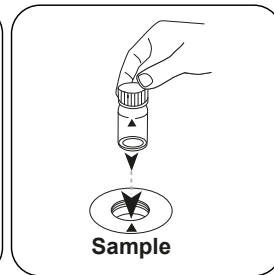

Place **sample vial** in the sample chamber. Pay attention to the positioning.

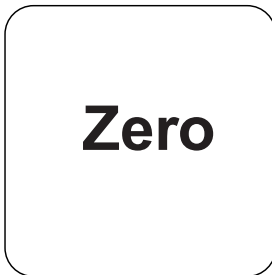

Press the **ZERO** button.

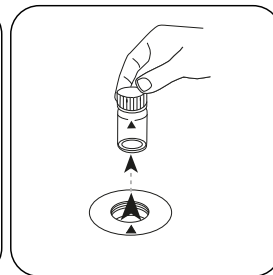

Remove the vial from the sample chamber.

For devices that require **no ZERO measurement**, **start here**.

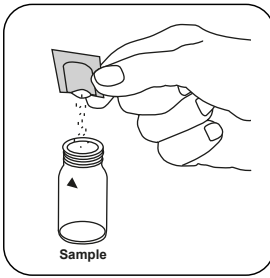

Add **Chlorine TOTAL-DPD/ F10 powder pack**.

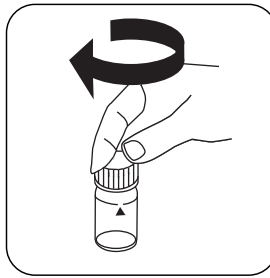

Close vial(s).

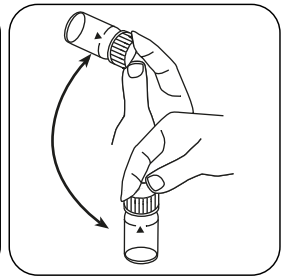

Invert several times to mix the contents (20 sec.).

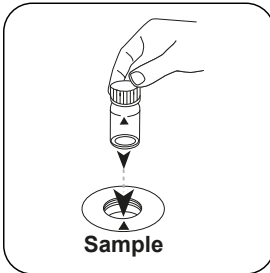

Place **sample vial** in the sample chamber. Pay attention to the positioning.

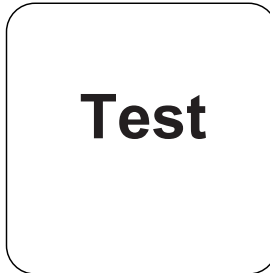

Press the **TEST (XD: START)** button.

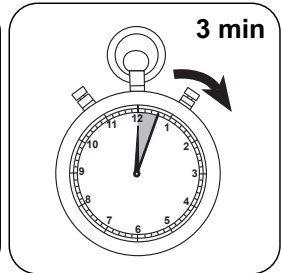

Wait for **3 minute(s) reaction time**.

Once the reaction period is finished, the measurement takes place automatically.

The result in mg/L total Chlorine appears on the display.

### Determination of Chlorine differentiated with powder packs

Select the method on the device.

In addition, choose the test: differentiated

For this method, a ZERO measurement does not have to be carried out every time on the following devices: XD 7000, XD 7500



Fill 24 mm vial with **10 mL sample**.

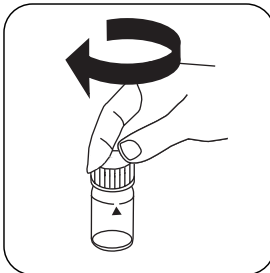

Close vial(s).

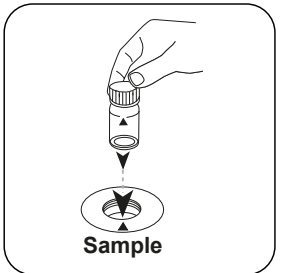

Place **sample vial** in the sample chamber. Pay attention to the positioning.



# Zero

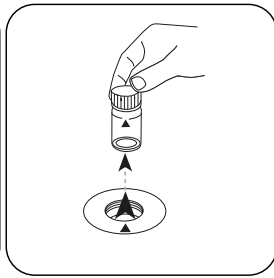

Press the **ZERO** button.

Remove the vial from the sample chamber.

For devices that require **no ZERO measurement**, start here.

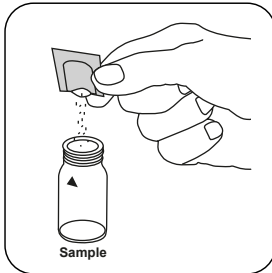

Add **Chlorine FREE-DPD/ F10 powder pack**.

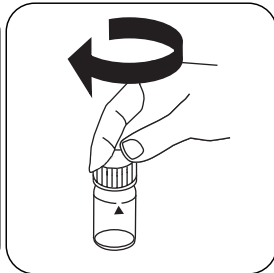

Close vial(s).

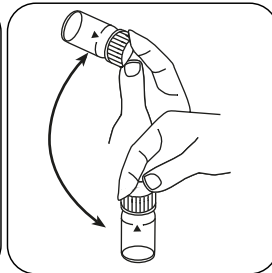

Invert several times to mix the contents (20 sec.).

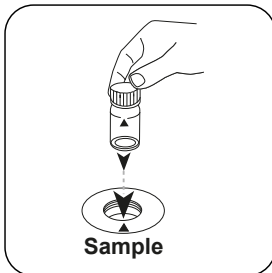

Place **sample vial** in the sample chamber. Pay attention to the positioning.

# Test

Press the **TEST (XD: START)** button.

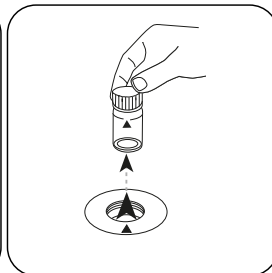

Remove the vial from the sample chamber.

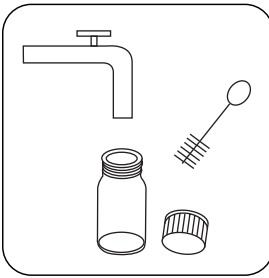

Thoroughly clean the vial and vial cap.



Fill 24 mm vial with **10 mL sample**.

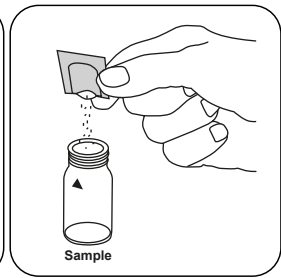

Add **TOTAL-DPD/F10 powder pack**.

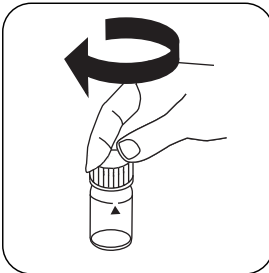

Close vial(s).

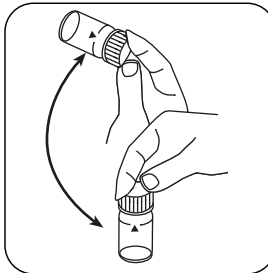

Invert several times to mix the contents (20 sec.).

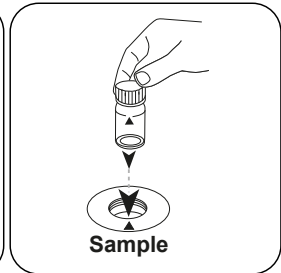

Place **sample vial** in the sample chamber. Pay attention to the positioning.

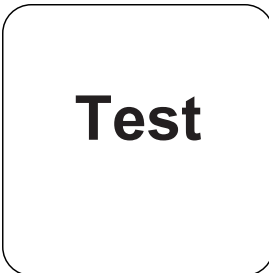

Press the **TEST** (XD: **START**) button.

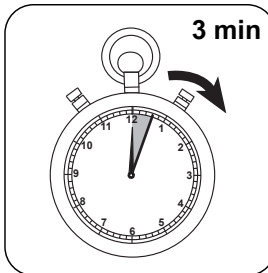

Wait for **3 minute(s) reaction time**.

Once the reaction period is finished, the measurement takes place automatically.

The result in mg/L free chlorine, mg/l combined chlorine, mg/l total chlorine appears on the display.





## Chemical Method

DPD

## Appendix

EN

### Interferences

#### Persistent Interferences

- All oxidising agents in the samples react like chlorine, which leads to higher results.

#### Removeable Interferences

- Interference from Copper and Iron (III) are eliminated by the addition of EDTA.
- Concentrations above 2 mg/L Chlorine, in the event of using Powder Packs, can lead to results within the measuring range of up to 0 mg/L. In this case, the sample must be diluted with chlorine-free water. 10 ml of the diluted sample should be mixed with the reagent and the measurement taken again (plausibility test).

Interference	from / [mg/L]
CrO <sub>4</sub> <sup>2-</sup>	0,01
MnO <sub>2</sub>	0,01

### Method Validation

Limit of Detection	0.01 mg/L
Limit of Quantification	0.03 mg/L
End of Measuring Range	2 mg/L
Sensitivity	1.68 mg/L / Abs
Confidence Intervall	0.033 mg/L
Standard Deviation	0.014 mg/L
Variation Coefficient	1.34 %

### Conformity

EN ISO 7393-2

<sup>a)</sup> determination of free, combined and total







**Tintometer GmbH**

Lovibond® Water Testing  
Schleefstraße 8-12  
44287 Dortmund  
Tel.: +49 (0)231/94510-0  
sales@lovibond.com  
www.lovibond.com  
Germany

**Tintometer South East Asia**

Unit B-3-12, BBT One Boulevard,  
Lebuh Nilam 2, Bandar Bukit Tinggi,  
Klang, 41200, Selangor D.E  
Tel.: +60 (0)3 3325 2285/6  
Fax: +60 (0)3 3325 2287  
lovibond.asia@tintometer.com  
www.lovibond.com  
Malaysia

**Tintometer India Pvt. Ltd.**

Door No: 7-2-C-14, 2<sup>nd</sup>, 3<sup>rd</sup> & 4<sup>th</sup> Floor  
Sanathnagar Industrial Estate,  
Hyderabad, 500018  
Telangana  
Tel: +91 (0) 40 23883300  
Toll Free: 1 800 599 3891/ 3892  
indiaoffice@lovibond.in  
www.lovibondwater.in  
India

**The Tintometer Limited**

Lovibond House  
Sun Rise Way  
Amesbury, SP4 7GR  
Tel.: +44 (0)1980 664800  
Fax: +44 (0)1980 625412  
sales@lovibond.uk  
www.lovibond.com  
UK

**Tintometer Brazil**

Caixa Postal: 271  
CEP: 13201-970  
Jundiaí – SP  
Tel.: +55 (11) 3230-6410  
sales@lovibond.us  
www.lovibond.com.br  
Brazil

**Tintometer Spain**

Postbox: 24047  
08080 Barcelona  
Tel.: +34 661 606 770  
sales@tintometer.es  
www.lovibond.com  
Spain

**Tintometer China**

9F, SOHO II C.  
No.9 Guanghualu,  
Chaoyang District,  
Beijing, 100020  
Customer Care China Tel.: 4009021628  
Tel.: +86 10 85251111 Ext. 330  
Fax: +86 10 85251001  
chinaoffice@tintometer.com  
www.lovibond.com  
China

**Tintometer Inc.**

6456 Parkland Drive  
Sarasota, FL 34243  
Tel: 941.756.6410  
Fax: 941.727.9654  
sales@lovibond.us  
www.lovibond.us  
USA



Technical changes without notice  
Printed in Germany 08/24

No.: 00386760

Lovibond® and Tintometer® are Trademarks of  
the Tintometer Group of Companies

