

Lovibond® Water Testing

Tintometer® Group



Manual of Methods

MD50 • MD150

Chlorine | Sodium hypochlorite

(EN) MD50 Photometer

Page 4

(ES) Fotómetro MD50

Página 24

(PT) Fotómetro MD50

Página 44

(NL) MD50 Fotometer

Zijde 64

(RU) Фотометр MD50

Страница 84

(DE) MD50 Photometer

Seite 14

(FR) MD50 Photomètre

Page 34

(IT) Fotometro MD50

Pagina 54

(TR) MD50 fotometre

Sayfa 74

(ZH) MD50 光度计

Page 94

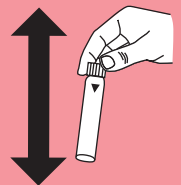
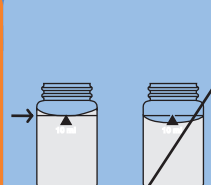
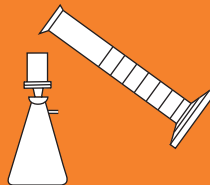

KS4.3 T / 20

Method name

Method number

Bar code for the detection of the methods

Measuring range

20

S:4.3

Chemical Method

Display in the MD 100 / MD 110 / MD 200

Instrument specific information

The test can be performed on the following devices. In addition, the required cuvette and the absorption range of the photometer are indicated.

Instrument Type	Cuvette	λ	Measuring Range
MD 200, MD 600, MD 610, MD 640, MultiDirect, PM 620, PM 630	ø 24 mm	610 nm	0.1 - 4 mmol/l $K_{S4.3}$
SpectroDirect, XD 7000, XD 7500	ø 24 mm	615 nm	0.1 - 4 mmol/l $K_{S4.3}$

Material

Required material (partly optional):

Reagents	Packaging Unit	Part Number
Alka-M-Photometer	Tablet / 100	513210BT
Alka-M-Photometer	Tablet / 250	513211BT

Application List

- Waste Water Treatment
- Drinking Water Treatment
- Raw Water Treatment

Notes

1. The terms Alkalinity-m, m-Value, total alkalinity and Acid demand to $K_{S4.3}$ are identical.
2. For accurate results, exactly 10 ml of water sample must be used for the test.

Language codes ISO 639-1

Revision status

EN Handbook of Methods 01/20

Performing test procedure

Implementation of the provision Acid capacity $K_{S4.3}$ with Tablet

Select the method on the device

For this method, no ZERO measurements are to be carried out with the following devices: XD 7000, XD 7500



Fill 24 mm vial with **10 ml sample**.



Close vial(s).

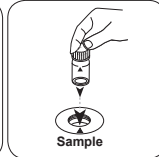

Place **sample vial** in the sample chamber. • Pay attention to the positioning.

• • •

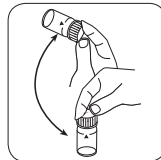

Dissolve tablet(s) by inverting.

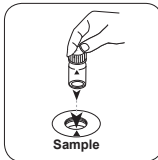

Place **sample vial** in the sample chamber. • Pay attention to the positioning.



Press the **TEST (XD: START)** button.

The result in Acid Capacity $K_{S4.3}$ appears on the display.



Chlorine HR (KI) T

M105

5 - 200 mg/L Cl₂

CLHr

KI / Acid

Material

EN

Required material (partly optional):

Reagents	Packaging Unit	Part Number
Chlorine HR (KI)	Tablet / 100	513000BT
Chlorine HR (KI)	Tablet / 250	513001BT
Acidifying GP	Tablet / 100	515480BT
Acidifying GP	Tablet / 250	515481BT
Set Chlorine HR (KI)/Acidifying GP 100 Pc. #	100 each	517721BT
Set Chlorine HR (KI)/Acidifying GP 250 Pc. #	250 each	517722BT
Chlorine HR (KI)	Tablet / 100	501210
Chlorine HR (KI)	Tablet / 250	501211

Determination of Chlorine HR (KI) with Tablet

Select the method on the device.

For this method, a ZERO measurement does not have to be carried out every time on the following devices: XD 7000, XD 7500

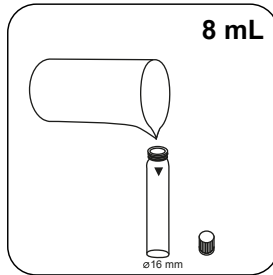

Fill 16 mm vial with **8 mL sample**.

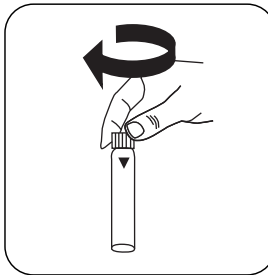

Close vial(s).

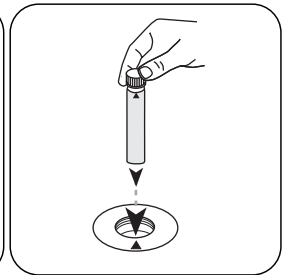

Place **sample vial** in the sample chamber. • Pay attention to the positioning.

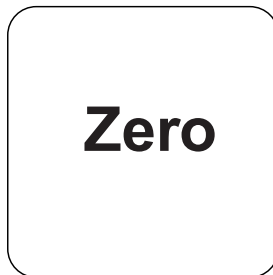

Press the **ZERO** button.

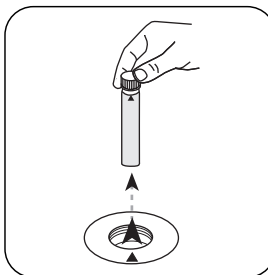

Remove **vial** from the sample chamber.

For devices that require **no ZERO measurement**, start here.

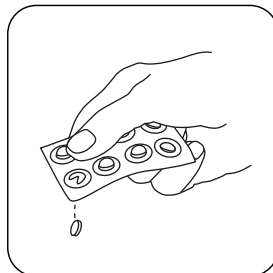

Add **Chlorine HR (KI) tablet**.

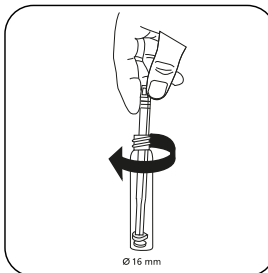

Crush tablet(s) by rotating slightly.

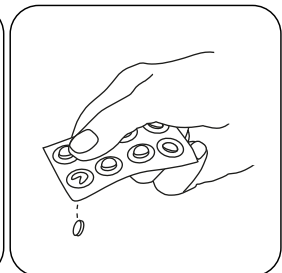

Add **ACIDIFYING GP tablet**.

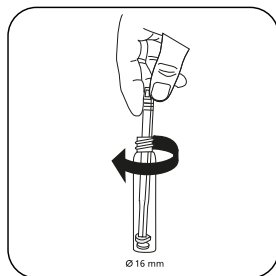

Crush tablet(s) by rotating slightly.

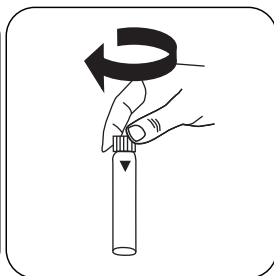

Close vial(s).

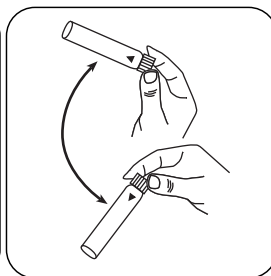

Dissolve tablet(s) by inverting.

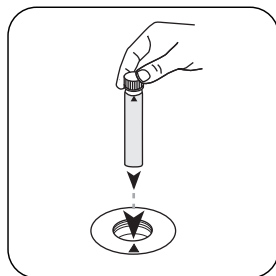

Place **sample vial** in the sample chamber. • Pay attention to the positioning.

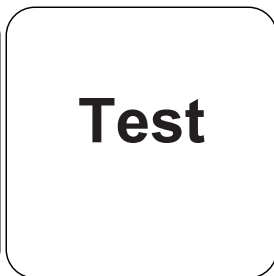

Press the **TEST** (XD: **START**) button.

The result in mg/L Chlorine appears on the display.

Chemical Method

KI / Acid

Appendix

Interferences

Persistent Interferences

- All oxidising agents in the samples react like chlorine, which leads to higher results.

Method Validation

Limit of Detection	1.29 mg/L
Limit of Quantification	3.86 mg/L
End of Measuring Range	200 mg/L
Sensitivity	83.96 mg/L / Abs
Confidence Intervall	1.14 mg/L
Standard Deviation	0.45 mg/L
Variation Coefficient	0.45 %

Derived from

EN ISO 7393-3

* including stirring rod, 10 cm

EN

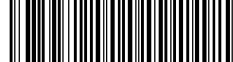

Hypochlorite T

M212

0.2 - 16 % NaOCI

Potassium Iodide

EN

Material

Required material (partly optional):

Reagents	Packaging Unit	Part Number
Acidifying GP	Tablet / 100	515480BT
Acidifying GP	Tablet / 250	515481BT
Chlorine HR (KI)	Tablet / 100	513000BT
Chlorine HR (KI)	Tablet / 250	513001BT
Chlorine HR (KI)	Tablet / 100	501210
Chlorine HR (KI)	Tablet / 250	501211
Set Chlorine HR (KI)/Acidifying GP 100 Pc. #	100 each	517721BT
Set Chlorine HR (KI)/Acidifying GP 250 Pc. #	250 each	517722BT
Dilution set sodium hypochlorite	1 pc.	414470

Notes

1. This method provides a fast and simple test. The test can be performed on site but the result will not be as precise as a laboratory method.
2. By strictly following the test procedure, an accuracy of +/- 1 weight % can be achieved.

Determination of Sodium hypochlorite with Tablet

Select the method on the device.

For this method, a ZERO measurement does not have to be carried out every time on the following devices: XD 7000, XD 7500

The sample is diluted x2000.

1. First rinse a 5 mL syringe with the solution to be examined and then fill to the 5 mL mark.
2. Empty the syringe into a 100-ml beaker.
3. Fill the measuring beaker up to the 100 mL mark with chlorine-free water.
4. Mix contents by stirring.
5. Fill a clean 5 mL syringe to the 1 mL mark with the diluted solution.
6. Empty the syringe into a clean 100 mL beaker.
7. Fill the measuring beaker up to the 100 mL mark with chlorine-free water.
8. Mix contents by stirring.

The test is performed with this solution.

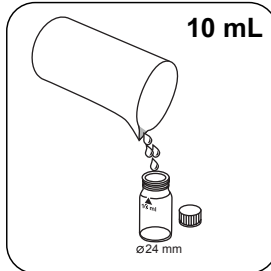

Fill 24 mm vial with **10 mL prepared sample**.

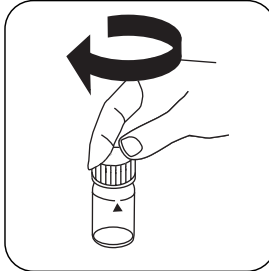

Close vial(s).

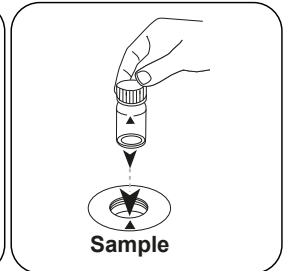

Place **sample vial** in the sample chamber. Pay attention to the positioning.

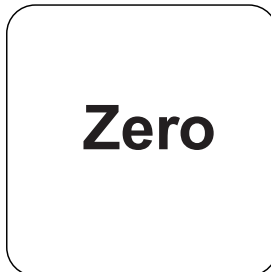

Press the **ZERO** button.

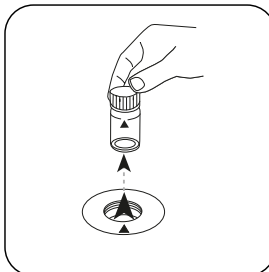

Remove the vial from the sample chamber.

For devices that require **no ZERO measurement**, start here.



EN

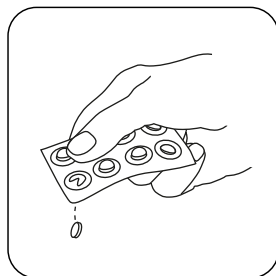

Add **CHLORINE HR (KI)** tablet.

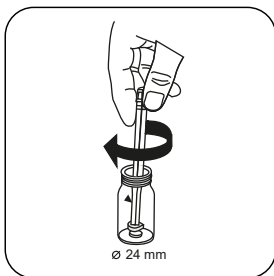

Crush tablet(s) by rotating slightly.

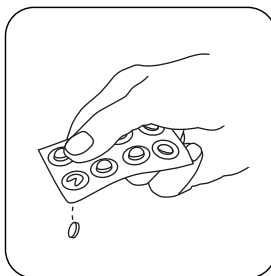

Add **ACIDIFYING GP** tablet.

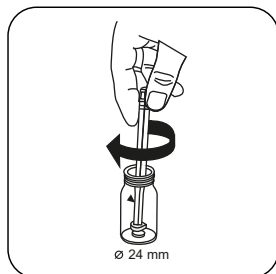

Crush tablet(s) by rotating slightly.

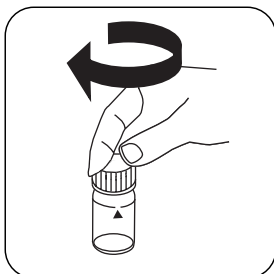

Close vial(s).

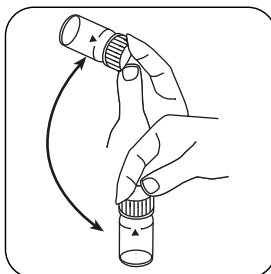

Dissolve tablet(s) by inverting.

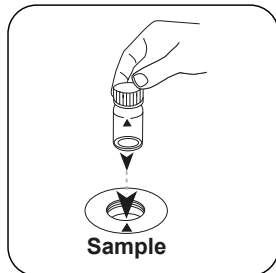

Place **sample vial** in the sample chamber. Pay attention to the positioning.

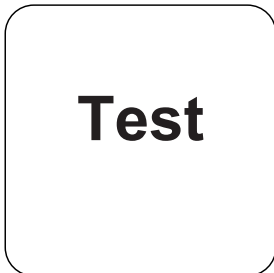

Press the **TEST (XD: START)** button.

The display will show the content of effective chlorine in % by weight (w/w %) relative to the **undiluted** sodium hypochlorite solution.



Chemical Method

Potassium Iodide

Appendix

Method Validation

Limit of Detection	0.03 %
Limit of Quantification	0.1 %
End of Measuring Range	16.8 %
Sensitivity	9.21 % / Abs
Confidence Intervall	0.12 %
Standard Deviation	0.05 %
Variation Coefficient	0.55 %

Derived from

EN ISO 7393-3

* including stirring rod, 10 cm

EN

KS4.3 T / 20

Methoden Name

Methodennummer

Barcode zur Methodenerkennung

Messbereich

20

S:4.3

Säure / Indikator

Displayanzeige im MD 100 MD 110 / MD 200

Chemische Methode

Instrumentenspezifische Informationen

Der Test kann auf den folgenden Geräten durchgeführt werden. Zusätzlich sind die benötigte Küvette und der Absorptionsbereich der Photometer angegeben.

Geräte	Küvette	λ	Messbereich
MD 200, MD 600, MD 610, MD 640, MultiDirect, PM 620, PM 630	ø 24 mm	610 nm	0,1 - 4 mmol/l $K_{S4.3}$
SpectroDirect, XD 7000, XD 7500	ø 24 mm	615 nm	0,1 - 4 mmol/l $K_{S4.3}$

Material

Benötigtes Material (zum Teil optional):

Reagenzien	Form/Menge	Bestell-Nr.
Alka-M-Photometer	Tablette / 100	513210BT
Alka-M-Photometer	Tablette / 250	513211BT

Anwendungsbereich

- Abwasserbehandlung
- Trinkwasseraufbereitung
- Rohwasserbehandlung

Anmerkungen

1. Die Begriffe Alkalität-m, m-Wert, Gesamtalkalität und Säurekapazität $K_{S4.3}$ sind identisch.
2. Die exakte Einhaltung des Probevolumens von 10 ml ist für die Genauigkeit des Analyseergebnisses entscheidend.

Sprachkürzel nach ISO 639-1

Revisionsstand

DE Methodenhandbuch 01/20

Durchführung der
Messung**Durchführung der Bestimmung Säurekapazität $K_{s4,3}$ mit Tablette**

Die Methode im Gerät auswählen.

Für diese Methode muss bei folgenden Geräten keine ZERO-Messung durchgeführt werden: XD 7000, XD 7500



24-mm-Küvette mit **10 ml Probe** füllen.



Küvette(n) verschließen.

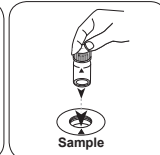

Die **Probeküvette** in den Messschacht stellen. Positionierung beachten.

• • •

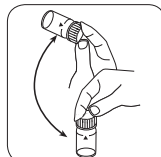

Tablette(n) durch Umschwenken lösen.

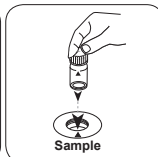

Die **Probeküvette** in den Messschacht stellen. Positionierung beachten.

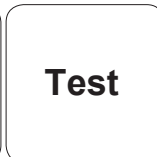

Taste **TEST** (XD: **START**) drücken.

In der Anzeige erscheint das Ergebnis als Säurekapazität $K_{s4,3}$.



Chlor HR (KI) T

M105

5 - 200 mg/L Cl₂

CLHr

KI / Säure

Material

DE

Benötigtes Material (zum Teil optional):

Reagenzien	Form/Menge	Bestell-Nr.
Chlorine HR (KI)	Tablette / 100	513000BT
Chlorine HR (KI)	Tablette / 250	513001BT
Acidifying GP	Tablette / 100	515480BT
Acidifying GP	Tablette / 250	515481BT
Set Chlorine HR (KI)/Acidifying GP#	je 100	517721BT
Set Chlorine HR (KI)/Acidifying GP#	je 250	517722BT
Chlorine HR (KI)	Tablette / 100	501210
Chlorine HR (KI)	Tablette / 250	501211

Durchführung der Bestimmung Chlor HR (KI) mit Tablette

Die Methode im Gerät auswählen.

Für diese Methode muss bei folgenden Geräten nicht jedes mal eine ZERO-Messung durchgeführt werden: XD 7000, XD 7500

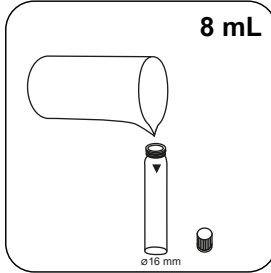

16-mm-Küvette mit **8 mL Probe** füllen.

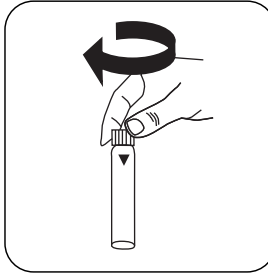

Küvette(n) verschließen.

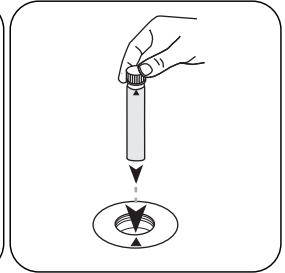

Die **Probeküvette** in den Messschacht stellen. Positionierung beachten.

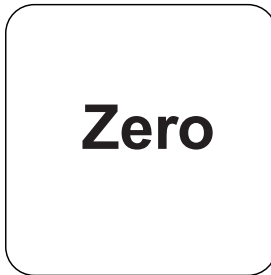

Taste **ZERO** drücken.

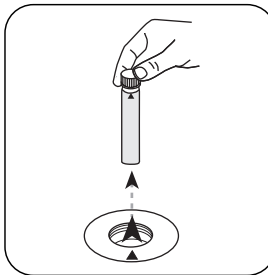

Die **Küvette** aus dem Messschacht nehmen.

Bei Geräten, die **keine ZERO-Messung** erfordern, **hier beginnen**.

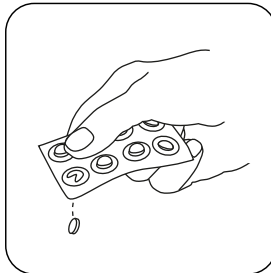

Eine **Chlorine HR (KI) Tablette** zugeben.

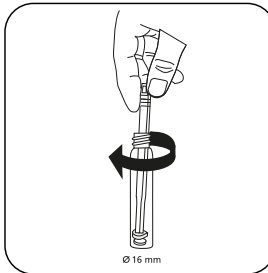

Tablette(n) unter leichter Drehung zerdrücken.

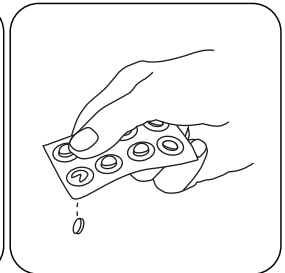

Eine **ACIDIFYING GP Tablette** zugeben.

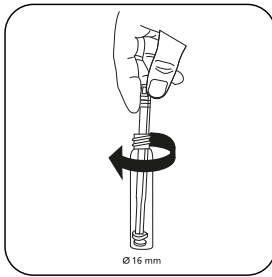

Tablette(n) unter leichter Drehung zerdrücken.

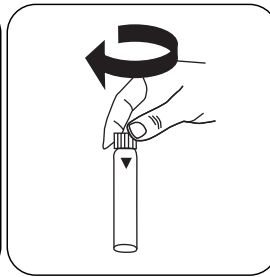

Küvette(n) verschließen.

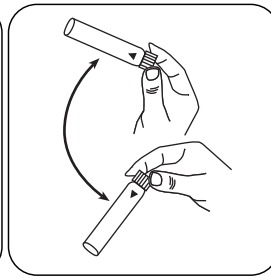

Tablette(n) durch Umschwenken lösen.

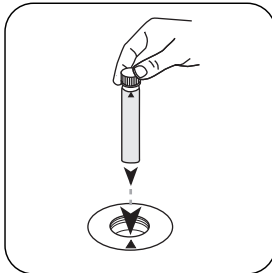

Die **Probenküvette** in den Messschacht stellen. Positionierung beachten.

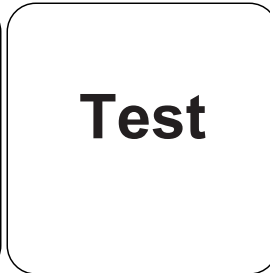

Taste **TEST** (XD: **START**) drücken.

In der Anzeige erscheint das Ergebnis in mg/L Chlor.

Chemische Methode

KI / Säure

Appendix

Störungen

Permanente Störungen

- Alle in den Proben vorhandenen Oxidationsmittel reagieren wie Chlor, was zu Mehrbefunden führt.

Methodenvalidierung

Nachweisgrenze	1.29 mg/L
Bestimmungsgrenze	3.86 mg/L
Messbereichsende	200 mg/L
Empfindlichkeit	83.96 mg/L / Abs
Vertrauensbereich	1.14 mg/L
Verfahrensstandardabweichung	0.45 mg/L
Verfahrensvariationskoeffizient	0.45 %

Abgeleitet von

EN ISO 7393-3

* inklusive Rührstab

DE



Hypochlorit T

M212

0,2 - 16 % NaOCI

Kaliumiodid

Material

DE

Benötigtes Material (zum Teil optional):

Reagenzien	Form/Menge	Bestell-Nr.
Acidifying GP	Tablette / 100	515480BT
Acidifying GP	Tablette / 250	515481BT
Chlorine HR (KI)	Tablette / 100	513000BT
Chlorine HR (KI)	Tablette / 250	513001BT
Chlorine HR (KI)	Tablette / 100	501210
Chlorine HR (KI)	Tablette / 250	501211
Set Chlorine HR (KI)/Acidifying GP#	je 100	517721BT
Set Chlorine HR (KI)/Acidifying GP#	je 250	517722BT
Verdünnungsset Natriumhypochlorit	1 St.	414470

Anmerkungen

1. Diese Methode bietet die Möglichkeit eines einfachen schnellen Tests, der an Ort und Stelle durchgeführt werden kann und ist demzufolge nicht so präzise, wie eine vergleichbare Labormethode.
2. Bei strenger Einhaltung der beschriebenen Vorgehensweise kann eine Genauigkeit von ± 1 Gew.% erreicht werden.

Durchführung der Bestimmung Natriumhypochlorit mit Tablette

Die Methode im Gerät auswählen.

Für diese Methode muss bei folgenden Geräten nicht jedes mal eine ZERO-Messung durchgeführt werden: XD 7000, XD 7500

Die Probe wird 2000-fach verdünnt:

1. Eine 5-mL-Spritze zuerst mit der zu untersuchenden Lösung ausspülen und dann bis zur 5-mL-Marke füllen.
2. Die Spritze in einen 100-mL-Messbecher entleeren.
3. Den Messbecher bis zur 100-mL-Marke mit chlorfreiem Wasser auffüllen.
4. Den Inhalt durch Umrühren mischen.
5. Eine saubere 5-mL-Spritze bis zur 1-mL-Marke mit der verdünnten Lösung füllen.
6. Die Spritze in einen sauberen 100-mL-Messbecher entleeren.
7. Den Messbecher bis zur 100-mL-Marke mit chlorfreiem Wasser auffüllen.
8. Den Inhalt durch Umrühren mischen.

Der Test wird mit dieser Lösung durchgeführt.

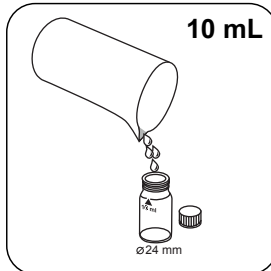

24-mm-Küvette mit **10 mL** vorbereiteter Probe füllen.

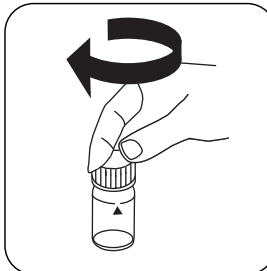

Küvette(n) verschließen.

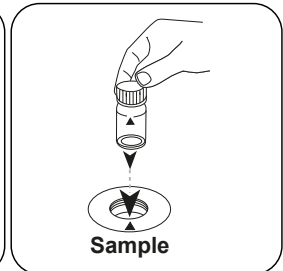

Die **Probenküvette** in den Messschacht stellen. Positionierung beachten.

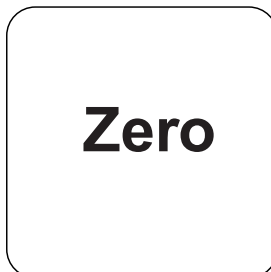

Taste **ZERO** drücken.

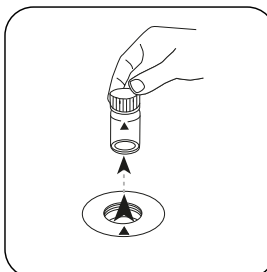

Küvette aus dem Messschacht nehmen.

Bei Geräten, die **keine ZERO-Messung** erfordern, **hier beginnen**.



DE

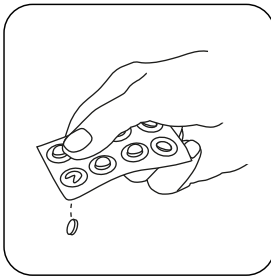

Eine **CHLORINE HR (KI) Tablette** zugeben.

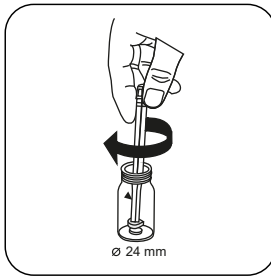

Tablette(n) unter leichter Drehung zerdrücken.

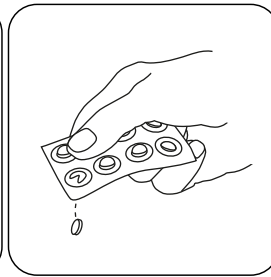

Eine **ACIDIFYING GP Tablette** zugeben.

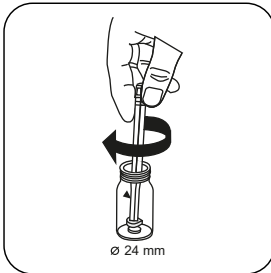

Tablette(n) unter leichter Drehung zerdrücken.

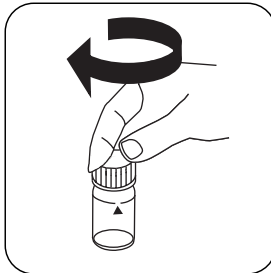

Küvette(n) verschließen.

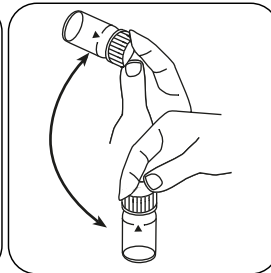

Tablette(n) durch Umschwenken lösen.

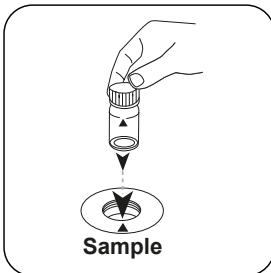

Die **Probenküvette** in den Messschacht stellen. Positionierung beachten.

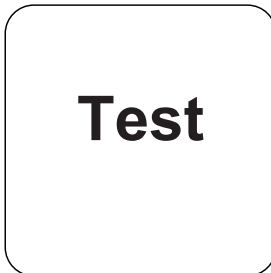

Taste **TEST (XD: START)** drücken.

In der Anzeige erscheint der Gehalt an wirksamen Chlor in Gewichtprozent (w/w %) bezogen auf die **unverdünnte** Natriumhypochlorit-Lösung.



Chemische Methode

Kaliumiodid

Appendix

Methodenvalidierung

Nachweisgrenze	0.03 %
Bestimmungsgrenze	0.1 %
Messbereichsende	16.8 %
Empfindlichkeit	9.21 % / Abs
Vertrauensbereich	0.12 %
Verfahrensstandardabweichung	0.05 %
Verfahrensvariationskoeffizient	0.55 %

Abgeleitet von

EN ISO 7393-3

* inklusive Rührstab

DE

KS4.3 T / 20

Nombre del método

Número de método

Código de barras para reconocer el método

Rango de medición

20

S:4.3

Indicación en la pantalla de MD 100 / MD 110 / MD 200

Método químico

Información específica del instrumento

La prueba puede realizarse en los siguientes dispositivos. Además, se muestran la cubeta requerida y el rango de absorción del fotómetro.

Dispositivos	Cubeta	λ	Rango de medición
MD 200, MD 600, MD 610, MD 640, MultiDirect, PM 620, PM 630	\varnothing 24 mm	610 nm	0.1 - 4 mmol/l $K_{S4.3}$
SpectroDirect, XD 7000, XD 7500	\varnothing 24 mm	615 nm	0.1 - 4 mmol/l $K_{S4.3}$

Material

Material requerido (parcialmente opcional):

Título	Unidad de embalaje	Referencia No
Fotómetro alca-M	Tabletas / 100	513210BT
Fotómetro alca-M	Tabletas / 250	513211BT

Lista de aplicaciones

- Tratamiento de aguas residuales
- Tratamiento de aguas potables
- Tratamiento de aguas de aporte

Notas

1. Las definiciones de alcalinidad-m, valor-m y capacidad ácida $K_{S4.3}$ son idénticas.
2. Añadir un volumen de muestra de exactamente 10 ml, ya que este volumen influye de forma decisiva en la exactitud del resultado.

Códigos de idioma ISO 639-1

Estado de revisión

ES Manual de Métodos 01/20

Realización de la determinación

Ejecución de la determinación Capacidad ácida $K_{a4.3}$ con tableta

Seleccionar el método en el aparato.

Para este método no es necesario realizar medición CERO en los aparatos siguientes: XD 7000, XD 7500



Llenar la cubeta de 24 mm con **10 ml de muestra**.



Cerrar la(s) cubeta(s).

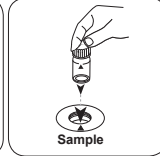

Poner la **cubeta de muestra** en el compartimiento de medición. ¡Debe tenerse en cuenta el posicionamiento!

• • •

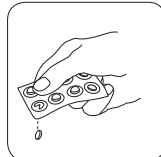

Añadir **tableta ALKA-M-PHOTOMETER**.

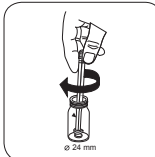

Triturar la(s) tableta(s) girando ligeramente.

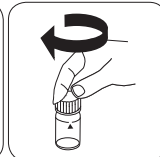

Cerrar la(s) cubeta(s).



Cloro HR (KI) T

M105

5 - 200 mg/L Cl₂

CLHr

KI / ácido

Material

ES

Material requerido (parcialmente opcional):

Reactivos	Unidad de embalaje	No. de referencia
Cloro HR (KI)	Tabletas / 100	513000BT
Cloro HR (KI)	Tabletas / 250	513001BT
Acidificante GP	Tabletas / 100	515480BT
Acidificante GP	Tabletas / 250	515481BT
Juego cloro HR (KI)/acidificante GP [#]	100 cada	517721BT
Juego cloro HR (KI)/acidificante GP [#]	250 cada	517722BT
Cloro HR (KI)	Tabletas / 100	501210
Cloro HR (KI)	Tabletas / 250	501211

Ejecución de la determinación Cloro HR (KI) con tableta

Seleccionar el método en el aparato.

Para este método, no es necesario realizar una medición CERO cada vez en los siguientes dispositivos: XD 7000, XD 7500

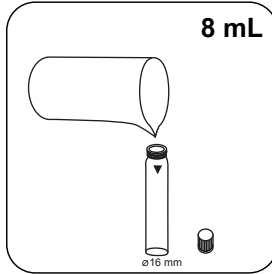

Llenar la cubeta de 16 mm con **8 mL de muestra**.

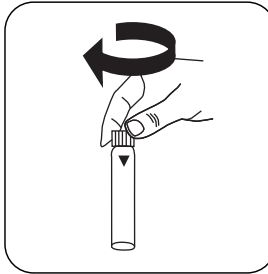

Cerrar la(s) cubeta(s).

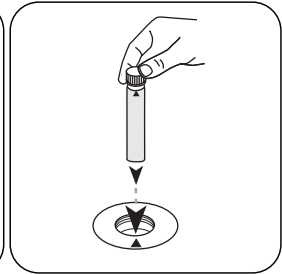

Poner la **cubeta de muestra** en el compartimiento de medición. ¡Debe tenerse en cuenta el posicionamiento!

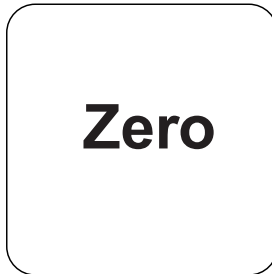

Pulsar la tecla **ZERO**.

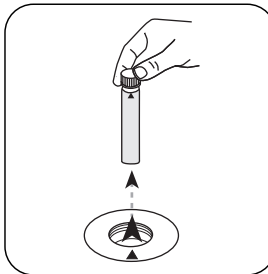

Extraer la **cubeta** del compartimiento de medición.

Para los aparatos que **no requieran medición CERO**, empezar aquí.

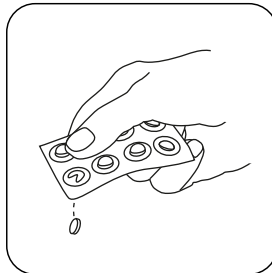

Añadir **tableta Chlorine HR (KI)**.

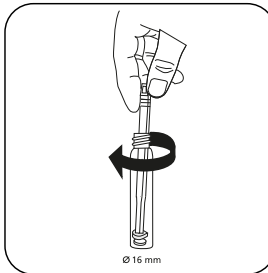

Triturar la(s) tableta(s) girando ligeramente.

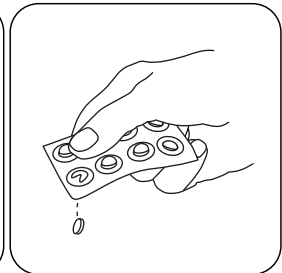

Añadir **tableta ACIDIFYING GP**.

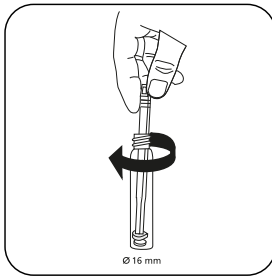

Triturar la(s) tableta(s) girando ligeramente.

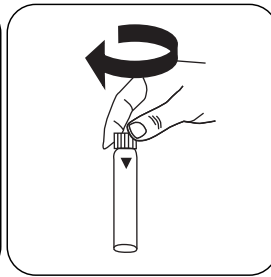

Cerrar la(s) cubeta(s).

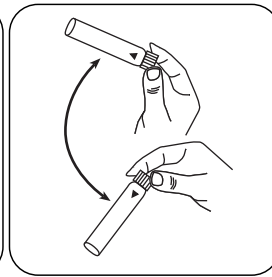

Disolver la(s) tableta(s) girando.

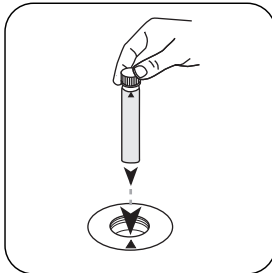

Poner la **cubeta de muestra** en el compartimiento de medición. ¡Debe tenerse en cuenta el posicionamiento!

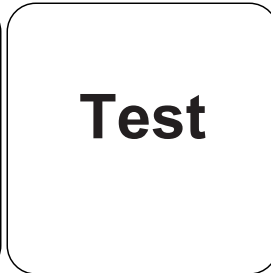

Pulsar la tecla **TEST** (XD: **START**).

A continuación se visualizará el resultado en mg/L Cloro.

Método químico

KI / ácido

Apéndice

Interferencia

ES

Interferencias persistentes

- Todos los elementos oxidantes existentes en la muestra reaccionan como el cloro, lo que produce un resultado más elevado.

Validación del método

Límite de detección	1.29 mg/L
Límite de determinación	3.86 mg/L
Límite del rango de medición	200 mg/L
Sensibilidad	83.96 mg/L / Abs
Intervalo de confianza	1.14 mg/L
Desviación estándar	0.45 mg/L
Coefficiente de variación	0.45 %

Derivado de

EN ISO 7393-3

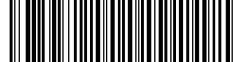

Hipoclorito sódico T

M212

0.2 - 16 % NaOCl

Yoduro de potasio

Material

ES

Material requerido (parcialmente opcional):

Reactivos	Unidad de embalaje	No. de referencia
Acidificante GP	Tabletas / 100	515480BT
Acidificante GP	Tabletas / 250	515481BT
Cloro HR (KI)	Tabletas / 100	513000BT
Cloro HR (KI)	Tabletas / 250	513001BT
Cloro HR (KI)	Tabletas / 100	501210
Cloro HR (KI)	Tabletas / 250	501211
Juego cloro HR (KI)/acidificante GP [#]	100 cada	517721BT
Juego cloro HR (KI)/acidificante GP [#]	250 cada	517722BT
Juego de dilución hipoclorito sódico	1 Cantidad	414470

Notas

1. Este método permite realizar una muestra rápida simple, que puede realizarse in situ y, por lo tanto, no es tan precisa como un método de laboratorio comparable.
2. Cumpliendo estrictamente el procedimiento descrito puede alcanzarse una exactitud de ± 1 peso %.

Ejecución de la determinación Hipoclorito sódico con tableta

Seleccionar el método en el aparato.

Para este método, no es necesario realizar una medición CERO cada vez en los siguientes dispositivos: XD 7000, XD 7500

La muestra se diluye 1/2000:

1. Primero, lavar una jeringuilla de 5 mL con la solución a investigar y después llenar hasta la marca de 5 mL.
2. Vaciar la jeringuilla en un vaso graduado de 100 mL.
3. Llenar con agua sin cloro el vaso graduado hasta la marca de 100 mL.
4. Mezclar el contenido agitando.
5. Llenar una jeringuilla de 5 mL limpia con solución diluida hasta la marca de 1 mL.
6. Vaciar la jeringuilla en un vaso graduado limpio de 100 mL.
7. Llenar con agua sin cloro el vaso graduado hasta la marca de 100 mL.
8. Mezclar el contenido agitando.

El test se realiza con esta solución.



Llenar la cubeta de 24 mm con **10 mL de la muestra preparada**.

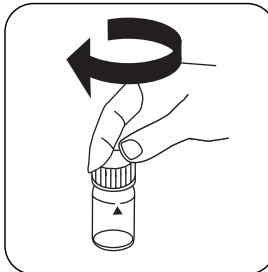

Cerrar la(s) cubeta(s).

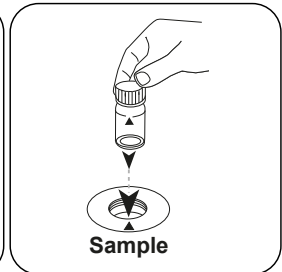

Poner la **cubeta de muestra** en el compartimento de medición. ¡Debe tenerse en cuenta el posicionamiento!

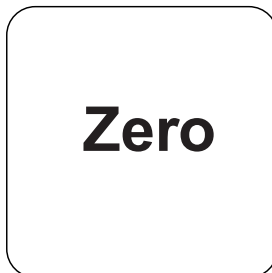

Pulsar la tecla **ZERO**.

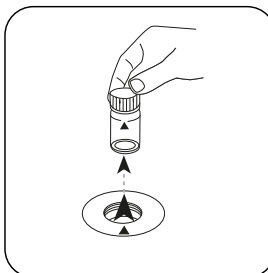

Extraer la cubeta del compartimento de medición.

Para los aparatos que **no requieran medición CERO**, empezar aquí.

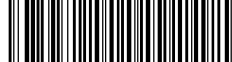

ES

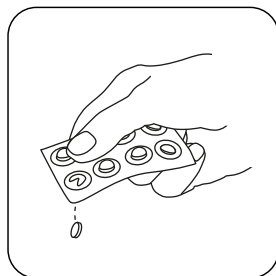

Añadir **tableta CHLORINE HR (KI)**.

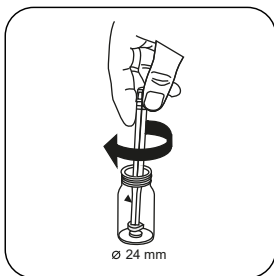

Triturar la(s) tableta(s) girando ligeramente.

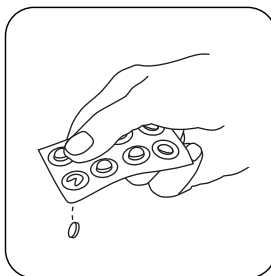

Añadir **tableta ACIDIFYING GP**.

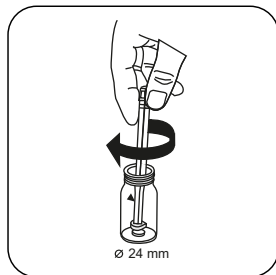

Triturar la(s) tableta(s) girando ligeramente.

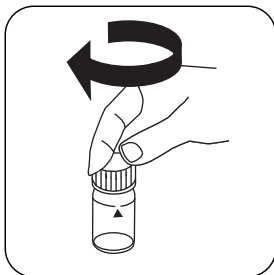

Cerrar la(s) cubeta(s).

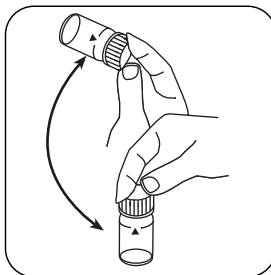

Disolver la(s) tableta(s) girando.

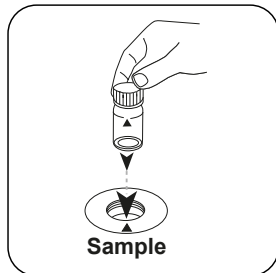

Poner la **cubeta de muestra** en el compartimiento de medición. ¡Debe tenerse en cuenta el posicionamiento!

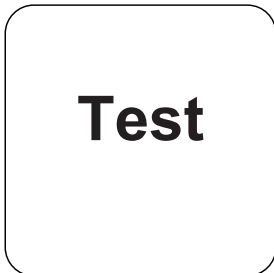

Pulsar la tecla **TEST (XD: START)**.

A continuación se visualiza el contenido en cloro efectivo en porcentaje del peso (w/w %) respecto a la solución de hipoclorito sódico **sin diluir**.



Método químico

Yoduro de potasio

Apéndice

Validación del método

Límite de detección	0.03 %
Límite de determinación	0.1 %
Límite del rango de medición	16.8 %
Sensibilidad	9.21 % / Abs
Intervalo de confianza	0.12 %
Desviación estándar	0.05 %
Coefficiente de variación	0.55 %

Derivado de

EN ISO 7393-3

ES

KS4.3 T / 20



Nom de la méthode → KS4.3 T

Numéro de méthode → 20

Code à barres pour reconnaître la méthode → [Barcode]

Plage de mesure → 0.1 - 4 mmol/l $K_{S4.3}$

Méthode chimique → Acide / Indicateur

Affichage dans le MD 100 / MD 110 / MD 200 → S:4.3

Informations spécifiques à l'instrument

Le test peut être effectué sur les appareils suivants. De plus, la cuvette requise et la plage d'absorption du photomètre sont indiquées.

Appareils	Cuvette	λ	Gamme de mesure
MD 200, MD 600, MD 610, MD 640, MultiDirect, PM 620, PM 630	ø 24 mm	610 nm	0.1 - 4 mmol/l $K_{S4.3}$
SpectroDirect, XD 7000, XD 7500	ø 24 mm	615 nm	0.1 - 4 mmol/l $K_{S4.3}$

Matériel

Matériel requis (partiellement optionnel):

Titre	Pack contenant	Code
Alka-M-Photometer	Pastilles / 100	513210BT
Alka-M-Photometer	Pastilles / 250	513211BT

Liste d'applications

- Traitement des eaux usées
- Traitement de l'eau potable
- Traitement de l'eau brute

Indication

1. Les termes Alcalinité-m, Valeur m, Alcalinité totale et Capacité acide $K_{S4.3}$ sont identiques.
2. L'observation exacte du volume d'échantillon de 10 ml est décisive pour l'exactitude du résultat de l'analyse.

Codes de langue ISO 639-1 → FR

État de révision → 01/20

FR Méthodes Manuel 01/20

Procédure du test

Réalisation de la quantification Capacité acide $K_{s4,3}$ avec pastille

Sélectionnez la méthode sur l'appareil.

Cette méthode ne nécessite aucune mesure du zéro sur les appareils suivants : XD 7000, XD 7500



Remplissez une cuvette de 24 mm de **10 ml d'échantillon**.

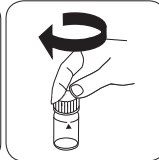

Fermez la(les) cuvette(s).

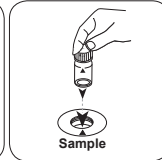

Placez la **cuvette réservée à l'échantillon** dans la chambre de mesure. Attention à la positionner correctement.

• • •

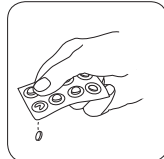

Ajoutez une **pastille de ALKA-M-PHOTOMETER**.

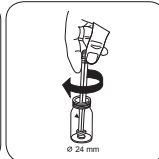

Écrasez la(les) pastille(s) en la(les) tournant un peu.

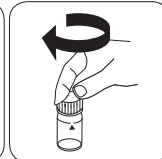

Fermez la(les) cuvette(s).



Chlore HR (KI) T

M105

5 - 200 mg/L Cl₂

CLHr

KI / Acide

Matériel

FR

Matériel requis (partiellement optionnel):

Réactifs	Pack contenant	Code
Chlore HR (KI)	Pastilles / 100	513000BT
Chlore HR (KI)	Pastilles / 250	513001BT
Acidifiants PT	Pastilles / 100	515480BT
Acidifiants PT	Pastilles / 250	515481BT
Kit chlore HR (KI)/acidifiant GP#	100 chacun	517721BT
Kit chlore HR (KI)/acidifiant GP#	250 chacun	517722BT
Chlore HR (KI)	Pastilles / 100	501210
Chlore HR (KI)	Pastilles / 250	501211

Réalisation de la quantification Chlore HR (KI) avec pastille

Sélectionnez la méthode sur l'appareil.

Pour cette méthode, il n'est pas nécessaire d'effectuer une mesure ZERO à chaque fois sur les appareils suivants : XD 7000, XD 7500

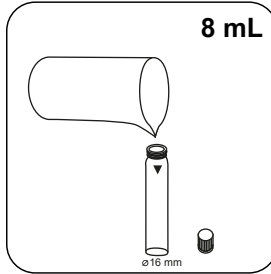

Remplissez une cuvette de 16 mm de **8 mL** d'échantillon.

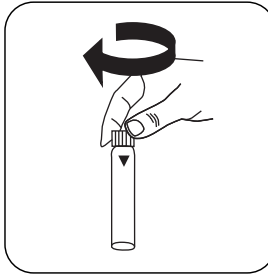

Fermez la(les) cuvette(s).

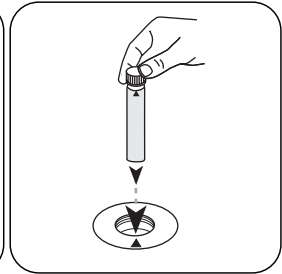

Placez la **cuvette réservée à l'échantillon** dans la chambre de mesure. Attention à la positionner correctement.

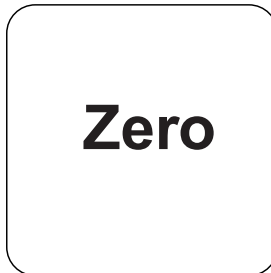

Appuyez sur la touche **ZERO**.

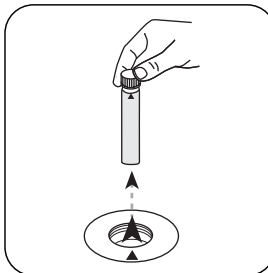

Retirez la **cuvette** de la chambre de mesure.

Sur les appareils ne nécessitant **aucune mesure ZÉRO**, commencez ici.

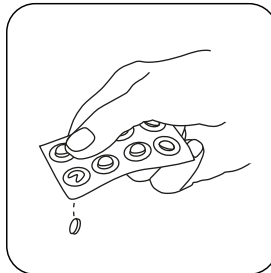

Ajoutez une **pastille de Chlorine HR (KI)**.

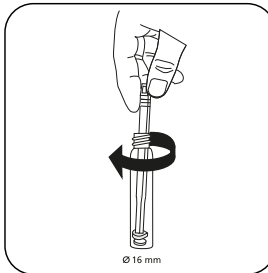

Écrasez la(les) pastille(s) en la(les) tournant un peu.

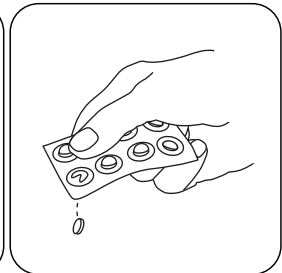

Ajoutez une **pastille de ACIDIFYING GP**.



FR

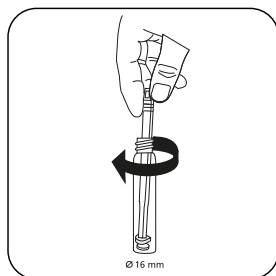

Écrasez la(les) pastille(s)
en la(les) tournant un peu.

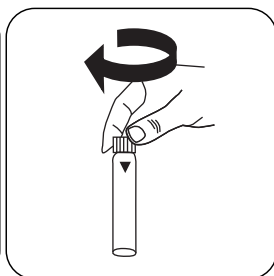

Fermez la(les) cuvette(s).

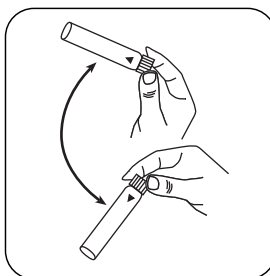

Dissolvez la(les) pastille(s)
en mettant le tube plusieurs
fois à l'envers.

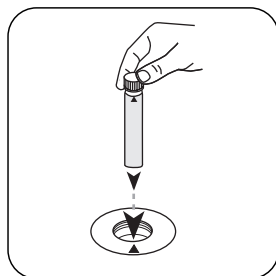

Placez la **cuvette réservée**
à l'échantillon dans la
chambre de mesure.
Attention à la positionner
correctement.

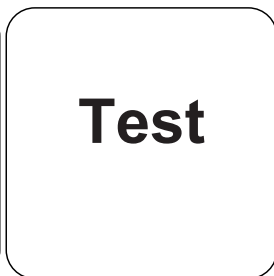

Appuyez sur la touche
TEST (XD: START).

Le résultat s'affiche à l'écran en mg/L chlore.

Méthode chimique

KI / Acide

Appendice

Interférences

Interférences persistantes

- Les agents oxydants contenus dans les échantillons réagissent tous comme le chlore, ce qui entraîne des résultats plus élevés.

Méthode Validation

Limite de détection	1.29 mg/L
Limite de détermination	3.86 mg/L
Fin de la gamme de mesure	200 mg/L
Sensibilité	83.96 mg/L / Abs
Intervalle de confiance	1.14 mg/L
Déviatoin standard	0.45 mg/L
Coefficient de variation	0.45 %

Dérivé de

EN ISO 7393-3

ⁱⁱ* agitateur inclus

FR

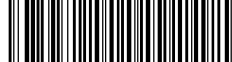

Hypochlorite de sodium T

M212

0.2 - 16 % NaOCI

Sodumiodide

FR

Matériel

Matériel requis (partiellement optionnel):

Réactifs	Pack contenant	Code
Acidifiants PT	Pastilles / 100	515480BT
Acidifiants PT	Pastilles / 250	515481BT
Chlore HR (KI)	Pastilles / 100	513000BT
Chlore HR (KI)	Pastilles / 250	513001BT
Chlore HR (KI)	Pastilles / 100	501210
Chlore HR (KI)	Pastilles / 250	501211
Kit chlore HR (KI)/acidifiant GP#	100 chacun	517721BT
Kit chlore HR (KI)/acidifiant GP#	250 chacun	517722BT
Kit de dissolution Hypochlorite de sodium	1 Pièces	414470

Indication

1. Cette méthode est une possibilité simple et rapide, réalisée immédiatement. Elle n'est donc pas aussi fidèle qu'une méthode de laboratoire comparable.
2. En respectant exactement la marche à suivre décrite, il est possible d'obtenir une exactitude de $\pm 1\%$ en poids.

Réalisation de la quantification Hypochlorite de sodium avec pastille

Sélectionnez la méthode sur l'appareil.

Pour cette méthode, il n'est pas nécessaire d'effectuer une mesure ZERO à chaque fois sur les appareils suivants : XD 7000, XD 7500

L'échantillon est dilué au 2 000ème :

1. Rincez tout d'abord une seringue de 5 mL en utilisant la solution à analyser et puis remplissez-la jusqu'au repère de 5 mL.
2. Videz la seringue dans un bécher de mesure 100 mL.
3. Remplissez le bécher de mesure d'eau déchlorée jusqu'au repère de 100 mL.
4. Mélangez le contenu.
5. Remplissez une seringue propre de 5 mL jusqu'au repère de 1 mL en utilisant la solution diluée.
6. Videz la seringue dans un bécher de mesure propre de 100 mL.
7. Remplissez le bécher de mesure d'eau déchlorée jusqu'au repère de 100 mL.
8. Mélangez le contenu.

Le test est effectué avec cette solution.

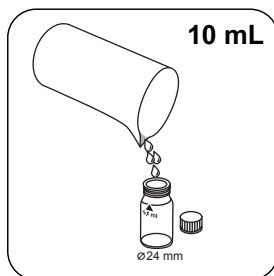

Remplissez une cuvette de 24 mm de **10 mL d'échantillon préparé**.

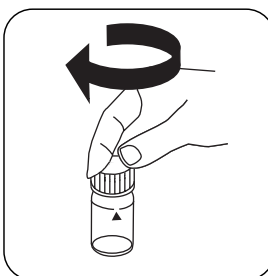

Fermez la(les) cuvette(s).

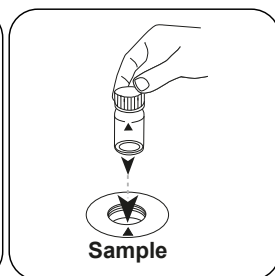

Placez la **cuvette réservée à l'échantillon** dans la chambre de mesure. Attention à la positionner correctement.

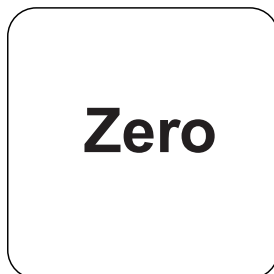

Appuyez sur la touche **ZERO**.

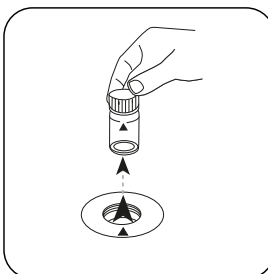

Retirez la cuvette de la chambre de mesure.

Sur les appareils ne nécessitant **aucune mesure ZÉRO** , commencez ici.

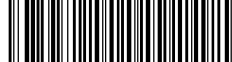

FR

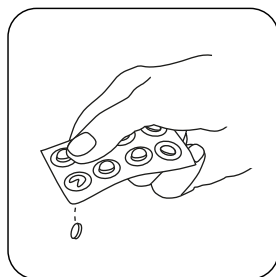

Ajoutez une **pastille de CHLORINE HR (KI)**.

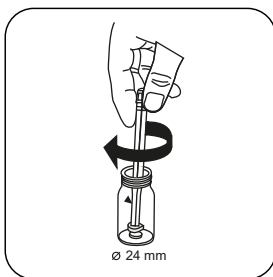

Écrasez la(les) pastille(s) en la(les) tournant un peu.

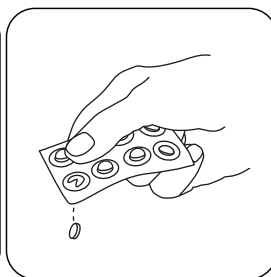

Ajoutez une **pastille de ACIDIFYING GP**.

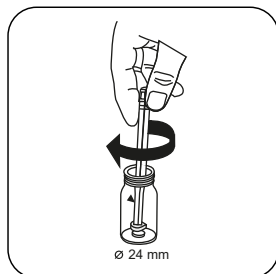

Écrasez la(les) pastille(s) en la(les) tournant un peu.

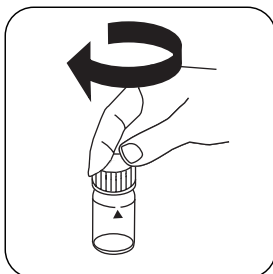

Fermez la(les) cuvette(s).

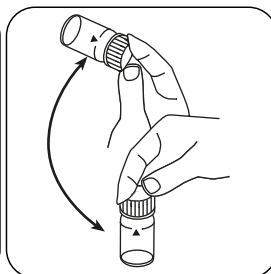

Dissolvez la(les) pastille(s) en mettant le tube plusieurs fois à l'envers.

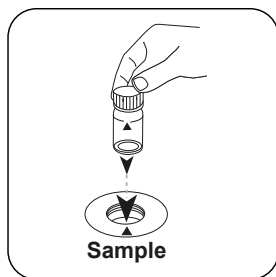

Placez la **cuvette réservée à l'échantillon** dans la chambre de mesure. Attention à la positionner correctement.

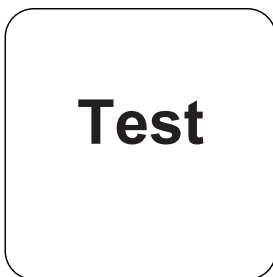

Appuyez sur la touche **TEST (XD: START)**.

La teneur en chlore actif s'affiche à l'écran en pourcentage en poids (w/w %) par rapport à la solution d'hypochlorite de sodium **non diluée**.



Méthode chimique

Sodiumiodide

Appendice

Méthode Validation

Limite de détection	0.03 %
Limite de détermination	0.1 %
Fin de la gamme de mesure	16.8 %
Sensibilité	9.21 % / Abs
Intervalle de confiance	0.12 %
Déviatiion standard	0.05 %
Coefficient de variation	0.55 %

Dérivé de

EN ISO 7393-3

†# agitateur inclus

FR

KS4.3 T / 20



Nome do método

Número do método

Código de barras para a detecção dos métodos

Área de medição

$K_{S_{4.3}} T$
0.1 - 4 mmol/l $K_{S_{4.3}}$
Ácido / Indicador

20
S:4.3

Indicado no display: MD 100 / MD 110 / MD 200

Método Químico

Informação específica do instrumento

O teste pode ser realizado nos seguintes dispositivos. Além disso, a cubeta necessária e a faixa de absorção do fotómetro são indicadas.

Dispositivos	Cubeta	λ	Faixa de Medição
MD 200, MD 600, MD 610, MD 640, MultiDirect, PM 620, PM 630	ø 24 mm	610 nm	0.1 - 4 mmol/l $K_{S_{4.3}}$
SpectroDirect, XD 7000, XD 7500	ø 24 mm	615 nm	0.1 - 4 mmol/l $K_{S_{4.3}}$

Material

Material necessário (parcialmente opcional):

Título	Unidade de Embalagem	Artigo No
Alka-M-Photometer	Pastilhas / 100	513210BT
Alka-M-Photometer	Pastilhas / 250	513211BT

Lista de Aplicações

- Tratamento de Esgotos
- Tratamento de Água Potável
- Tratamento de Água Bruta

Notas

1. Os termos alcalinidade-m, m-valor, alcalinidade total e capacidade de acidez $K_{S_{4.3}}$ são idênticos.
2. O cumprimento exato do volume da amostra de 10 ml é decisivo para a precisão do resultado de análise.

Códigos de idioma ISO 639-1

Nível de revisão

PT Métodos Manual 01/20

Efetuar a medição

Realização da determinação Capacidade de acidez $K_{s4.3}$ com pastilha

Escolher o método no equipamento.

Para este método não tem de ser efetuada uma medição ZERO nos seguintes equipamentos: XD 7000, XD 7500



Encher a célula de 24 mm com 10 ml de amostra .

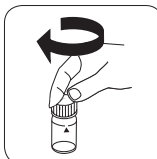

Fechar a(s) célula(s).

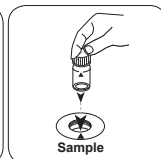

Colocar a **célula de amostra** no compartimento de medição. Observar o posicionamento.

• • •

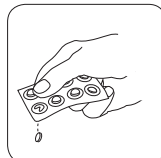

Pastilha ALKA-M-PHOTO-METER.

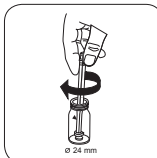

Esmagar a(s) pastilha(s) rodando ligeiramente.

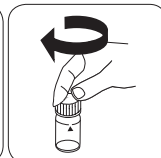

Fechar a(s) célula(s).

PT Métodos Manual 01/20

PT



Cloro HR (KI) T

M105

5 - 200 mg/L Cl₂

CLHr

KI / Ácido

Material

PT

Material necessário (parcialmente opcional):

Reagentes	Unidade de Embalagem	Código do Produto
Cloro HR (KI)	Pastilhas / 100	513000BT
Cloro HR (KI)	Pastilhas / 250	513001BT
Acidificante GP	Pastilhas / 100	515480BT
Acidificante GP	Pastilhas / 250	515481BT
Definir Cloro HR (KI)/Acidificar GP#	cada 100	517721BT
Definir Cloro HR (KI)/Acidificar GP#	cada 250	517722BT
Cloro HR (KI)	Pastilhas / 100	501210
Cloro HR (KI)	Pastilhas / 250	501211

Realização da determinação Cloro HR (KI) com pastilha

Escolher o método no equipamento.

Para este método, uma medição ZERO não precisa ser realizada todas as vezes nos seguintes dispositivos: XD 7000, XD 7500

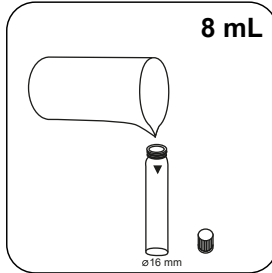

Encher a célula de 16 mm com **8 mL de amostra**.

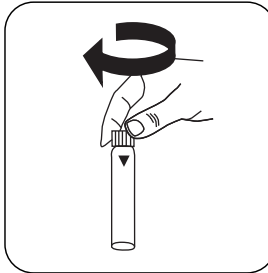

Fechar a(s) célula(s).

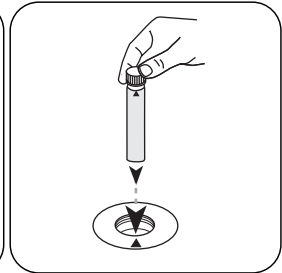

Colocar a **célula de amostra** no compartimento de medição. Observar o posicionamento.

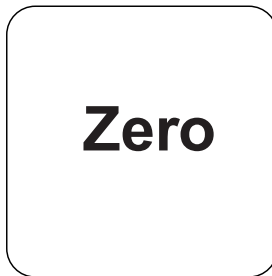

Premir a tecla **ZERO**.

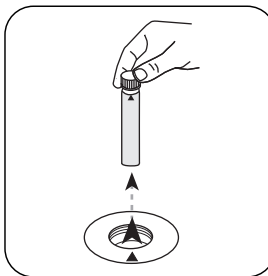

Retirar a **célula** do compartimento de medição.

Nos equipamentos que **não requerem uma medição ZERO**, deve começar aqui.

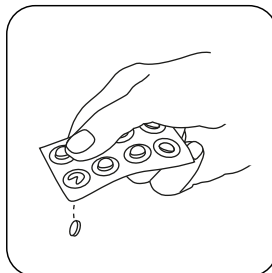

Pastilha Chlorine HR (KI).

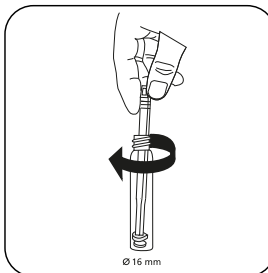

Esmagar a(s) pastilha(s) rodando ligeiramente.

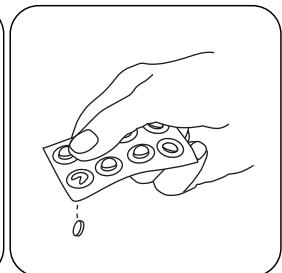

Pastilha ACIDIFYING GP.



PT

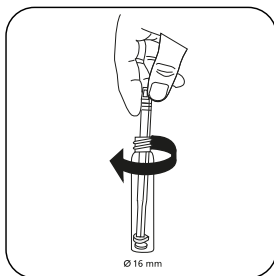

Esmagar a(s) pastilha(s) rodando ligeiramente.

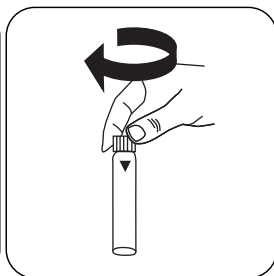

Fechar a(s) célula(s).

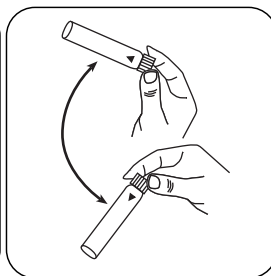

Dissolver a(s) pastilha(s) girando.

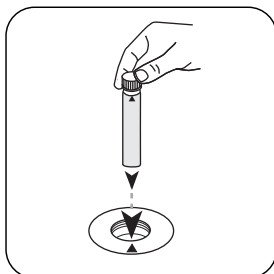

Colocar a **célula de amostra** no compartimento de medição. Observar o posicionamento.

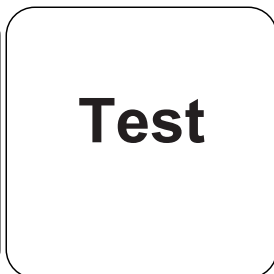

Premir a tecla **TEST** (XD: **START**).

No visor aparece o resultado em mg/L Cloro.



Método Químico

KI / Ácido

Apêndice

Texto de Interferências

Interferências Persistentes

- Todos os oxidantes presentes nas amostras reagem como o cloro, o que leva a resultados demasiado altos.

Validação de método

Limite de Detecção	1.29 mg/L
Limite de Determinação	3.86 mg/L
Fim da Faixa de Medição	200 mg/L
Sensibilidade	83.96 mg/L / Abs
Faixa de Confiança	1.14 mg/L
Desvio Padrão	0.45 mg/L
Coefficiente de Variação	0.45 %

Derivado de

EN ISO 7393-3

*incluindo vareta de agitação

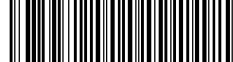

Hipoclorito de sódio T

M212

0.2 - 16 % NaOCl

Potassium Iodide

PT

Material

Material necessário (parcialmente opcional):

Reagentes	Unidade de Embalagem	Código do Produto
Acidificante GP	Pastilhas / 100	515480BT
Acidificante GP	Pastilhas / 250	515481BT
Cloro HR (KI)	Pastilhas / 100	513000BT
Cloro HR (KI)	Pastilhas / 250	513001BT
Cloro HR (KI)	Pastilhas / 100	501210
Cloro HR (KI)	Pastilhas / 250	501211
Definir Cloro HR (KI)/Acidificar GP#	cada 100	517721BT
Definir Cloro HR (KI)/Acidificar GP#	cada 250	517722BT
Conjunto de diluição hipoclorito de sódio	1 pc.	414470

Notas

1. Este método permite um teste rápido e simples que pode ser realizado no local e, por isso, não é tão preciso como um método de laboratório equiparado.
2. Se o procedimento descrito for rigorosamente cumprido, pode conseguir-se uma previsão de $\pm 1\%$ de peso.

Realização da determinação Hipoclorito de sódio com pastilha

Escolher o método no equipamento.

Para este método, uma medição ZERO não precisa ser realizada todas as vezes nos seguintes dispositivos: XD 7000, XD 7500

A amostra é 2000 vezes diluída:

1. Começar por enxaguar uma seringa de 5 mL com a solução a analisar e depois encher até à marca de 5 mL.
2. Esvaziar a seringa para um copo medida de 100 mL.
3. Encher o copo medida com água sem cloro até à marca de 100 mL.
4. Misturar o conteúdo agitando.
5. Encher uma seringa de 5 mL limpa com a solução diluída até à marca de 1 mL.
6. Esvaziar a seringa para um copo medida limpo de 100 mL.
7. Encher o copo medida com água sem cloro até à marca de 100 mL.
8. Misturar o conteúdo agitando.

O teste é realizado com esta solução.

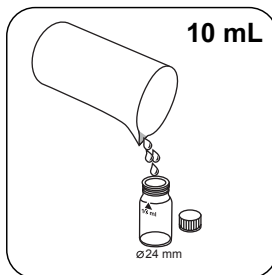

Encher a célula de 24 mm com **10 mL de amostra preparada**.

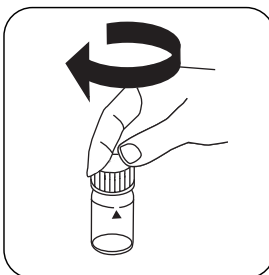

Fechar a(s) célula(s).

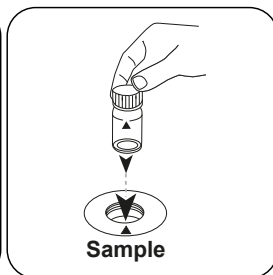

Colocar a **célula de amostra** no compartimento de medição. Observar o posicionamento.

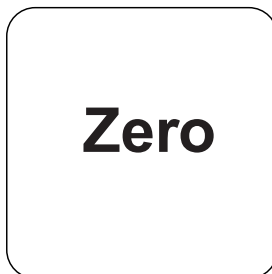

Premir a tecla **ZERO**.

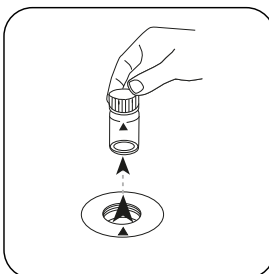

Retirar a célula do compartimento de medição.

Nos equipamentos que **não requerem uma medição ZERO**, deve começar aqui.



PT

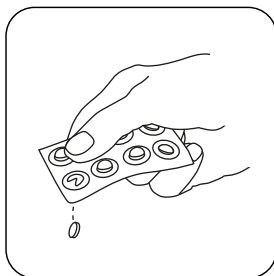

Pastilha CHLORINE HR (KI).

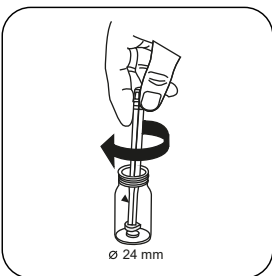

Esmagar a(s) pastilha(s) rodando ligeiramente.

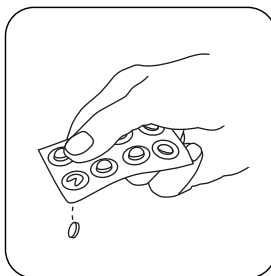

Pastilha ACIDIFYING GP.

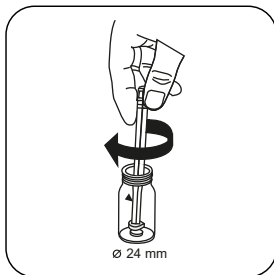

Esmagar a(s) pastilha(s) rodando ligeiramente.

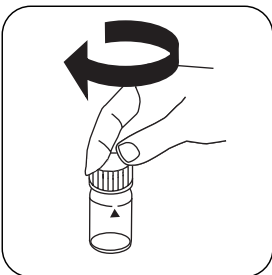

Fechar a(s) célula(s).

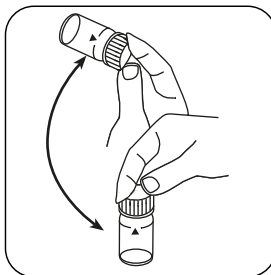

Dissolver a(s) pastilha(s) girando.

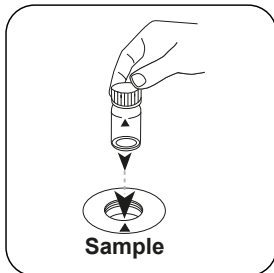

Colocar a **célula de amostra** no compartimento de medição. Observar o posicionamento.

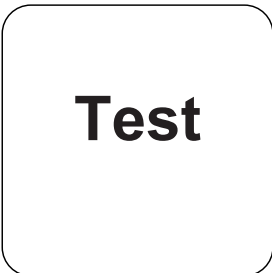

Premir a tecla **TEST (XD: START)**.

No visor aparece o teor de cloro eficaz em percentagem de peso (w/w %) relativamente à solução de hipoclorito de sódio **não diluída**.



Método Químico

Potassium Iodide

Apêndice

Validação de método

Limite de Detecção	0.03 %
Limite de Determinação	0.1 %
Fim da Faixa de Medição	16.8 %
Sensibilidade	9.21 % / Abs
Faixa de Confiança	0.12 %
Desvio Padrão	0.05 %
Coefficiente de Variação	0.55 %

Derivado de

EN ISO 7393-3

*incluindo vareta de agitação

PT

KS4.3 T / 20



Denominazione metodo

Numero metodo

Codice a barre per riconoscere il metodo

Range di misura

$K_{S_{4.3} T}$
0.1 - 4 mmol/l $K_{S_{4.3}}$

20
S:4.3

Indicazione sul display del MD 100 / MD 110 / MD 200

Metodo chimico

Acido/indicatore

Informazioni specifiche dello strumento

Il test può essere eseguito sui seguenti dispositivi. Inoltre, sono indicate la cuvetta richiesta e il range di assorbimento del fotometro.

Dispositivi	Cuvetta	λ	Campo di misura
MD 200, MD 600, MD 610, MD 640, MultiDirect, PM 620, PM 630	ø 24 mm	610 nm	0.1 - 4 mmol/l $K_{S_{4.3}}$
SpectroDirect, XD 7000, XD 7500	ø 24 mm	615 nm	0.1 - 4 mmol/l $K_{S_{4.3}}$

Materiale

Materiale richiesto (in parte facoltativo):

Titolo	Unità di imballaggio	N. ordine
Alka-M-Photometer	Pastiglia / 100	513210BT
Alka-M-Photometer	Pastiglia / 250	513211BT

Campo di applicazione

- Trattamento acqua di scarico
- Trattamento acqua potabile
- Trattamento acqua non depurata

Note

1. I termini alcalinità M, valore M, alcalinità totale e capacità acida $K_{S_{4.3}}$ sono equivalenti.
2. Per l'accuratezza del risultato dell'analisi è fondamentale che il volume del campione misuri esattamente 10 ml.

ISO 639-1 codici linguistici

Stato di revisione

IT Manuale dei Metodi 01/20

**Svolgimento della
misurazione**

Esecuzione della rilevazione Capacità acida $K_{s4,3}$ con pastiglia

Selezionare il metodo nel dispositivo.

Con i seguenti dispositivi, per questo metodo non è necessario eseguire una misurazione ZERO: XD 7000, XD 7500



Riempire una cuvetta da 24 mm con **10 ml di campione**.



Chiudere la/e cuvetta/e.

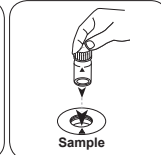

Posizionare la **cuvetta del campione** nel vano di misurazione. Fare attenzione al posizionamento.

• • •

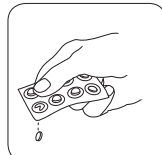

Aggiungere una **pastiglia ALKA-M-PHOTOMETER**.

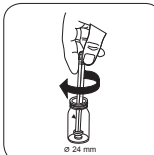

Frantumare la/e pastiglia/e con una leggera rotazione.

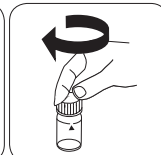

Chiudere la/e cuvetta/e.



Cloro HR (KI) T

M105

5 - 200 mg/L Cl₂

CLHr

KI/acido

IT

Materiale

Materiale richiesto (in parte facoltativo):

Reagenti	Unità di imballaggio	N. ordine
Cloro HR (KI)	Pastiglia / 100	513000BT
Cloro HR (KI)	Pastiglia / 250	513001BT
Acidificante GP	Pastiglia / 100	515480BT
Acidificante GP	Pastiglia / 250	515481BT
Set Cloro HR (KI)/Acidificante GP [#]	ciascuna 100	517721BT
Set Cloro HR (KI)/Acidificante GP [#]	ciascuna 250	517722BT
Cloro HR (KI)	Pastiglia / 100	501210
Cloro HR (KI)	Pastiglia / 250	501211

Esecuzione della rilevazione Cloro HR (KI) con pastiglia

Selezionare il metodo nel dispositivo.

Per questo metodo, non è necessario eseguire una misurazione ZERO ogni volta sui seguenti dispositivi: XD 7000, XD 7500

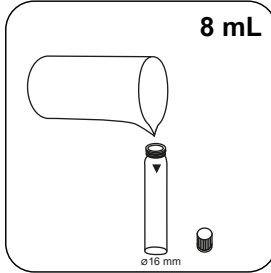

Riempire una cuvetta da 16 mm con **8 mL di campione**.

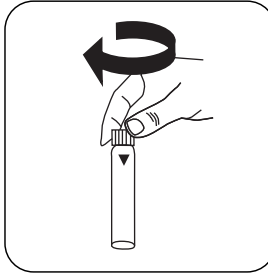

Chiudere la/e cuvetta/e.

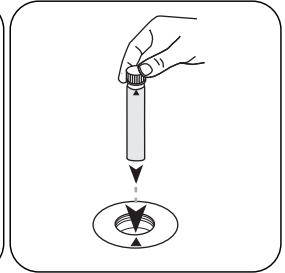

Posizionare la **cuvetta del campione** nel vano di misurazione. Fare attenzione al posizionamento.

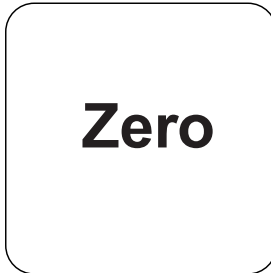

Premere il tasto **ZERO**.

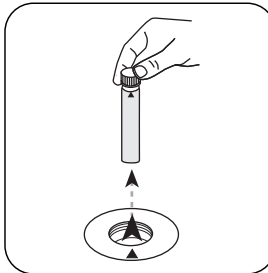

Prelevare la **cuvetta** dal vano di misurazione.

In caso di dispositivi che **non richiedono una misurazione ZERO**, iniziare da qui.

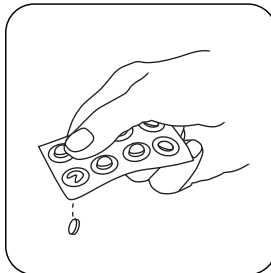

Aggiungere una **pastiglia Chlorine HR (KI)**.

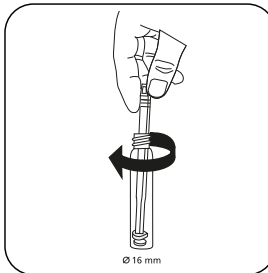

Frantumare la/e pastiglia/e con una leggera rotazione.

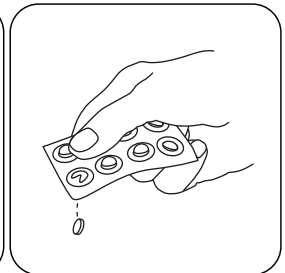

Aggiungere una **pastiglia ACIDIFYING GP**.



IT

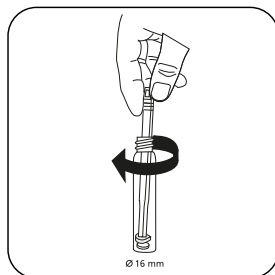

Frantumare la/e pastiglia/e con una leggera rotazione.

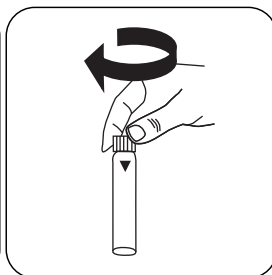

Chiudere la/e cuvetta/e.

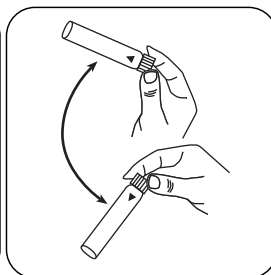

Far sciogliere la/e pastiglia/e agitando.

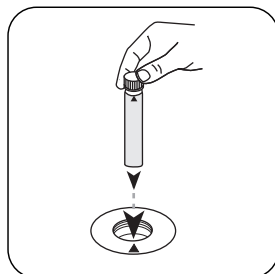

Posizionare la **cuvetta del campione** nel vano di misurazione. Fare attenzione al posizionamento.

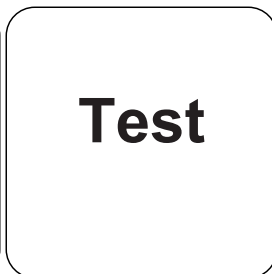

Premere il tasto **TEST** (XD: **START**).

Sul display compare il risultato in mg/L di Cloro.

Metodo chimico

KI/acido

Appendice

Interferenze

Interferenze permanenti

- Tutti gli ossidanti presenti nei campioni reagiscono come il cloro dando risultati troppo elevati.

Validazione metodo

Limite di rilevabilità	1.29 mg/L
Limite di quantificazione	3.86 mg/L
Estremità campo di misura	200 mg/L
Sensibilità	83.96 mg/L / Abs
Intervallo di confidenza	1.14 mg/L
Deviazione standard della procedura	0.45 mg/L
Coefficiente di variazione della procedura	0.45 %

Derivato di

EN ISO 7393-3

[#]Bacchetta compresa

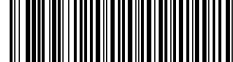

Ipoclorito di sodio T

M212

0.2 - 16 % NaOCl

Ioduro di potassio

IT

Materiale

Materiale richiesto (in parte facoltativo):

Reagenti	Unità di imballaggio	N. ordine
Acidificante GP	Pastiglia / 100	515480BT
Acidificante GP	Pastiglia / 250	515481BT
Cloro HR (KI)	Pastiglia / 100	513000BT
Cloro HR (KI)	Pastiglia / 250	513001BT
Cloro HR (KI)	Pastiglia / 100	501210
Cloro HR (KI)	Pastiglia / 250	501211
Set Cloro HR (KI)/Acidificante GP [#]	ciascuna 100	517721BT
Set Cloro HR (KI)/Acidificante GP [#]	ciascuna 250	517722BT
Set di diluizione Ipoclorito di sodio	1 pz.	414470

Note

1. Questo metodo consente di eseguire un test rapido e semplice sul posto, che non sarà accurato come un metodo di laboratorio comparabile.
2. Attenendosi scrupolosamente alla procedura descritta è possibile ottenere un'accuratezza di $\pm 1\%$ in peso.

Esecuzione della rilevazione Ipoclorito di sodio con pastiglia

Selezionare il metodo nel dispositivo.

Per questo metodo, non è necessario eseguire una misurazione ZERO ogni volta sui seguenti dispositivi: XD 7000, XD 7500

Il campione viene diluito per 2000 volte:

1. Sciacquare innanzitutto una siringa da 5 mL internamente con la soluzione da esaminare e quindi riempirla fino alla tacca dei 5 mL.
2. Iniettare l'intero contenuto della siringa in un misurino da 100 mL.
3. Riempire il misurino con acqua priva di cloro fino alla tacca dei 100 mL.
4. Miscelare il contenuto agitando.
5. Riempire una siringa pulita da 5 mL fino alla tacca di 1 mL con la soluzione diluita.
6. Iniettare l'intero contenuto della siringa in un misurino pulito da 100 mL.
7. Riempire il misurino con acqua priva di cloro fino alla tacca dei 100 mL.
8. Miscelare il contenuto agitando.

Il test viene eseguito con questa soluzione.

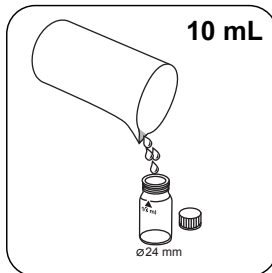

Riempire una cuvetta da 24 mm con **10 mL del campione preparato**.

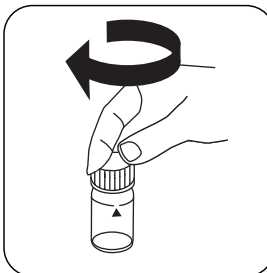

Chiudere la/e cuvetta/e.

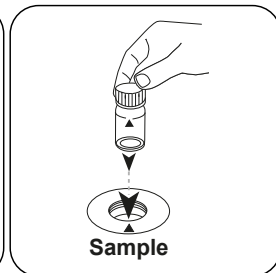

Posizionare la **cuvetta del campione** nel vano di misurazione. Fare attenzione al posizionamento.

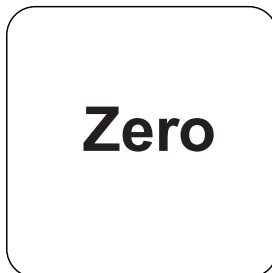

Premere il tasto **ZERO**.

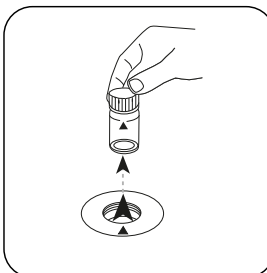

Prelevare la cuvetta dal vano di misurazione.

In caso di dispositivi che **non richiedono una misurazione ZERO**, iniziare da qui.

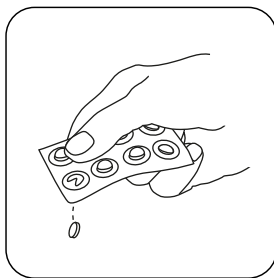

Aggiungere **una pastiglia CHLORINE HR (KI)**.

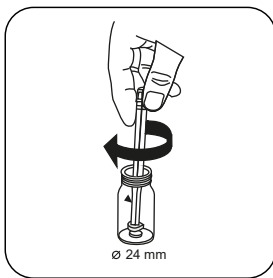

Frantumare la/e pastiglia/e con una leggera rotazione.

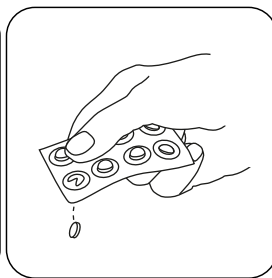

Aggiungere **una pastiglia ACIDIFYING GP**.

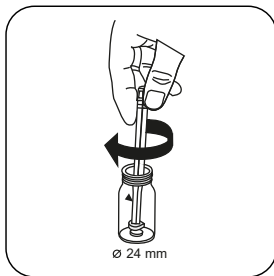

Frantumare la/e pastiglia/e con una leggera rotazione.

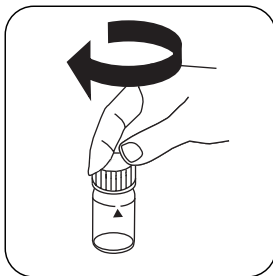

Chiudere la/e cuvetta/e.

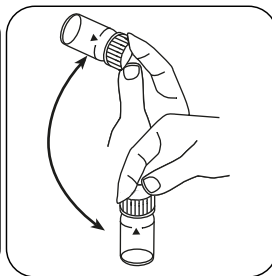

Far sciogliere la/e pastiglia/e agitando.

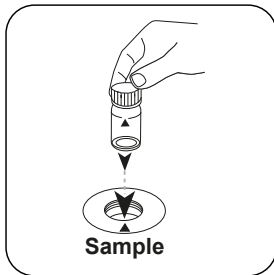

Posizionare la **cuvetta del campione** nel vano di misurazione. Fare attenzione al posizionamento.

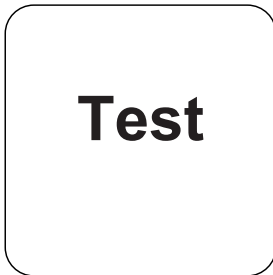

Premere il tasto **TEST (XD: START)**.

Sul display compare il tenore di cloro attivo in percentuale di peso (w/w %) riferita alla soluzione di ipoclorito di sodio **non diluita**.

Metodo chimico

Ioduro di potassio

Appendice

Validazione metodo

Limite di rilevabilità	0.03 %
Limite di quantificazione	0.1 %
Estremità campo di misura	16.8 %
Sensibilità	9.21 % / Abs
Intervallo di confidenza	0.12 %
Deviazione standard della procedura	0.05 %
Coefficiente di variazione della procedura	0.55 %

Derivato di

EN ISO 7393-3

¹⁾Bacchetta compresa

IT

KS4.3 T / 20



Naam van de methode

Nummer methode

Streepjescode ter identificatie van de methode

Meetbereik

$K_{S_{4.3}} T$ M20
0.1 - 4 mmol/l $K_{S_{4.3}}$ S:4.3
Zuur / Indicator

Chemische methode

Uitlezing in MD
100 MD 110 / MD 200

Instrument specifieke informatie

De test kan op de volgende apparaten worden uitgevoerd. Bovendien worden de vereiste cuvette en het absorptiebereik van de fotometer aangegeven.

Toestellen	Cuvet	λ	Meetbereik
MD 200, MD 600, MD 610, MD 640, MultiDirect, PM 620, PM 630	\varnothing 24 mm	610 nm	0.1 - 4 mmol/l $K_{S_{4.3}}$
SpectroDirect, XD 7000, XD 7500	\varnothing 24 mm	615 nm	0.1 - 4 mmol/l $K_{S_{4.3}}$

Reagentia

Benodigd materiaal (deels optioneel):

Titel	Verpakkingseenheid	Bestelnr.
Alka-M-Photometer	Tablet / 100	513210BT
Alka-M-Photometer	Tablet / 250	513211BT

Toepassingsbereik

- Afvalwaterzuivering
- Behandeling drinkwater
- Zuivering vervuild water

Aantekeningen

1. De termen alkaliteit-m, m-waarde, totale alkaliteit en zuurcapaciteit_{S_{4.3}} zijn identiek.
2. De exacte naleving van het monstervolume van 10 ml is bepalend voor de nauwkeurigheid van het analysesresultaat.

Beknopte naam conform de norm ISO 639-1

Herziene versie

NL Handboek van Methoden 01/20

Uitvoering van de meting

Uitvoering van de bepaling Zuurcapaciteit $K_{s4,3}$ met tablet

De methode in het apparaat selecteren.

Voor deze methode moet bij de volgende apparaten geen nulmeting worden uitgevoerd:
XD 7000, XD 7500



Spoelbakje van 24 mm met **10 ml staal** vullen.

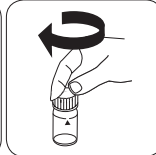

De spoelbakjes afsluiten.

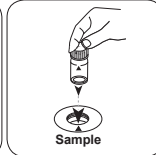

Het **staalspoelbakje** in de meetschacht plaatsen. Op de positionering letten.

• • •

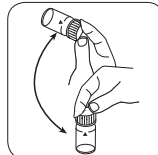

Tabletten oplossen door om te draaien

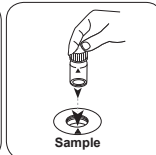

Het **staalspoelbakje** in de meetschacht plaatsen. Op de positionering letten.



De toets **TEST** (XD: **START**) indrukken.

De display toont het resultaat als Zuurcapaciteit $K_{s4,3}$.



Chloor HR (KI) T

M105

5 - 200 mg/L Cl₂

CLHr

Al / Zuur

NL

Reagentia

Benodigd materiaal (deels optioneel):

Reagentia	Verpakkingseenheid	Bestelnr.
Chloor HR (KI)	Tablet / 100	513000BT
Chloor HR (KI)	Tablet / 250	513001BT
Acidifying GP	Tablet / 100	515480BT
Acidifying GP	Tablet / 250	515481BT
Set chloor HR (KI)/Acidifying GP#	per 100	517721BT
Set chloor HR (KI)/Acidifying GP#	per 250	517722BT
Chloor HR (KI)	Tablet / 100	501210
Chloor HR (KI)	Tablet / 250	501211

Uitvoering van de bepaling Chloor HR (KI) met tablet

De methode in het apparaat selecteren.

Voor deze methode hoeft niet elke keer een nulmeting uitgevoerd te worden op de volgende apparaten: XD 7000, XD 7500

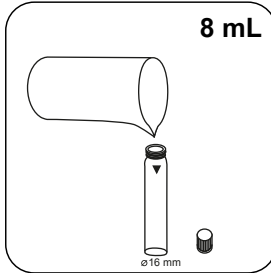

Spoelbakje van 16 mm met **8 mL** staal vullen.

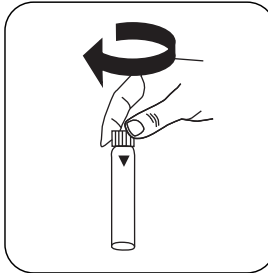

De spoelbakjes afsluiten.

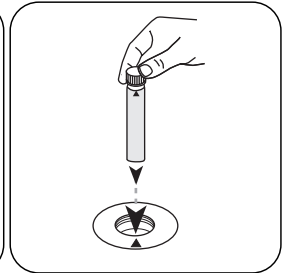

Het **staal**spoelbakje in de meetschacht plaatsen. Op de positionering letten.

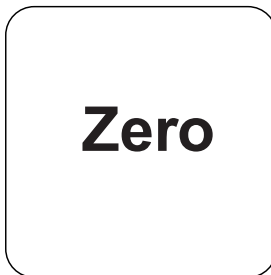

De toets **NUL** indrukken.

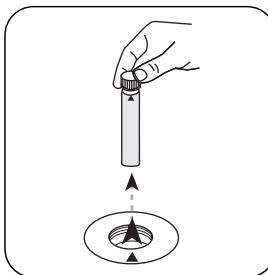

Het **spoelbakje** uit de meetschacht nemen.

Bij apparaten die **geen nulmeting** vereisen, **hier beginnen**.

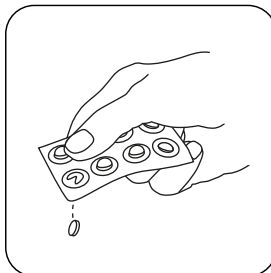

Een **Chloor HR (KI)** tablet toevoegen.

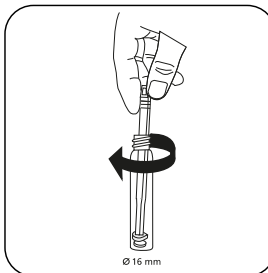

De tabletten onder lichte rotatie verpletteren.

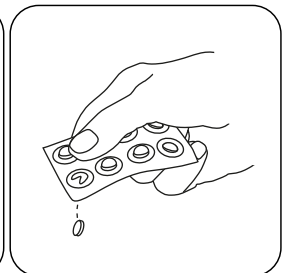

Een **ACIDIFYING GP** tablet toevoegen.

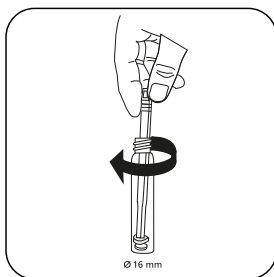

De tabletten onder lichte rotatie verpletteren.

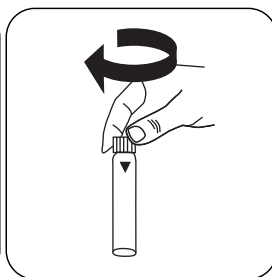

De spoelbakjes afsluiten.

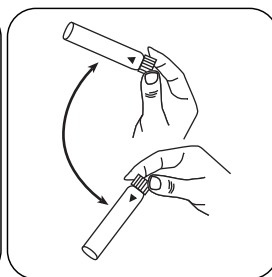

Tabletten oplossen door om te draaien

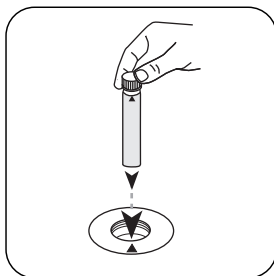

Het **staal**spoelbakje in de meetschacht plaatsen. Op de positionering letten.

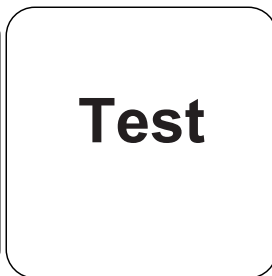

De toets **TEST** (XD: **START**) indrukken.

De display toont het resultaat in mg/L Chloor.

Chemische methode

Al / Zuur

Aanhangsel

Verstoringen

Permanente verstoringen

- Alle oxidatiemiddelen in de monsters reageren als chloor, wat tot extra resultaten leidt.

Validatie van de methodes

Aantoonbaarheidsgrens	1.29 mg/L
Bepaalbaarheidsgrens	3.86 mg/L
Einde meetbereik	200 mg/L
Gevoeligheid	83.96 mg/L / Abs
Betrouwbaarheidsgrenzen	1.14 mg/L
Standaardafwijking procedure	0.45 mg/L
Variatiecoëfficiënt procedure	0.45 %

Afgeleid van

EN ISO 7393-3

* met inbegrip van de mengstaaf

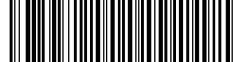

Hypochloriet T

M212

0.2 - 16 % NaOCI

Kaliumjodide

NL

Reagentia

Benodigd materiaal (deels optioneel):

Reagentia	Verpakkingseenheid	Bestelnr.
Acidifying GP	Tablet / 100	515480BT
Acidifying GP	Tablet / 250	515481BT
Chloor HR (KI)	Tablet / 100	513000BT
Chloor HR (KI)	Tablet / 250	513001BT
Chloor HR (KI)	Tablet / 100	501210
Chloor HR (KI)	Tablet / 250	501211
Set chloor HR (KI)/Acidifying GP [#]	per 100	517721BT
Set chloor HR (KI)/Acidifying GP [#]	per 250	517722BT
Verduunningsset natriumhypochloriet	1 St.	414470

Aantekeningen

1. Deze methode biedt de mogelijkheid van een eenvoudige sneltest die ter plaatse kan worden uitgevoerd en is daarom niet zo nauwkeurig als een vergelijkbare laboratoriummethode.
2. Als de beschreven procedure strikt wordt gevolgd, kan een nauwkeurigheid van ± 1 gewichtsprocent worden bereikt.

Uitvoering van de bepaling Natriumhypochloriet met tablet

De methode in het apparaat selecteren.

Voor deze methode hoeft niet elke keer een nulmeting uitgevoerd te worden op de volgende apparaten: XD 7000, XD 7500

Het staal wordt 2000 keer verdund:

1. Een spuit van 5 mL eerst met de te onderzoeken oplossing uitspoelen en vervolgens tot aan de markering van 5 mL vullen.
2. De spuit in een maatbeker van 100 mL ledigen.
3. De maatbeker tot aan de markering van 100 mL met chloorvrij water vullen.
4. De inhoud mengen door te roeren.
5. Een propere spuit van 5 mL tot aan de markering van 1 mL met de verdunde oplossing vullen.
6. De spuit in een propere maatbeker van 100 mL vullen.
7. De maatbeker tot aan de markering van 100 mL met chloorvrij water vullen.
8. De inhoud mengen door te roeren.

De test wordt met deze oplossing uitgevoerd.



Spoelbakje van 24 mm met **10 mL voorbereid staal** vullen.

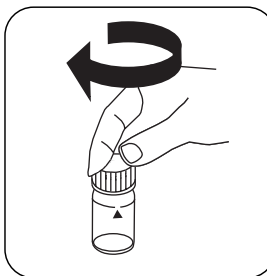

De spoelbakjes afsluiten.

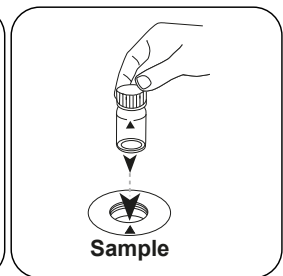

Het **staal**spoelbakje in de meetschacht plaatsen. Op de positionering letten.

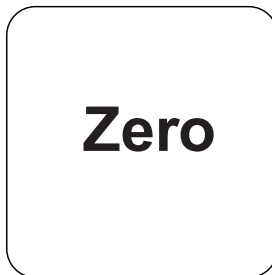

De toets **NUL** indrukken.

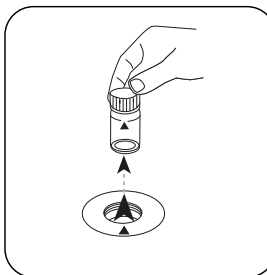

Het spoelbakje uit de meetschacht nemen.

Bij apparaten die **geen nulmeting** vereisen, **hier beginnen**.

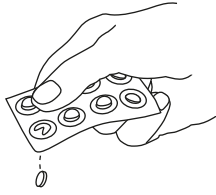

Een CHLORINE HR (KI) tablet toevoegen.



De tabletten onder lichte rotatie verpletteren.

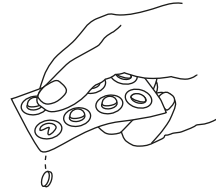

Een ACIDIFYING GP tablet toevoegen.



De tabletten onder lichte rotatie verpletteren.

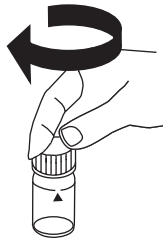

De spoelbakjes afsluiten.

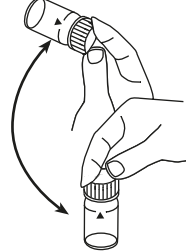

Tabletten oplossen door om te draaien

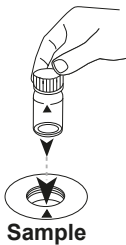

Sample

Test

Het **staalspoelbakje** in de meetschacht plaatsen. Op de positionering letten.

De toets **TEST (XD: START)** indrukken.

De display toont het gehalte werkzaam chloor in gewichtsprocent (w/w %) met betrekking tot de **onverdunde** natriumhypochlorideoplossing.



Chemische methode

Kaliumjodide

Aanhangsel

Validatie van de methodes

Aantoonbaarheidsgrens	0.03 %
Bepaalbaarheidsgrens	0.1 %
Einde meetbereik	16.8 %
Gevoeligheid	9.21 % / Abs
Betrouwbaarheidsgrenzen	0.12 %
Standaardafwijking procedure	0.05 %
Variatiecoëfficiënt procedure	0.55 %

Afgeleid van

EN ISO 7393-3

* met inbegrip van de mengstaaf

NL

KS4.3 T / 20

Yöntem Adı

Yöntemleri numarası

Yöntemi tanımak için barkod

Ölçüm aralığı

Kimyasal Metod

$K_{S4.3} T$
0.1 - 4 mmol/l $K_{S4.3}$
Asit / Gösterge

20
S:4.3

Ekrandaki: MD
100 MD 110 / MD
200

Enstrümana özel bilgi

Test, aşağıdaki cihazlarda gerçekleştirilebilir. Ek olarak, gerekli küvet ve fotometrenin emilim aralığı belirtilmiştir.

Cihazlar	Küvet	λ	Ölçüm Aralığı
MD 200, MD 600, MD 610, MD 640, MultiDirect, PM 620, PM 630	ø 24 mm	610 nm	0.1 - 4 mmol/l $K_{S4.3}$
SpectroDirect, XD 7000, XD 7500	ø 24 mm	615 nm	0.1 - 4 mmol/l $K_{S4.3}$

Malzeme

Gerekli materyal (kısmen isteğe bağlı):

Başlık	Paketleme Birimi	Ürün No
Alka-M-Photometer	Tablet / 100	513210BT
Alka-M-Photometer	Tablet / 250	513211BT

Uygulama Listesi

- Atık Su Arıtma
- İçme Suyu Arıtma
- Ham Su Arıtma

Notlar

1. Alkalite-m, m değeri, toplam alkalite ve asit kapasitesi $K_{S4.3}$ kavramları ayrıdır.
2. 10 ml'lik numune hacmine tam riayet edilmesi, analiz sonucunun doğruluğu bakımından önemlidir.

Dil kodları ISO
639-1

Revizyon durumu

TR Metotlar Kılavuzu 01/20

Testin uygulanması
Tespitin uygulanması Tabletli asit kapasitesi $K_{S4,3}$

Cihazda metot seçin.

Bu metot için şu cihazlarda ZERO ölçümü yapılması gerekmez: XD 7000, XD 7500



24 mm'lik küveti **10 ml numune** ile doldurun.



Küveti(küvetleri) kapatın.

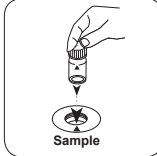

Numune küvetini ölçüm haznesine koyun. Doğru konumlandırılmasına dikkat edin.

• • •

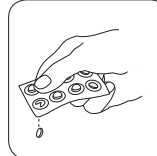

ALKA-M-PHOTOMETER tablet ilave edin.

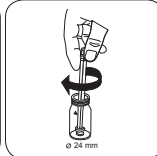

Tableti(tabletleri) hafifçe döndürerek ezin.

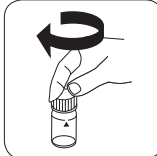

Küveti(küvetleri) kapatın.

**Klor HR (KI) T****M105****5 - 200 mg/L Cl₂****CLHr****KI / Asit****Malzeme**

TR

Gerekli materyal (kısmen isteğe bağlı):

Ayırçalar	Paketleme Birimi	Ürün No
Klor HR (KI)	Tablet / 100	513000BT
Klor HR (KI)	Tablet / 250	513001BT
Asitleştiren GP	Tablet / 100	515480BT
Asitleştiren GP	Tablet / 250	515481BT
Set klor HR (KI)/asitleştiren GP#	her bir 100	517721BT
Set klor HR (KI)/asitleştiren GP#	her bir 250	517722BT
Klor HR (KI)	Tablet / 100	501210
Klor HR (KI)	Tablet / 250	501211

Tespitin uygulanması Tabletli klor HR (KI)

Cihazda metot seçin.

Bu yöntem için, aşağıdaki cihazlarda her seferinde SIFIR ölçümünün yapılması gerekmez: XD 7000, XD 7500

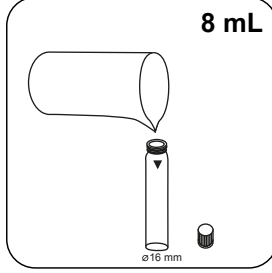

16 mm'lik küveti **8 mL numune** ile doldurun.

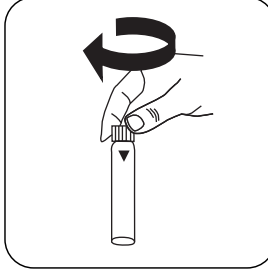

Küveti(küvetleri) kapatın.

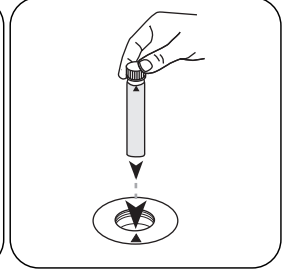

Numune küvetini ölçüm haznesine koyun. Doğru konumlandırılmasına dikkat edin.

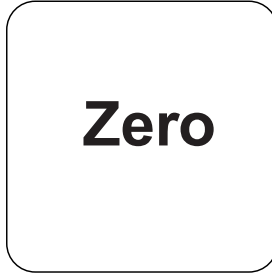

ZERO tuşuna basın.

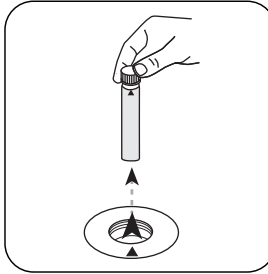

Küveti ölçüm haznesinden alın.

ZERO ölçümü gerektirmeyen cihazlarda buradan başlayın.

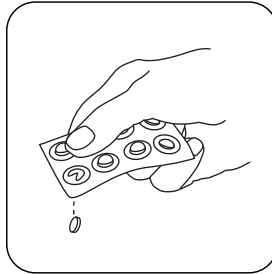

Chlorine HR (KI) tablet ilave edin.

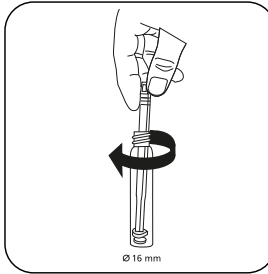

Tableti(tabletleri) hafifçe döndürerek ezin.

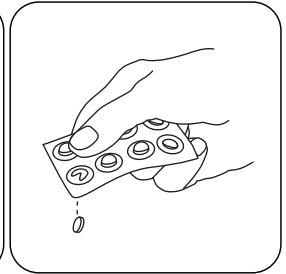

ACIDIFYING GP tablet ilave edin.

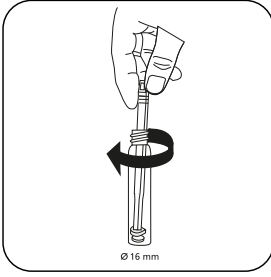

Tableti(tabletleri) hafifçe döndürerek ezin.

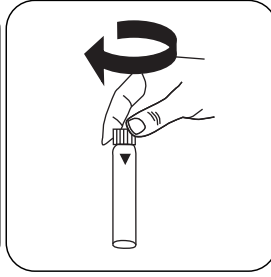

Küveti(küvetleri) kapatın.

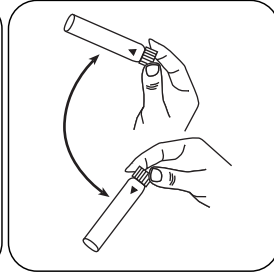

Tableti(tabletleri) sallayarak çözündürün.

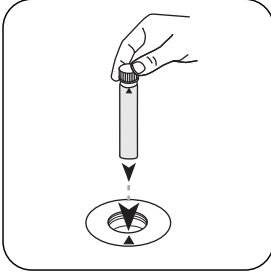

Numune küvetini ölçüm haznesine koyun. Doğru konumlandırılmasına dikkat edin.

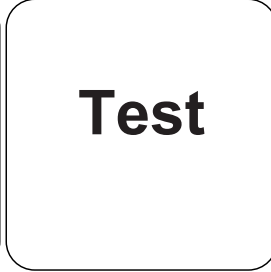

TEST (XD: **START**) tuşuna basın.

Ekranda sonuç mg/L klor cinsinden belirir.

Kimyasal Metod

KI / Asit

Apandis

Girişim Metni

TR

Kalıcı Girişimler

- Numunelerde bulunan tüm oksidasyon malzemeleri tıpkı klor gibi tepkime verir ve bu da fazla miktarda bulguya sebep olur.

Yöntem Doğrulama

Algılama Limiti	1.29 mg/L
Belirleme Limiti	3.86 mg/L
Ölçüm Aralığı Sonu	200 mg/L
Hassasiyet	83.96 mg/L / Abs
Güven Aralığı	1.14 mg/L
Standart Sapma	0.45 mg/L
Varyasyon Katsayısı	0.45 %

Elde edilen

EN ISO 7393-3

* karıştırma çubuğu dahil



Hipoklorit T

M212

0.2 - 16 % NaOCl

Potasyum İyodid

Malzeme

Gerekli materyal (kısmen isteğe bağlı):

Ayırıcılar	Paketleme Birimi	Ürün No
Asitleştiren GP	Tablet / 100	515480BT
Asitleştiren GP	Tablet / 250	515481BT
Klor HR (KI)	Tablet / 100	513000BT
Klor HR (KI)	Tablet / 250	513001BT
Klor HR (KI)	Tablet / 100	501210
Klor HR (KI)	Tablet / 250	501211
Set klor HR (KI)/asitleştiren GP#	her bir 100	517721BT
Set klor HR (KI)/asitleştiren GP#	her bir 250	517722BT
Sodyum hipoklorit seyreltme seti	1 adetler	414470

Notlar

1. Bu metot yerinde yapılabilecek basit bir hızlı test seçeneği sunar ve bundan dolayı mukayese edilebilir bir laboratuvar metodu kadar kesin değildir.
2. Açıklanan yöntem şekline tam olarak riayet edilmesi durumunda ± 1 ağı. %'si doğruluğuna ulaşılabilir.

Tespitin uygulanması Tabletli sodyum hipoklorit

Cihazda metot seçin.

Bu yöntem için, aşağıdaki cihazlarda her seferinde SIFIR ölçümünün yapılması gerekmez: XD 7000, XD 7500

Numune 2000 kat seyreltilir:

1. 5 mL'lik enjektörü öncelikle incelenecek çözelti ile yıkayın ve ardından 5 mL işaretine kadar doldurun.
2. Enjektörü 100 mL'lik ölçü kabına boşaltın.
3. Ölçü kabını 100 mL işaretine kadar klorsuz su ile doldurun.
4. İçeriği dairesel hareketlerle karıştırın.
5. 5 mL'lik temiz enjektörü 1 mL işaretine kadar seyreltilmiş çözelti ile doldurun.
6. Enjektörü 100 mL'lik temiz ölçü kabına boşaltın.
7. Ölçü kabını 100 mL işaretine kadar klorsuz su ile doldurun.
8. İçeriği dairesel hareketlerle karıştırın.

Test bu çözelti ile gerçekleştirilir.



24 mm'lik küveti **önceden hazırlanmış 10 mL numune** ile doldurun.

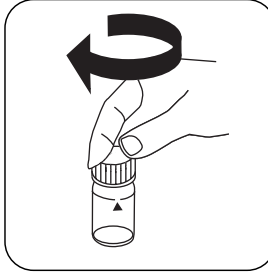

Küveti(küvetleri) kapatın.

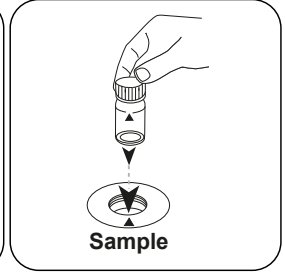

Numune küvetini ölçüm haznesine koyun. Doğru konumlandırılmasına dikkat edin.

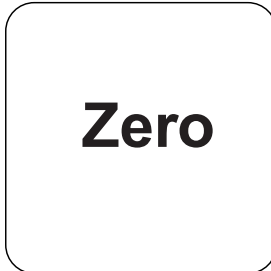

ZERO tuşuna basın.

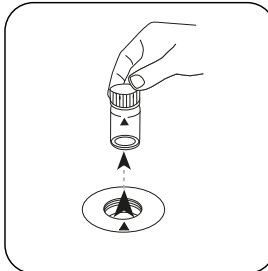

Küveti ölçüm haznesinden alın.

ZERO ölçümü gerektirmeyen cihazlarda buradan başlayın.



CHLORINE HR (KI) tablet ilave edin.

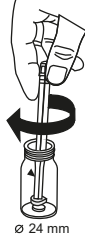

Tableti(tabletleri) hafifçe döndürerek ezin.

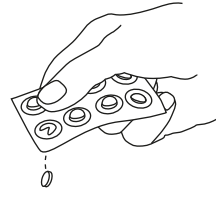

ACIDIFYING GP tablet ilave edin.

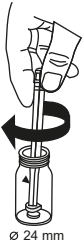

Tableti(tabletleri) hafifçe döndürerek ezin.

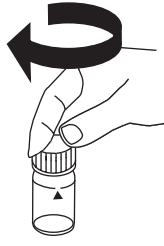

Küveti(küvetleri) kapatın.

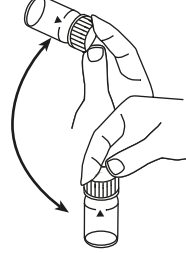

Tableti(tabletleri) sallayarak çözünüz.

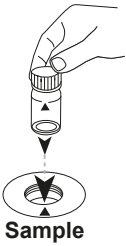

Sample

Numune küvetini ölçüm haznesine koyun. Doğru konumlandırılmasına dikkat edin.

TEST (XD: START) tuşuna basın.

Test

Ekranada **seyreltilmemiş** sodyum hipoklorit çözeltisine oranla ağırlık yüzdesi olarak (%w/w) verilen tesirli klor içeriği belirir.

Kimyasal Metod

Potasyum İyodid

Apendis

Yöntem Doğrulama

Algılama Limiti	0.03 %
Belirleme Limiti	0.1 %
Ölçüm Aralığı Sonu	16.8 %
Hassasiyet	9.21 % / Abs
Güven Aralığı	0.12 %
Standart Sapma	0.05 %
Varyasyon Katsayısı	0.55 %

Elde edilen

EN ISO 7393-3

* karıştırma çubuğu dahil

TR

KS4.3 T / 20



Название метода → KS4.3 T

Номер метода → M20

Штрих-код для распознавания метода → [Barcode]

Диапазон измерений → 0.1 - 4 mmol/l $K_{S4.3}$

Химический метод → Кислота / индикатор

Отображение на дисплее в MD 100 MD 110 / MD 200 → S:4.3

Специфическая информация об инструменте

Тест может быть выполнен на следующих устройствах. Кроме того, указывается требуемая кювета и диапазон поглощения фотометра.

Приборы	Кювета	λ	Диапазон измерений
MD 200, MD 600, MD 610, MD 640, MultiDirect, PM 620, PM 630	ø 24 mm	610 nm	0.1 - 4 mmol/l $K_{S4.3}$
SpectroDirect, XD 7000, XD 7500	ø 24 mm	615 nm	0.1 - 4 mmol/l $K_{S4.3}$

Материал

Необходимый материал (частично необязательный):

Заголовок	Упаковочная единица	Номер заказа
Alka-M-Photometer	Таблетка / 100	513210BT
Alka-M-Photometer	Таблетка / 250	513211BT

Область применения

- Обработка сточных вод
- Подготовка питьевой воды
- Обработка сырой воды

Примечания

1. Термины Щелочность M, m-значение, общая калийность и кислотная сила $K_{S4.3}$ идентичны.
2. Точное соблюдение объема пробы в 10 мл имеет решающее значение для точности результатов анализа.

Сокращенное обозначение языка в соответствии с ISO 639-1 → RU

Статус редакции → 01/20

RU Методическое руководство 01/20

**Выполнение
измерения**
Выполнение определения Кислотная сила $K_{s4.3}$ с таблеткой

Выберите метод в устройстве.

Для этого метода измерения нуля не требуется для следующих устройств: XD 7000, XD 7500



24-Наполните ковеву -мм
10 пробой мл.



Закройте ковеву(ы).

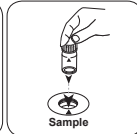

Поместите ковеву для
проб в измерительную
шахту. Обращайте
внимание на
позиционирование.



Растворите таблетку
(таблетки) покачиванием.

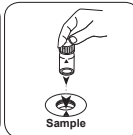

Поместите ковеву для
проб в измерительную
шахту. Обращайте
внимание на
позиционирование.



Нажмите клавишу TEST
(XD: CTAPT).

На дисплее отображается результат в виде Кислотная сила $K_{s4.3}$.

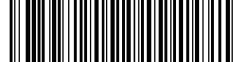

Хлор HR (KI) Т

M105

5 - 200 mg/L Cl₂

CLHr

KI / кислота

Материал

RU

Необходимый материал (частично необязательный):

Реактивы	Упаковочная единица	Номер заказа
хлорины HR (KI)	Таблетка / 100	513000BT
хлорины HR (KI)	Таблетка / 250	513001BT
Acidifying GP	Таблетка / 100	515480BT
Acidifying GP	Таблетка / 250	515481BT
Набор Хлорины HR (KI)/Acidifying GP [#]	100 каждая	517721BT
Набор Хлорины HR (KI)/Acidifying GP [#]	250 каждая	517722BT
хлорины HR (KI)	Таблетка / 100	501210
хлорины HR (KI)	Таблетка / 250	501211

Выполнение определения Хлор HR (KI) с таблеткой

Выберите метод в устройстве.

Для этого метода необязательно проводить измерение НУЛЯ каждый раз на следующих устройствах: XD 7000, XD 7500

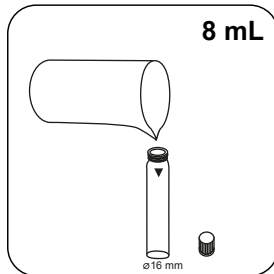

16-Наполните кювету -мм
8 пробой мл.

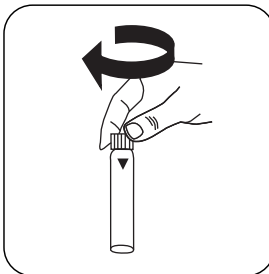

Закройте кювету(ы).

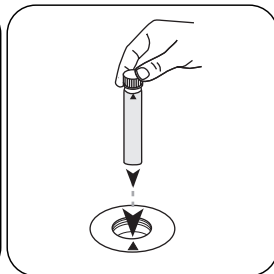

Поместите **кювету для проб** в измерительную шахту. Обращайте внимание на позиционирование.

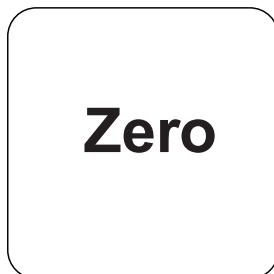

Нажмите клавишу **НОЛЬ**.

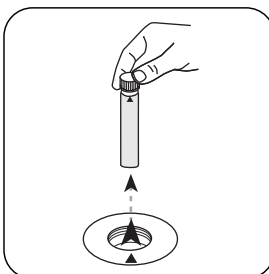

Извлеките **кювету** из измерительной шахты.

Для приборов, для которых не требуется **измерение нулевого значения**, **начните отсюда**.

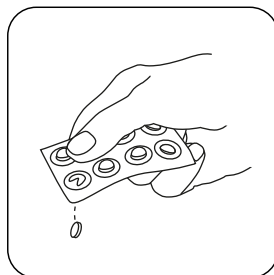

Добавить **таблетку Chlorine HR (KI)**.

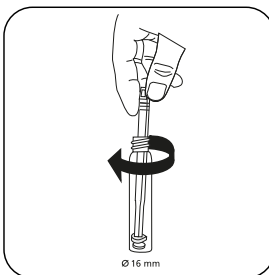

Раздавите таблетку (таблетки) легким вращением.

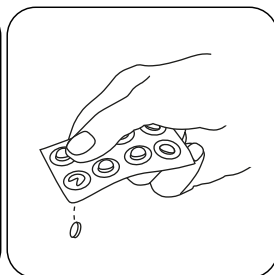

Добавить **таблетку ACIDIFYING GP**.

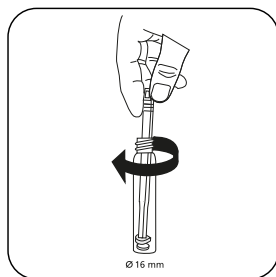

Раздавите таблетку (таблетки) легким вращением.

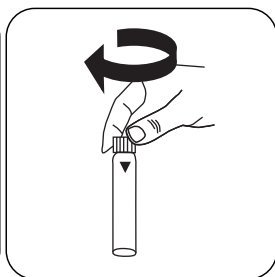

Закройте кювету(ы).

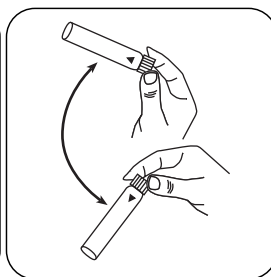

Растворите таблетку (таблетки) покачиванием.

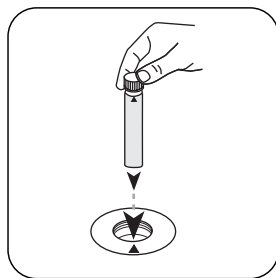

Поместите **кювету для проб** в измерительную шахту. Обращайте внимание на позиционирование.

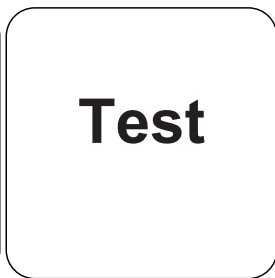

Нажмите клавишу **ТЕСТ** (XD: **СТАРТ**).

На дисплее отображается результат в мг/л Хлор.

Химический метод

KI / кислота

Приложение

Нарушения

Постоянные нарушения

- Все оксидационные средства, присутствующие в пробах, реагируют как хлор, что приводит к повышенным результатам.

Проверка метода

Предел обнаружения	1.29 mg/L
Предел детерминации	3.86 mg/L
Конечное значение диапазона измерений	200 mg/L
Восприимчивость	83.96 mg/L / Abs
Доверительная область	1.14 mg/L
Среднеквадратическое отклонение процесса	0.45 mg/L
Коэффициент вариации метода	0.45 %

Выведено из

EN ISO 9963-1

* в комплект входит палочка для перемешивания

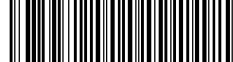

Гипохлорит Т

M212

0.2 - 16 % NaOCl

Йодид калия

Материал

RU

Необходимый материал (частично необязательный):

Реактивы	Упаковочная единица	Номер заказа
Acidifying GP	Таблетка / 100	515480BT
Acidifying GP	Таблетка / 250	515481BT
хлорины HR (KI)	Таблетка / 100	513000BT
хлорины HR (KI)	Таблетка / 250	513001BT
хлорины HR (KI)	Таблетка / 100	501210
хлорины HR (KI)	Таблетка / 250	501211
Набор Хлорины HR (KI)/Acidifying GP [#]	100 каждая	517721BT
Набор Хлорины HR (KI)/Acidifying GP [#]	250 каждая	517722BT
Набор для разбавления гипохлорита натрия	1 Шт.	414470

Примечания

1. Этот метод дает возможность проведения простого быстрого теста на месте, поэтому он не так точен, как аналогичный лабораторный метод.
2. При строгом соблюдении описанной процедуры может быть достигнута точность $\pm 1\%$ по весу.

Выполнение определения Гипохлорит натрия с таблеткой

Выберите метод в устройстве.

Для этого метода необязательно проводить измерение НУЛЯ каждый раз на следующих устройствах: XD 7000, XD 7500

Проба разводится в пропорции 2000:

1. Сначала промойте 5 мл шприца раствором для тестирования, а затем наполните его до отметки 5 мл.
2. Опорожните шприц в мерную чашку емкостью 100 мл.
3. Наполните мерную чашку до отметки 100 мл бесхлорной водой.
4. Содержимое взболтать и перемешать.
5. Наполните чистый шприц 5 мл до отметки 1 ml разбавленным раствором.
6. Опорожните шприц в чистый мерный стаканчик 100 мл.
7. Наполните мерную чашку до отметки 100 мл бесхлорной водой.
8. Содержимое взболтать и перемешать.

Тестирование проводится с помощью этого раствора.

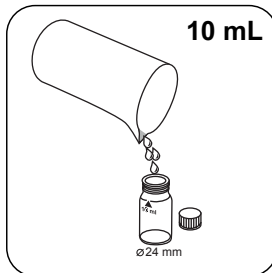

Наполните кювету 24-мм **10 мл подготовленной пробы**.

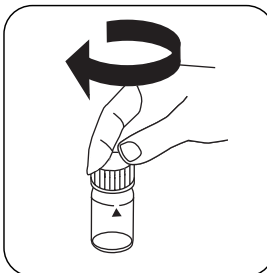

Закройте кювету(ы).

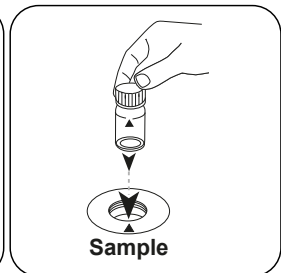

Поместите **кювету для проб** в измерительную шахту. Обращайте внимание на позиционирование.

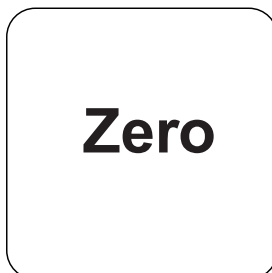

Нажмите клавишу **НОЛЬ**. Извлеките кювету из измерительной шахты.

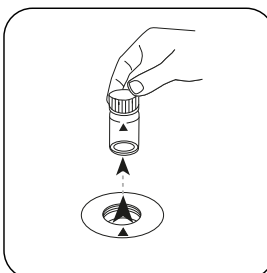

Для приборов, для которых не требуется **измерение нулевого значения**, начните отсюда.



RU

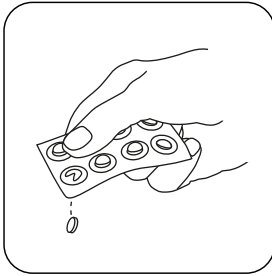

Добавить **таблетку CHLORINE HR (KI)**.

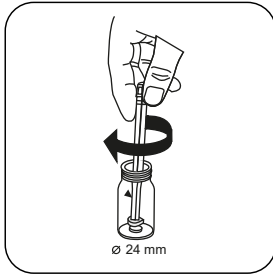

Раздавите таблетку (таблетки) легким вращением.

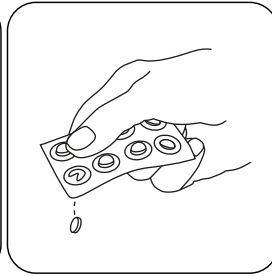

Добавить **таблетку ACIDIFYING GP**.

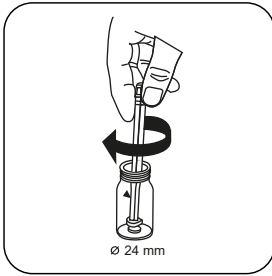

Раздавите таблетку (таблетки) легким вращением.

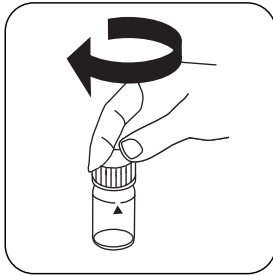

Закройте кювету(ы).

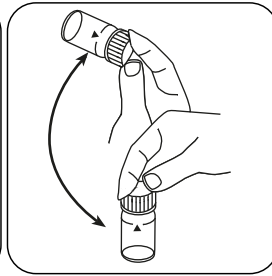

Растворите таблетку (таблетки) покачиванием.

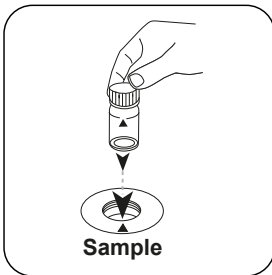

Поместите **кювету для проб** в измерительную шахту. Обращайте внимание на позиционирование.

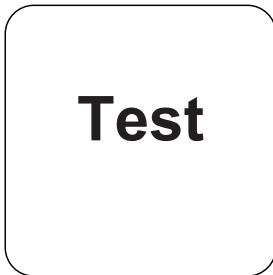

Нажмите клавишу **ТЕСТ (XD: СТАРТ)**.

На дисплее отображается содержание эффективного хлора в процентах веса (вес/вес в %) относительно **неразбавленного** раствора гипохлорита натрия.



Химический метод

Йодид калия

Приложение

Проверка метода

Предел обнаружения	0.03 %
Предел детерминации	0.1 %
Конечное значение диапазона измерений	16.8 %
Восприимчивость	9.21 % / Abs
Доверительная область	0.12 %
Среднеквадратическое отклонение процесса	0.05 %
Коэффициент вариации метода	0.55 %

Выведено из

EN ISO 7393-3

* в комплект входит палочка для перемешивания

RU

KS4.3 T / 20

方法名称

方法号

用于方法检测的条形码

测量范围

酸性 / 指示剂

屏幕显示: MD 100 / MD 110 / MD 200

化学方法

仪器的具体信息

测试可以在以下设备上执行。此外还指出了所需的比色杯和光度计的吸光范围。

仪器类型	比色皿	λ	测量范围
MD 200, MD 600, MD 610, MD 640, MultiDirect, PM 620, PM 630	\varnothing 24 mm	610 nm	0.1 - 4 mmol/l $K_{S4.3}$
SpectroDirect, XD 7000, XD 7500	\varnothing 24 mm	615 nm	0.1 - 4 mmol/l $K_{S4.3}$

材料

所需材料 (部分可选) :

标题	包装单位	货号
Alka-M-Photometer	片剂 / 100	513210BT
Alka-M-Photometer	片剂 / 250	513211BT

应用列表

- 污水处理
- 饮用水处理
- 原水处理

备注

1. 术语碱度-m、m-值、总碱度和酸容量 $K_{S4.3}$ 是相同的。
2. 准确地遵守 10 ml 的样本体积对分析结果的准确度至关重要。

语言代码ISO 639-1

修订状态

CN 方法手册 01/20

开始测量

进行测定 $K_{s4.3}$ 片剂酸容量

选择设备中的方法。

对于这种方法，在以下设备上不能进行 ZERO 测量：XD 7000, XD 7500

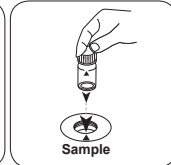
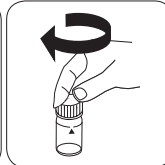
用 10 ml 样本填充 24 mm 比密封比色杯。
色杯。将样本比色杯放入测量轴
中。注意定位。

• • •

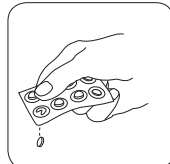
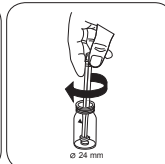
加入 ALKA-M-PHOTOME-
TER 片剂。

用轻微的扭转压碎片剂。

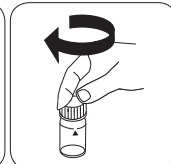

密封比色杯。

CN 方法手册 01/20

ZH



HR (KI) T 氯

M105

5 - 200 mg/L Cl₂

CLHr

碘化钾 / 酸法

材料

所需材料 (部分可選) :

ZH

试剂	包装单位	货号
氯 HR (KI)	片剂 / 100	513000BT
氯 HR (KI)	片剂 / 250	513001BT
酸化 GP	片剂 / 100	515480BT
酸化 GP	片剂 / 250	515481BT
套件氯 HR (KI)/酸化 GP#	各100次	517721BT
套件氯 HR (KI)/酸化 GP#	各250次	517722BT
氯 HR (KI)	片剂 / 100	501210
氯 HR (KI)	片剂 / 250	501211

进行测定 HR (KI) 氯片剂

选择设备中的方法。

对于此方法，不必每次都在以下设备上上进行零测量：XD 7000, XD 7500

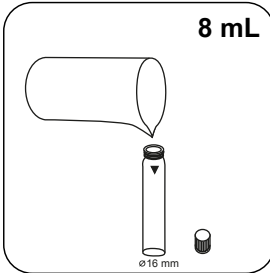

用 8 mL 样本填充 16 mm 比色杯。

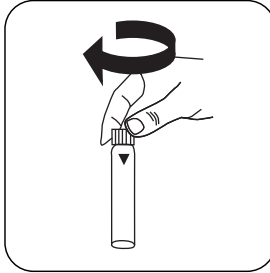

密封比色杯。

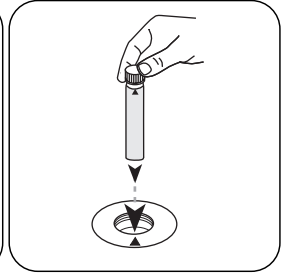

将样本比色杯放入测量轴中。注意定位。



按下 ZERO 按钮。

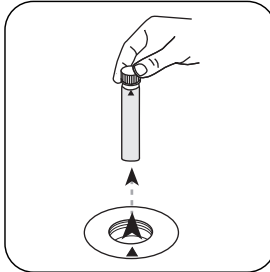

从测量轴上取下比色杯。

对于不需要 ZERO 测量的设备，从这里开始。

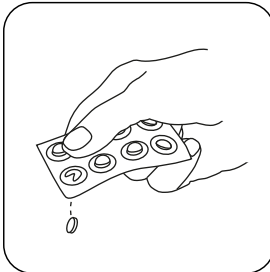

加入 Chlorine HR (KI) 片剂。

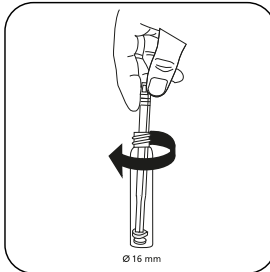

用轻微的扭转压碎片剂。

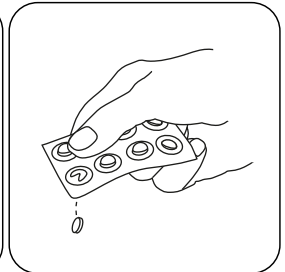

加入 ACIDIFYING GP 片剂。



ZH

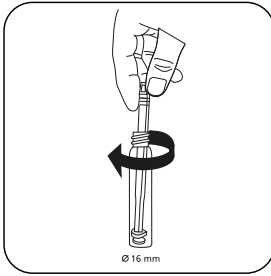

用轻微的扭转压碎片剂。

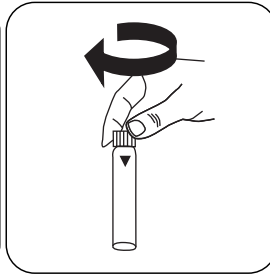

密封比色杯。

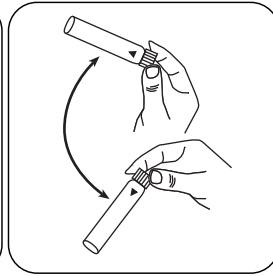

通过旋转溶解片剂。

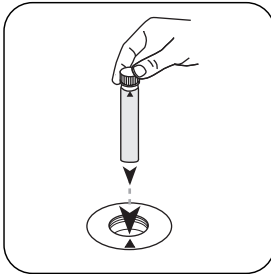

将样本比色杯放入测量轴中。注意定位。

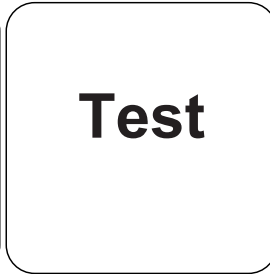

按下 **TEST (XD: START)** 按钮。

结果在显示屏上显示为 mg / l 氯。

化学方法

碘化钾 / 酸法

附錄

干扰说明

持续干扰

- 存在于样本中的所有氧化剂都像氯一样反应，导致多重结果。

方法验证

检出限	1.29 mg/L
测定下限	3.86 mg/L
测量上限	200 mg/L
灵敏度	83.96 mg/L / Abs
置信范围	1.14 mg/L
标准偏差	0.45 mg/L
变异系数	0.45 %

源于

EN ISO 7393-3

*i含搅拌棒, 10cm



T 次氯酸盐

M212

0.2 - 16 % NaOCl

碘化钾

材料

所需材料 (部分可选) :

ZH

试剂	包装单位	货号
酸化 GP	片剂 / 100	515480BT
酸化 GP	片剂 / 250	515481BT
氯 HR (KI)	片剂 / 100	513000BT
氯 HR (KI)	片剂 / 250	513001BT
氯 HR (KI)	片剂 / 100	501210
氯 HR (KI)	片剂 / 250	501211
套件氯 HR (KI)/酸化 GP#	各100次	517721BT
套件氯 HR (KI)/酸化 GP#	各250次	517722BT
次氯酸钠稀释套件	1 片	414470

备注

1. 这种方法提供了一个简单的快速测试的可能性，可以在现场进行，因而不如类似的实验室方法准确。
2. 严格遵守所述的操作方法时，可达到 $\pm 1\%$ 的准确度。

进行测定 次氯酸钠片剂

选择设备中的方法。

对于此方法，不必每次都在以下设备上上进行零测量：XD 7000, XD 7500

样本稀释 2000 倍：

1. 首先用待测溶液冲洗 5 mL 注射器，然后注入至 5 mL 刻度处。
2. 将注射器注入 100 mL 量杯中。
3. 用无氯水将量杯填充至 100 mL 刻度处。
4. 搅拌混合内容物。
5. 将稀释溶液注入到干净的 5 mL 注射器中至 1 mL 刻度处。
6. 将注射器注入到干净的 100 mL 量杯中。
7. 用无氯水将量杯填充至 100 mL 刻度处。
8. 搅拌混合内容物。

用该溶液进行测试。

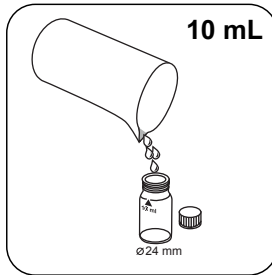

用 10 mL 准备好的样本填充 24 mm 比色杯。

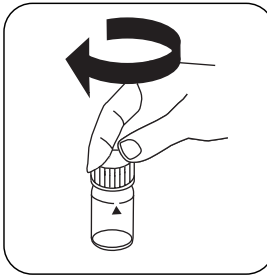

密封比色杯。

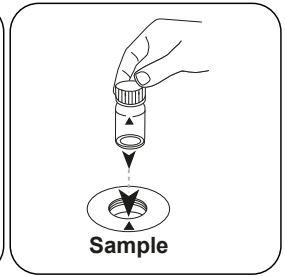

将样本比色杯放入测量轴中。注意定位。

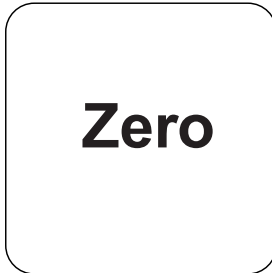

按下 **ZERO** 按钮。

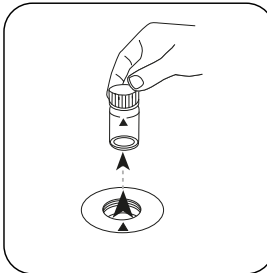

从测量轴上取下比色杯。

对于不需要 **ZERO** 测量的设备，从这里开始。



ZH

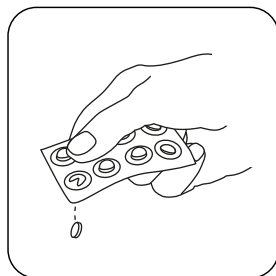

加入 **CHLORINE HR (KI)** 片剂。

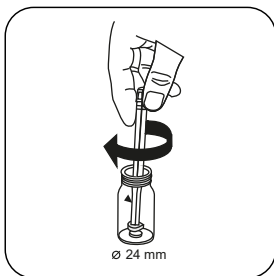

用轻微的扭转压碎片剂。

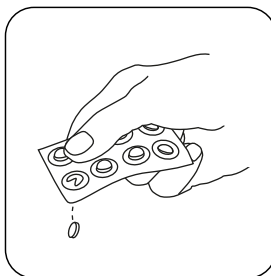

加入 **ACIDIFYING GP** 片剂。

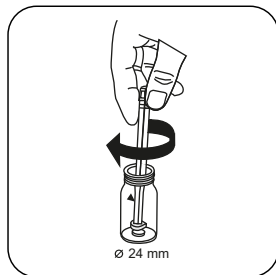

用轻微的扭转压碎片剂。

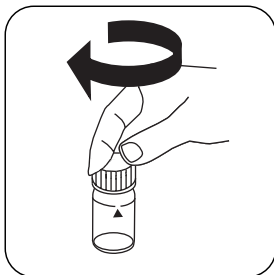

密封比色杯。

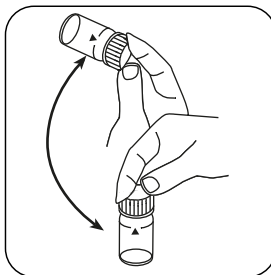

通过旋转溶解片剂。

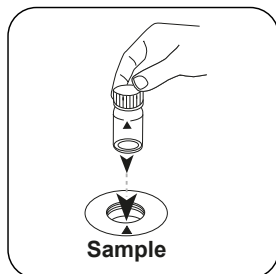

将样本比色杯放入测量轴中。注意定位。

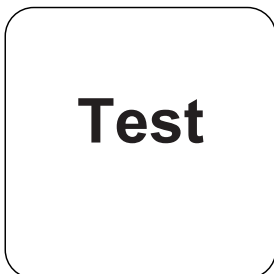

按下 **TEST (XD: START)** 按钮。

显示屏显示相对于未稀释的次氯酸钠溶液的有效氯含量 (w/w %) 。



化学方法

碘化钾

附錄

方法验证

检出限	0.03 %
测定下限	0.1 %
测量上限	16.8 %
灵敏度	9.21 % / Abs
置信范围	0.12 %
标准偏差	0.05 %
变异系数	0.55 %

源于

EN ISO 7393-3

*i含搅拌棒, 10cm

ZH

Tintometer GmbH

Lovibond® Water Testing
Schleefstraße 8-12
44287 Dortmund
Tel.: +49 (0)231/94510-0
sales@lovibond.com
www.lovibond.com
Germany

Tintometer South East Asia

Unit B-3-12, BBT One Boulevard,
Lebuhr Nilam 2, Bandar Bukit Tinggi,
Klang, 41200, Selangor D.E
Tel.: +60 (0)3 3325 2285/6
Fax: +60 (0)3 3325 2287
lovibond.asia@tintometer.com
www.lovibond.com
Malaysia

Tintometer India Pvt. Ltd.

Door No: 7-2-C-14, 2nd, 3rd & 4th Floor
Sanathnagar Industrial Estate,
Hyderabad, 500018
Telangana
Tel: +91 (0) 40 23883300
Toll Free: 1 800 599 3891/ 3892
indiaoffice@lovibond.in
www.lovibondwater.in
India

The Tintometer Limited

Lovibond House
Sun Rise Way
Amesbury, SP4 7GR
Tel.: +44 (0)1980 664800
Fax: +44 (0)1980 625412
sales@lovibond.uk
www.lovibond.com
UK

Tintometer Brazil

Caixa Postal: 271
CEP: 13201-970
Jundiaí – SP
Tel.: +55 (11) 3230-6410
sales@lovibond.us
www.lovibond.com.br
Brazil

Tintometer Spain

Postbox: 24047
08080 Barcelona
Tel.: +34 661 606 770
sales@tintometer.es
www.lovibond.com
Spain

Tintometer China

9F, SOHO II C.
No.9 Guanghualu,
Chaoyang District,
Beijing, 100020
Customer Care China Tel.: 4009021628
Tel.: +86 10 85251111 Ext. 330
Fax: +86 10 85251001
chinaoffice@tintometer.com
www.lovibond.com
China

Tintometer Inc.

6456 Parkland Drive
Sarasota, FL 34243
Tel: 941.756.6410
Fax: 941.727.9654
sales@lovibond.us
www.lovibond.us
USA



Technical changes without notice
Printed in Germany 08/24

No.: 00386763

Lovibond® and Tintometer® are Trademarks of
the Tintometer Group of Companies

