

Lovibond® Water Testing

Tintometer® Group

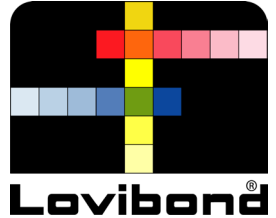

Swab Legionella Field Test™ Kit

This kit is designed to test for Legionella on surfaces and biofilms in risk areas identified by CDC* such as:

- Domestic and industrial hot and cold water systems.
- Cooling towers.
- Decorative fountains, hot tubs and pools.
- Sinks and showers.
- Mistifiers, sprinklers, air washers, humidifiers and others.



Swab Legionella Field Test™ Kit product code 56B006401

*The Centers for Disease Control and Prevention (CDC) is a federal agency that conducts and supports health promotion, prevention and preparedness activities in the United States, with the aim of improving overall public health.

The test contains all the items required to perform 5 tests.

- The test detects Legionella pneumophila serogroup 1 (LpSG1).
- The sensitivity of this test is 200 CFU per swabbed area.
- The test detects Viable-But-Non-Culturable Bacteria and Legionella SG1 in all stages of its life-cycle.
- No need to measure or dilute solutions.
- The test is simple to use, no interpretation is required.
- Provides straightforward results, on-site, within 25–35 minutes.
- The test helps to minimise delays and downtime.
- Regular use increases confidence in Legionella controls.
- The smartphone App reader provides independent record of results (download the App for free from the App store or Play Store).

The Lovibond® Legionella Field Test™ uses Lateral Flow Immunochromatographic Assay (LFICA) technology to detect the presence of cell surface antigens from Legionella bacteria. It uses Legionella antibodies, tagged with red nanoparticles, which bind to any bacteria found in the sample and make them visible on a line on the device. The test works just like a pregnancy test - one line indicates a negative result and two lines indicate a positive result.

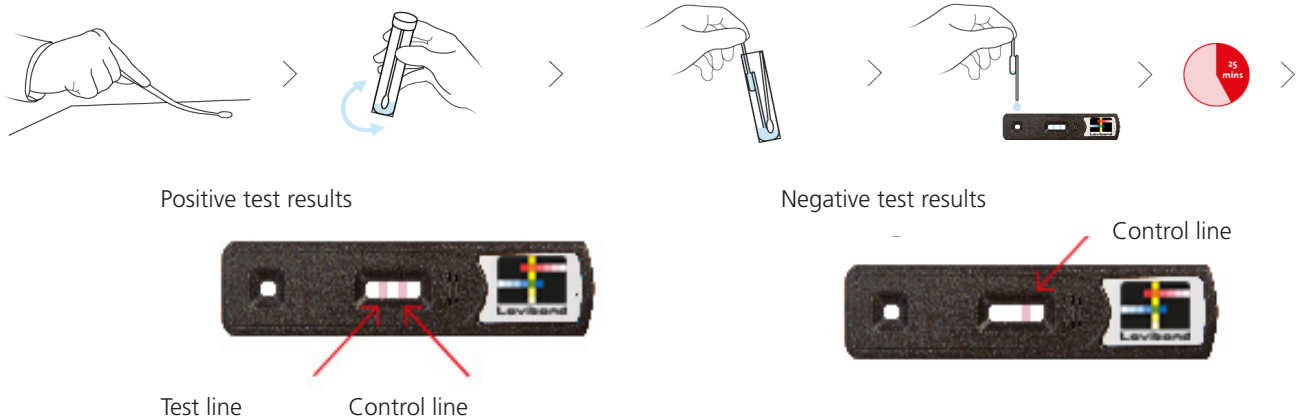

Lovibond® Water Testing

Tintometer® Group



Swab Legionella Field Test™ Kit

Bacteria detected	<i>Legionella pneumophila</i> serogroup 1										
Detection method	Lateral flow immunochromatographic assay										
Limit of detection	200 CFU per swabbed area										
Specificity	<p>Tested against a wide range of waterborne bacteria, including <i>Acinetobacter calcoaceticus</i>, <i>Aeromonas hydrophila</i> subsp. <i>hydrophila</i>, <i>Bacillus subtilis</i>, <i>Burkholderia cepacia</i>, <i>Citrobacter freundii</i>, <i>Citrobacter koseri</i>, <i>Escherichia coli</i>, <i>Enterobacter cloacae</i>, <i>Klebsiella oxytoca</i>, <i>Pseudomonas aeruginosa</i>, <i>Pseudomonas fluorescens</i>, <i>Pseudomonas putida</i>, <i>Pseudomonas stutzeri</i>, <i>Ralstonia pickettii</i>, <i>Raoultella terrigena</i>, <i>Streptococcus pyogenes</i>, <i>Yersinia ruckeri</i>.</p> <table border="1"><thead><tr><th>Organism</th><th>≥cfu/mL</th></tr></thead><tbody><tr><td>L.p Sg-2,3,8,11,13,14</td><td>1.00E+08</td></tr><tr><td>L.p. Sg-4,5,6,7,9,10,15</td><td>1.00E+07</td></tr><tr><td>L.p. Sg-12</td><td>8.00E+06</td></tr><tr><td>S.aureus</td><td>2.00E+08</td></tr></tbody></table> <p>The Lovibond® Legionella pneumophila SG1 test has been shown to produce weak positive results with other legionella pneumophila serogroups at the cfu/mL stated in the above table.</p>	Organism	≥cfu/mL	L.p Sg-2,3,8,11,13,14	1.00E+08	L.p. Sg-4,5,6,7,9,10,15	1.00E+07	L.p. Sg-12	8.00E+06	S.aureus	2.00E+08
Organism	≥cfu/mL										
L.p Sg-2,3,8,11,13,14	1.00E+08										
L.p. Sg-4,5,6,7,9,10,15	1.00E+07										
L.p. Sg-12	8.00E+06										
S.aureus	2.00E+08										
Test Volume	100 µL										
Suggested sample area	10cm ²										
Sample parameters	Resuspension of the bacteria should be done in 2 mL of recovery solution. Shake the tube for at least 20 seconds.										
Biocides	<p>The product has been tested with a range of common biocides and biodispersants used in Legionella control, at their normal maximum operating concentration. Active ingredients tested include: glutaraldehyde, didecyl-dimethyl-ammonium chloride, isothiazoles, dibromonitripropionamide, ionic and non-ionic surfactants.</p> <p>The test gives a false positive if used with systems treated with polymeric biguanide or THPS. It should not be used to test such systems.</p>										
Operator time	5 minutes										
Test time	25 minutes										
Shelf life	18 months from date of manufacture, when stored at room temperature (<30°C) in original packaging. All test strips are hermetically foil-wrapped and with a printed expiry date.										