

Lovibond® Water Testing

Tintometer® Group



Manual of Methods

MD50 • MD150

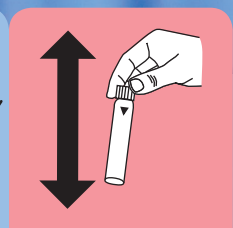

KS4.3 T / 20

Method name

Method number

Bar code for the detection of the methods

Measuring range

20

S:4.3

Chemical Method

Display in the MD 100 / MD 110 / MD 200

Instrument specific information

The test can be performed on the following devices. In addition, the required cuvette and the absorption range of the photometer are indicated.

Instrument Type	Cuvette	λ	Measuring Range
MD 200, MD 600, MD 610, MD 640, MultiDirect, PM 620, PM 630	ø 24 mm	610 nm	0.1 - 4 mmol/l $K_{S4.3}$
SpectroDirect, XD 7000, XD 7500	ø 24 mm	615 nm	0.1 - 4 mmol/l $K_{S4.3}$

Material

Required material (partly optional):

Reagents	Packaging Unit	Part Number
Alka-M-Photometer	Tablet / 100	513210BT
Alka-M-Photometer	Tablet / 250	513211BT

Application List

- Waste Water Treatment
- Drinking Water Treatment
- Raw Water Treatment

Notes

1. The terms Alkalinity-m, m-Value, total alkalinity and Acid demand to $K_{S4.3}$ are identical.
2. For accurate results, exactly 10 ml of water sample must be used for the test.

Language codes ISO 639-1

Revision status

EN Handbook of Methods 01/20

Performing test procedure

Implementation of the provision Acid capacity $K_{S_{4.3}}$ with Tablet

Select the method on the device

For this method, no ZERO measurements are to be carried out with the following devices: XD 7000, XD 7500



Fill 24 mm vial with **10 ml sample**.



Close vial(s).

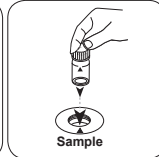

Place **sample vial** in the sample chamber. • Pay attention to the positioning.

• • •



Dissolve tablet(s) by inverting.



Place **sample vial** in the sample chamber. • Pay attention to the positioning.



Press the **TEST** (XD: **START**) button.

The result in Acid Capacity $K_{S_{4.3}}$ appears on the display.



Chlorine HR (KI) T

M105

5 - 200 mg/L Cl₂

CLHr

KI / Acid

Material

EN

Required material (partly optional):

Reagents	Packaging Unit	Part Number
Chlorine HR (KI)	Tablet / 100	513000BT
Chlorine HR (KI)	Tablet / 250	513001BT
Acidifying GP	Tablet / 100	515480BT
Acidifying GP	Tablet / 250	515481BT
Set Chlorine HR (KI)/Acidifying GP 100 Pc. #	100 each	517721BT
Set Chlorine HR (KI)/Acidifying GP 250 Pc. #	250 each	517722BT
Chlorine HR (KI)	Tablet / 100	501210
Chlorine HR (KI)	Tablet / 250	501211

Determination of Chlorine HR (KI) with Tablet

Select the method on the device.

For this method, a ZERO measurement does not have to be carried out every time on the following devices: XD 7000, XD 7500

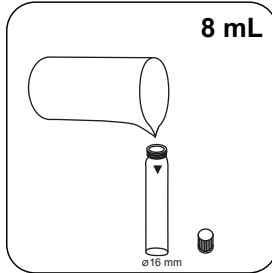

Fill 16 mm vial with **8 mL sample**.

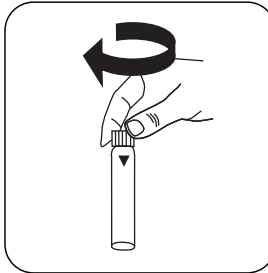

Close vial(s).

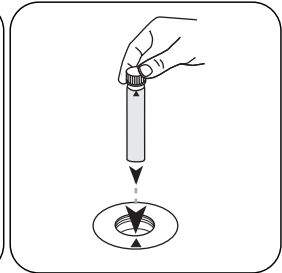

Place **sample vial** in the sample chamber. • Pay attention to the positioning.

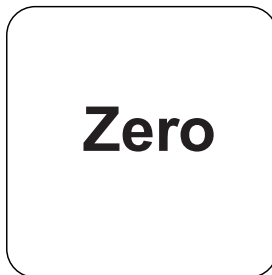

Press the **ZERO** button.

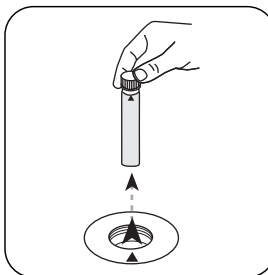

Remove **vial** from the sample chamber.

For devices that require **no ZERO measurement**, start here.

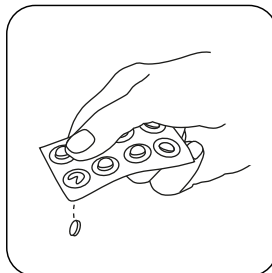

Add **Chlorine HR (KI) tablet**.

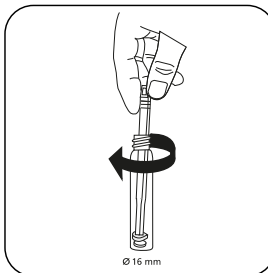

Crush tablet(s) by rotating slightly.

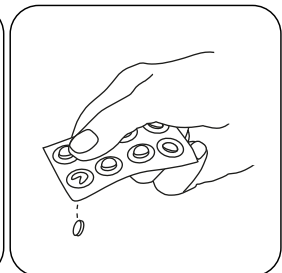

Add **ACIDIFYING GP tablet**.

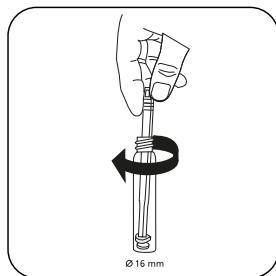
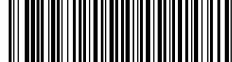

Crush tablet(s) by rotating slightly.

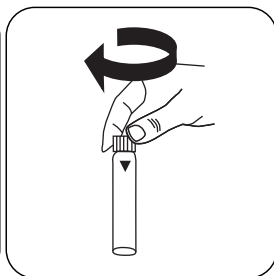

Close vial(s).

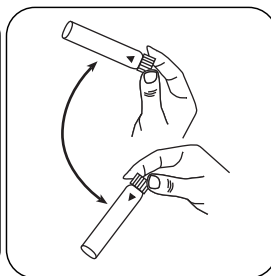

Dissolve tablet(s) by inverting.

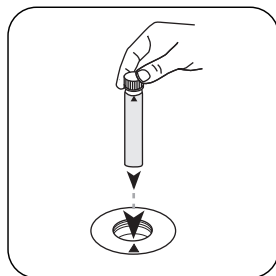

Place **sample vial** in the sample chamber. • Pay attention to the positioning.

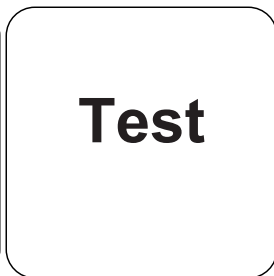

Press the **TEST** (XD: **START**) button.

The result in mg/L Chlorine appears on the display.

Chemical Method

KI / Acid

Appendix

Interferences

Persistent Interferences

- All oxidising agents in the samples react like chlorine, which leads to higher results.

Method Validation

Limit of Detection	1.29 mg/L
Limit of Quantification	3.86 mg/L
End of Measuring Range	200 mg/L
Sensitivity	83.96 mg/L / Abs
Confidence Intervall	1.14 mg/L
Standard Deviation	0.45 mg/L
Variation Coefficient	0.45 %

Derived from

EN ISO 7393-3

* including stirring rod, 10 cm

EN

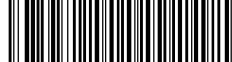

Hypochlorite T

M212

0.2 - 16 % NaOCI

Potassium Iodide

EN

Material

Required material (partly optional):

Reagents	Packaging Unit	Part Number
Acidifying GP	Tablet / 100	515480BT
Acidifying GP	Tablet / 250	515481BT
Chlorine HR (KI)	Tablet / 100	513000BT
Chlorine HR (KI)	Tablet / 250	513001BT
Chlorine HR (KI)	Tablet / 100	501210
Chlorine HR (KI)	Tablet / 250	501211
Set Chlorine HR (KI)/Acidifying GP 100 Pc. #	100 each	517721BT
Set Chlorine HR (KI)/Acidifying GP 250 Pc. #	250 each	517722BT
Dilution set sodium hypochlorite	1 pc.	414470

Notes

1. This method provides a fast and simple test. The test can be performed on site but the result will not be as precise as a laboratory method.
2. By strictly following the test procedure, an accuracy of +/- 1 weight % can be achieved.

Determination of Sodium hypochlorite with Tablet

Select the method on the device.

For this method, a ZERO measurement does not have to be carried out every time on the following devices: XD 7000, XD 7500

The sample is diluted x2000.

1. First rinse a 5 mL syringe with the solution to be examined and then fill to the 5 mL mark.
2. Empty the syringe into a 100-ml beaker.
3. Fill the measuring beaker up to the 100 mL mark with chlorine-free water.
4. Mix contents by stirring.
5. Fill a clean 5 mL syringe to the 1 mL mark with the diluted solution.
6. Empty the syringe into a clean 100 mL beaker.
7. Fill the measuring beaker up to the 100 mL mark with chlorine-free water.
8. Mix contents by stirring.

The test is performed with this solution.

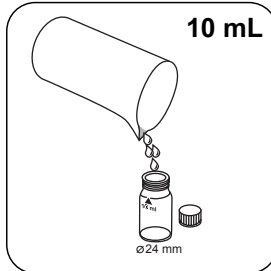

Fill 24 mm vial with **10 mL prepared sample** .

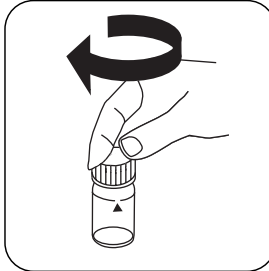

Close vial(s).

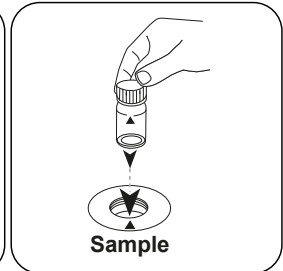

Place **sample vial** in the sample chamber. Pay attention to the positioning.

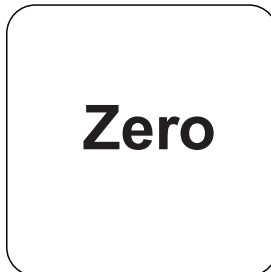

Press the **ZERO** button.

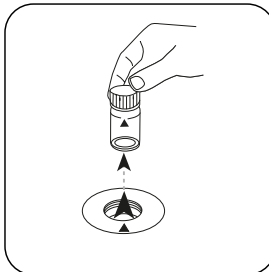

Remove the vial from the sample chamber.

For devices that require **no ZERO measurement** , **start here**.



EN

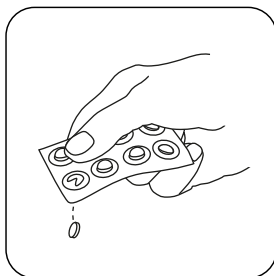

Add **CHLORINE HR (KI)** tablet.

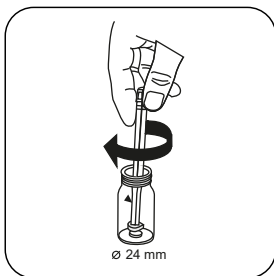

Crush tablet(s) by rotating slightly.

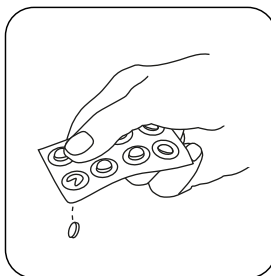

Add **ACIDIFYING GP** tablet.

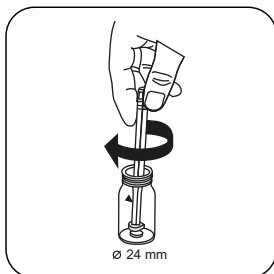

Crush tablet(s) by rotating slightly.

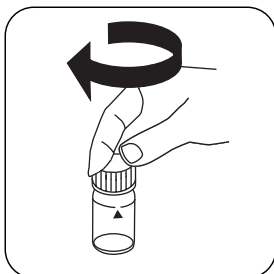

Close vial(s).

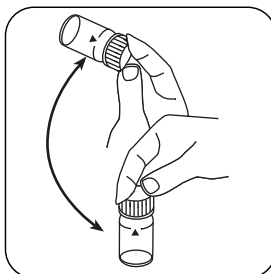

Dissolve tablet(s) by inverting.

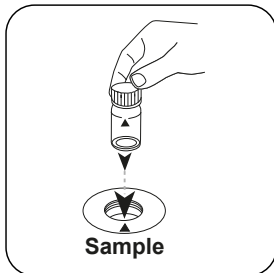

Place **sample vial** in the sample chamber. Pay attention to the positioning.

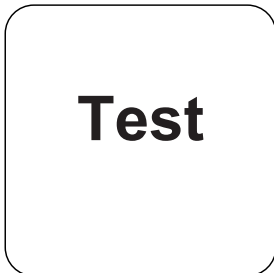

Press the **TEST (XD: START)** button.

The display will show the content of effective chlorine in % by weight (w/w %) relative to the **undiluted** sodium hypochlorite solution.



Chemical Method

Potassium Iodide

Appendix

Method Validation

Limit of Detection	0.03 %
Limit of Quantification	0.1 %
End of Measuring Range	16.8 %
Sensitivity	9.21 % / Abs
Confidence Intervall	0.12 %
Standard Deviation	0.05 %
Variation Coefficient	0.55 %

Derived from

EN ISO 7393-3

* including stirring rod, 10 cm

EN

Tintometer GmbH

Lovibond® Water Testing
Schleefstraße 8-12
44287 Dortmund
Tel.: +49 (0)231/94510-0
sales@lovibond.com
www.lovibond.com
Germany

Tintometer South East Asia

Unit B-3-12, BBT One Boulevard,
Lebuhr Nilam 2, Bandar Bukit Tinggi,
Klang, 41200, Selangor D.E
Tel.: +60 (0)3 3325 2285/6
Fax: +60 (0)3 3325 2287
lovibond.asia@tintometer.com
www.lovibond.com
Malaysia

Tintometer India Pvt. Ltd.

Door No: 7-2-C-14, 2nd, 3rd & 4th Floor
Sanathnagar Industrial Estate,
Hyderabad, 500018
Telangana
Tel: +91 (0) 40 23883300
Toll Free: 1 800 599 3891/ 3892
indiaoffice@lovibond.in
www.lovibondwater.in
India

The Tintometer Limited

Lovibond House
Sun Rise Way
Amesbury, SP4 7GR
Tel.: +44 (0)1980 664800
Fax: +44 (0)1980 625412
sales@lovibond.uk
www.lovibond.com
UK

Tintometer Brazil

Caixa Postal: 271
CEP: 13201-970
Jundiaí – SP
Tel.: +55 (11) 3230-6410
sales@lovibond.us
www.lovibond.com.br
Brazil

Tintometer Spain

Postbox: 24047
08080 Barcelona
Tel.: +34 661 606 770
sales@tintometer.es
www.lovibond.com
Spain

Tintometer China

9F, SOHO II C.
No.9 Guanghualu,
Chaoyang District,
Beijing, 100020
Customer Care China Tel.: 4009021628
Tel.: +86 10 85251111 Ext. 330
Fax: +86 10 85251001
chinaoffice@tintometer.com
www.lovibond.com
China

Tintometer Inc.

6456 Parkland Drive
Sarasota, FL 34243
Tel: 941.756.6410
Fax: 941.727.9654
sales@lovibond.us
www.lovibond.us
USA



Technical changes without notice
Printed in Germany 08/24

No.: 00386763

Lovibond® and Tintometer® are Trademarks of
the Tintometer Group of Companies

