

1 – DI 10 Quick Start Guide – Set up

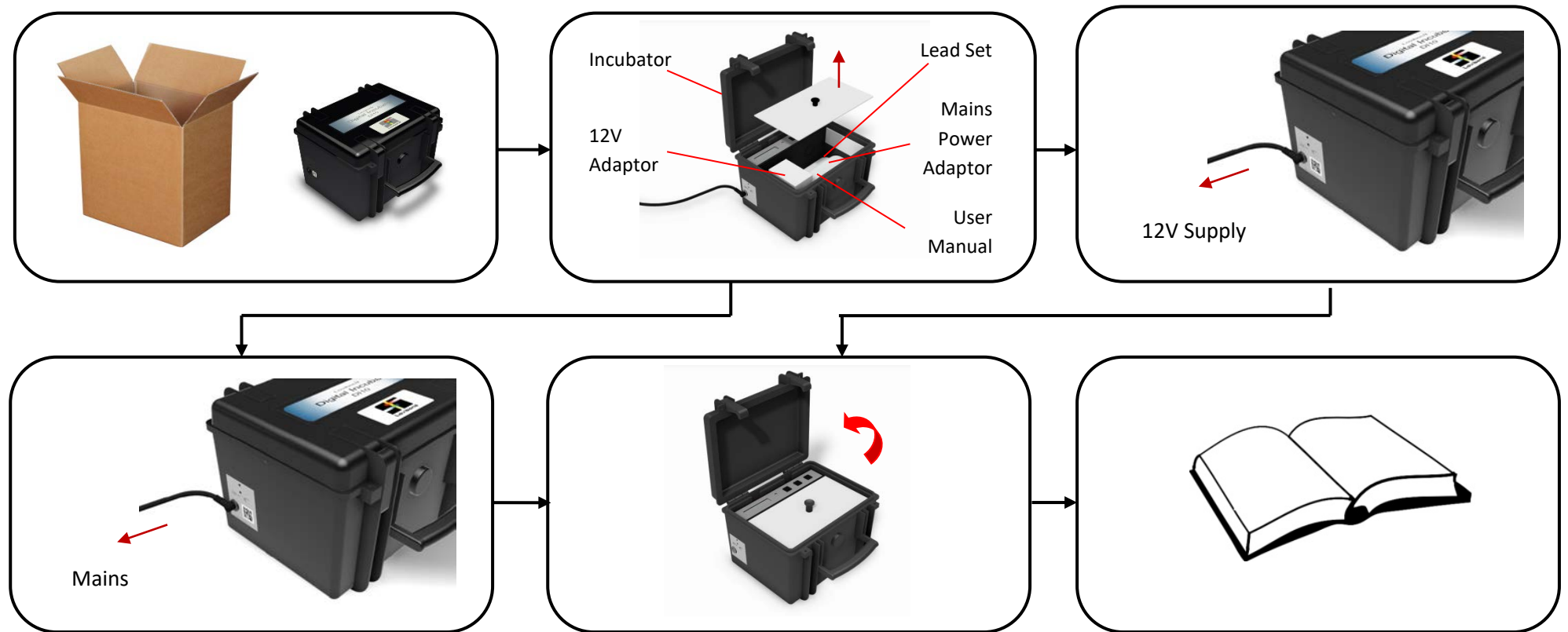

www.tintometer.com



2 – DI 10 Quick Start Guide - Incubate

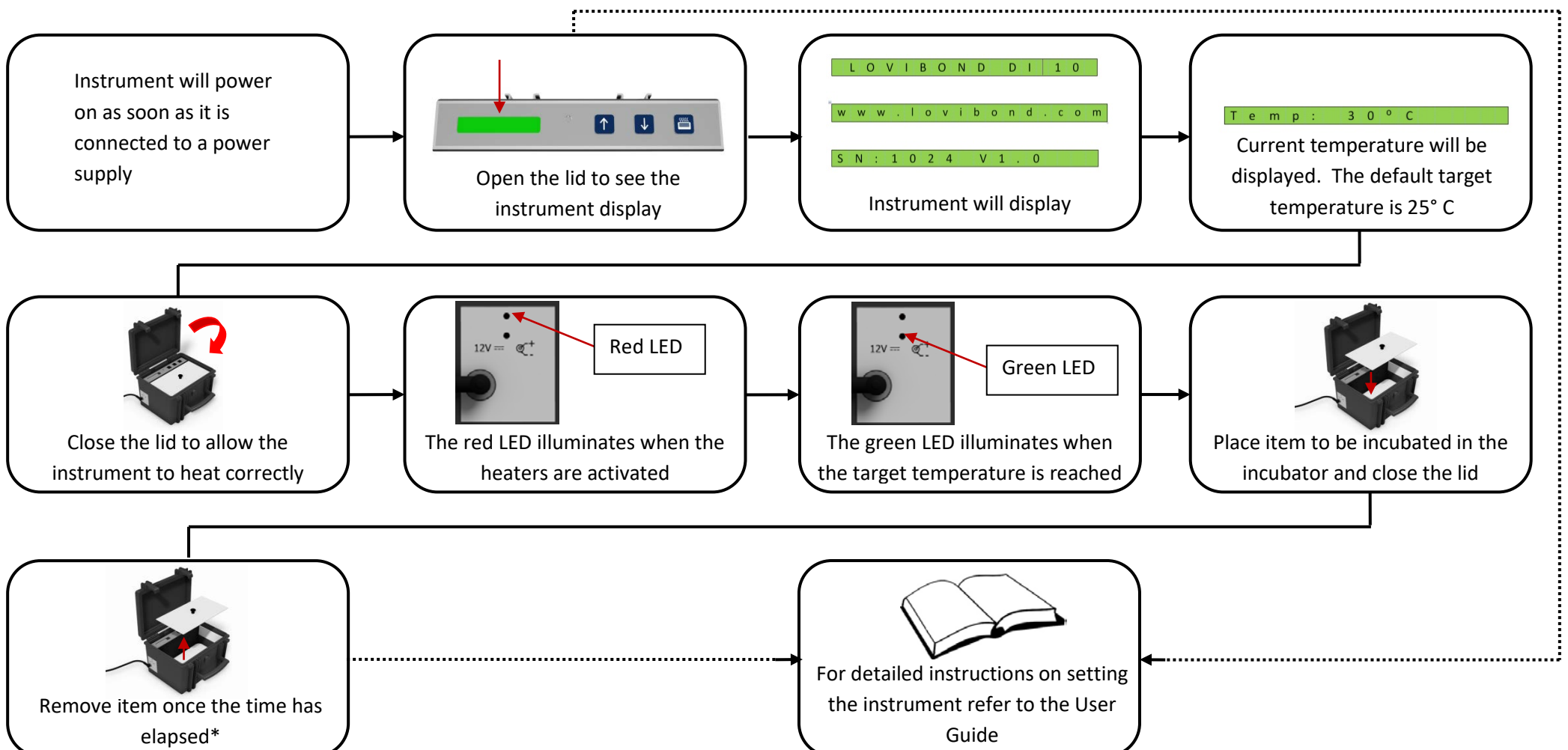

*time is dependent on item being incubated; please refer to your test procedure.

www.tintometer.com



3 – DI 10 Quick Start Guide – Kit Contents



Kit Contents	
Instrument	DI 10 Incubator
External 12V Universal Power Supply	•
Set of Leads (UK, EURO and USA)	•
In-car Power Adapter (cigarette lighter to 12v input)	•

Optional Extra	
Dipslide Holder	56B000801

- - Included in Kit

www.tintometer.com



4 – DI 10 Quick Start Guide - Information



Germany

Tintometer GmbH
 Lovibond® Water Testing
 Schleeßstraße 8-12
 44287 Dortmund, Germany
 Tel: +49 (0)231/94510-0
 Fax: +49 (0)231/94510-20
 Email: sales@tintometer.de

North America

Tintometer Inc
 6456 Parkland Drive
 Sarasota
 Florida 34243
 USA
 Tel: +1 941 758 8671
 Fax: +1 941 727 9654
 Email: sales@tintometer.us

Switzerland

Tintometer AG
 Hauptstraße 2
 5212 Hausen AG
 Switzerland
 Tel: +41 (0)56/4422829
 Fax: +41 (0)56/4424121
 Email: info@tintometer.ch

India

Tintometer India Pvt. Ltd.
 B-91, A.P.I.E. Sanath Nagar,
 Hyderabad,
 500018, India
 Tel: +91 (0) 40 4647 9911
 Toll Free: 1 800 102 3891
 Email: indiaoffice@tintometer.com

United Kingdom

The Tintometer Ltd
 Lovibond House
 Sun Rise Way
 Amesbury SP4 7GR
 Tel: +44(0)1980 664800
 Fax: +44(0) 1980 625412
 Email: sales@tintometer.com

South East Asia

Tintometer South East Asia
 Unit B-3-12-BBT One Boulevard,
 Lebuh Baku Nilam 2, Bandar Bukit Tinggi,
 Klang, 41200, Selangor D.E
 MALAYSIA.
 Tel: +60 (0) 3 3325 2285/6
 Fax: +60 (0) 3 3325 2287
 Email: lovibond.asia@tintometer.com

China

Tintometer China
 Room 1001, China Life Tower,
 16 Chaoyangmenwai Avenue
 Beijing 100020, China
 Tel: +89 10 85251111 ext.330
 Fax: +86 10 85251001
 Email: chinaoffice@tintometer.com

Brazil

Tintometer Brazil
 Ciaxa Postal: 271
 CEP: 13201-970
 Jundai - SP
 Tel: +55 (11) 3230-6410
 E-mail - Sales@tintometer.com.br



www.tintometer.com

